

THE ALLISON

wood dollhouse kit

ARTPLY

creative fun for all the family

no tools or nails needed



- Ready to go!
- Easy to follow numbered plans
- Easy to assemble and disassemble
- Five full rooms with furniture
- Assembled size 22" H x 20" W x 11" D
- All paint and stained wood

• Free illustrated instruction manual



DOLLHOUSE ASSEMBLY INSTRUCTIONS

The Dollhouse Kit contains 12 numbered die-cut wood sheets, numbered 22-33, 1 plastic window sheet, sandpaper, instructions and schematic parts diagram. Have on hand any household glue suitable for wood, masking tape and pencil; also any hardware, paint, miniature wallpaper etc. you may desire.

READ CAREFULLY THROUGH ALL INSTRUCTIONS BEFORE ASSEMBLING.

IMPORTANT: Before you begin, carefully remove each sheet from box. Referring to the PARTS DIAGRAMS, lightly mark in pencil the sheet number and letter designation on each separate piece. This simplifies identification of parts. Do not remove pieces from sheet until needed.

ASSEMBLY HINTS

1. Follow instructions in the order presented. Refer to photo on box during assembly.
2. Locate the part on wood sheet by referring to Parts Layout Diagram. Each part has been given a name and number for easy reference. Remove part carefully from wood sheet. Save any part located within. Prepare part by sanding lightly taking care to sand in direction of grain to avoid splintering. Before gluing any part check for proper fit and positioning.
3. Smooth side of wood faces outside surfaces (exterior) of house.

4. Use care in removing windows from plastic sheet so they do not tear. You may want to use scissors.

ORIENTATION: As you face the house from the front, left side is to your left. (From the rear, left side is to your right.)

NOTE: Should any parts fall out of the wood sheets before marking for identification, REFER TO TEMPLATE DIAGRAM. Match the part to the same size template drawing and mark for identification.

PAINTING: It is easier to paint or wallpaper before assembly. Paint only those parts called for in the step on which you are working. Lay parts on paper and write identification next to each part. Allow parts to dry away from heat.

A. WINDOW & DOOR TRIM

Note: You may want to paint window trim, walls and window panes before assembly.

1. a) Strip out scrap in slots and windows of Right and Left Side Walls on numbers 31A and 24A. Place face down on work table.

b) Carefully, so they do not tear, remove 2 smaller rounded windows from plastic sheet. Glue plastic onto interior (back) side of walls using a very thin line of glue outlining window cutouts.

c) Install INTERIOR frames #22F and #23D around the two windows. (Be sure parts #22E & #23E are marked for identification before removing from sheet.)

d) Turn the two walls over and gather EXTERIOR trim parts: Two frames #22C, two ledges #23E, two bottoms #26S. Install frame around each window. Next, apply glue along one edge of #23E and center under frame. Center #26S flat under ledge.

2. a) Strip out two right fronts (first and second floor) #25D & #25A. Install plastic windows on INTERIOR side.

b) Install INTERIOR and EXTERIOR trim following preceding step 1d, using four frames #26O & #22B, four ledges #25C and four bottoms #25B.

3. a) Gather interior door trims: four sides #25E, two tops #23J. First glue on side trims (on back side) even with doorways in both right front walls. Install top trims.

4. Install EXTERIOR Trim around both doorways using sides 30B, tops 23J and Decorative top #26D rests over first floor trim.

5. a) Strip out left front wall #32A. Install plastic in small half round window at top. Install interior and exterior frames #31B.

6. a) Gather two doors and two door backs #26B & #26C. Locate two plastic windows. Apply glue to back side of door and press against door back, sandwiching plastic in between. Scalloped cutout is around window opening.

b) Glue two diamonds #32C on each door as shown on photograph. Install doors later.

7. Similarly, assemble balcony French doors and door backs #32D. Glue on panel insets #32H, centered in bottom of each door. Doors may be installed later after doorway trim is installed.

8. For bow window, gather three bow frames from #32B & #26E and two seats #32I.

a) Apply glue along short edge of #32I and press against top of center frame #32B. Top of frame is flush with surface of seat.

b) Apply glue along the two slanted edges of #32I and install 2 frames #26E on either side.

c) Similarly, glue in other seat #32I inside bottom of frames.

d) Install plastic in bow window assembly, bending slightly at perforations to conform to shape.

9. a) Install Bow window unit over opening in left front wall #32A, with top and bottom seats flush with window opening. (If necessary, sand back edges of seats to bring side frames close against house.)

b) Glue ledge #32J, centered under bow window. Glue Trims #32D & #32E recessed underneath ledge.

c) Glue spacer #31G onto wall, centered over bow window with bottom edge resting on seat.

d) Install Canopy center #32H with back edge resting on top spacer, and front edge centered over center window frame.

e) Before gluing, check fit of canopy Left #32G and Right #31F. Glue these parts in place, sanding if necessary.

f) Install Interior Trim #23K & #33K around bow window as illustrated.

B. WALLS & FLOORS

1. Strip out First Floor #22A and place on table face down. Gather base strips #31C & #31D. Apply glue along one edge of #31C and install along front underside flush with edge of floor. Next install both side base strips #31D (side tabs on floor protrude beyond base strips). Install rear strip #31C. Tape corners until dry. Turn over, floor resting on base strips.

2. Apply glue along left edge of floor (with 3 tabs) and on base strip under it. Install Left Side Wall #24A, front edge even with floor.

3. Similarly, install Right Side Wall #31A. Shorter slanted edge on top faces front. Front edge even with floor.

4. Apply glue along bottom edge of right front wall, first floor #25D (the one with grooved tabs on top) and halfway up front edge of right side wall with tabs in floor slots. Tape corner until dry.

5. Apply glue along bottom edge of partition, first floor #30A and along side edge of front wall with tab (next to doorway). Install partition: align its top notch over tab on front wall. (Notched edge faces front.) Front edge even with floor.

6. Apply glue along Top (tabbed) edges of front wall and partition. Apply glue along both side edges (with tabs) of second floor #28A and install floor, first inserting 2 tabs on right side into wall.

7. Lay house on its back. Securely glue left front wall #32A to the house. Be sure it is on square, even with the bottom (base) and left side wall of house.

8. Apply glue to front edge of right side wall and bottom of right front wall, second floor #26A. Install front wall. Tape corner with side wall.

9. Install partition second floor #29A. Be sure to glue front edge (with notch) behind left front wall.

10. Install third floor #23B, inserting tabs into right side wall and partition.

C. BALCONY

1. Lay house on back. Install balcony floor #29I, centering tab in balcony door opening (slot towards front). Allow to dry at a right angle to wall.

2. Install Outside Trim #32C around exterior of doorway.

3. Install trim #33L around interior of doorway. Balcony doors may now be installed.

4. a) Glue porch railings #29C behind #29E and two pieces #29B behind two pieces #29D. Do not get glue where X railings show.

b) Before installing railings on balcony floor, check the fit and sand where necessary. Glue the railings in place.

c) Glue handrail #29G on top of balcony railings.

5. a) Lay house on back. Install canopy seat #29H over doorway (at a right angle to house) with notch centered over canopy spacer bar of door frame #32C and resting on flat top of door frame. Allow to dry.

b) Gather balcony canopy center #29N, right #29L and left #29M. Before gluing, check fit to see if sanding is needed (back edge of canopy center rests on top of spacer bar which extends from doorframe). Glue pieces on.

7. Install canopy arches #29O, and both pieces #29F, gluing parts onto front edges of canopy seat.

8. Install trims #29J & #29K to underside of balcony floor, (recessed about 1/4").

D. ROOF

Note: Refer to photo in section G of instructions.

1. Apply glue along tabbed edge of right gable roof #33A and along inner slanted edge of left front wall. Install roof, placing long tabs in partition square cutouts and aligning slot over front wall tab.

2. Locate front roof #27A. Apply glue on front slanted edges of right wall and partition. Apply glue to tabbed edges of front roof and install with tab in Gable Roof slot.

3. Install rear roof #26A on rear slanted edges of right side wall and partition. Apply glue to tabbed edges of front roof and install with tab in Gable Roof slot.

4. a) Install Left Gable Roof #23A over tabbed edge of left front wall.

b) Apply glue to both slanted edges of Roof Truss #26N. Install near rear of house in angle made by the gable roof halves. (See photo)

c) Reinforce roof by gluing roof along left side wall inside the house.

E. PORCHES

1. a) Apply glue along straight edge of side post #27L and place it behind (the wider) Front Post #27K to form a right angle. (Be sure bottoms are even.)

b) Glue post assembly onto the front (right) corners of the porch floors and base.

2. a) Glue side base #26Q between bottom of side corner post and right side wall, covering exposed part of base strip.

b) Similarly, install front base #29P along front edge of porch floor.

3. a) Strip out stiles #30C and railings #30D. Place D behind C to check spots where glue will not show. Be sure that vertical stiles fall in middle of diamond cutouts, or one part may be upside down. Glue D behind C.

b) Install this railing along edge of second floor porch, with the wider vertical stile partially behind corner post.

c) Glue handrail #30H on top of railings. (notch fits into corner post)

4. a) Similarly, glue #30F behind #30G. Install along first floor porch front, with one side behind corner post.

5. Glue two pieces #30E behind two pieces #24D. Install each railing along right side of both porches, with wider side behind corner post. Glue on two handrails #23J.

6. a) Apply glue to back side of post #32F and place against the left end (near doorway) of first floor railings. Glue #32E onto front edge of #32F, partially covering stile.

b) Install handrail #32I.

7. a) Install second floor arch #27M under front roof. Tab fits into notch in wall; right side falls behind corner post.

b) Similarly, install first floor arch #30H under edge of second floor.

c) Install both side arches #27D & #27E over first and second floor porch sides.

d) Apply glue along front edge of the overhanging second floor and install trim #30H along first floor arch. Similarly, install trim #32G along side arch. (See photo)

F. TRIM

1. Install window shutters #26P & #22D on house.
2. Gather 8 chimney parts #26F, G, H, I, J, K, L. Apply glue to long edge of #26F and #26G. Place behind each long side of #26I. Apply glue to shorter edges of #26F and #26G and install #26J, with top edges even (wood grain to run vertically). Glue top #26L on chimney. Glue on trim #26H and 26K around chimney sides, near the top. Install chimney in gable roof slots.
3. a) Install gingerbread trim #27H under right gable roof, #27I under left gable (recessed about 1/2" from front).
b) Install gingerbread trims #27F and #27G over right side wall, under overhanging roof.
4. a) Run a line of glue along the top where the two gable roofs meet. Install the short roof trim #32L. Similarly, install the long roof trim #32L.
b) Glue finials #32F and #32H to front and rear of gable roof, at either end of roof trim. Similarly, install finial #31E over right side of house.

G. STAIRCASE

1. Gather Staircase parts: Bottom riser #27C, eight risers #27B, eight treads #26M and #27J, stair sides #28C, stair back #26R. Distinguish top from bottom of stair sides: when bottom is held on floor, stairside will reach ceiling.
2. Apply glue along front edges of stair sides where bottom riser will be located. Position riser #27C at bottom, over glued edges, not between sides. Next, apply glue to back edge of stair sides behind location for top riser. Install stair back #26R here.

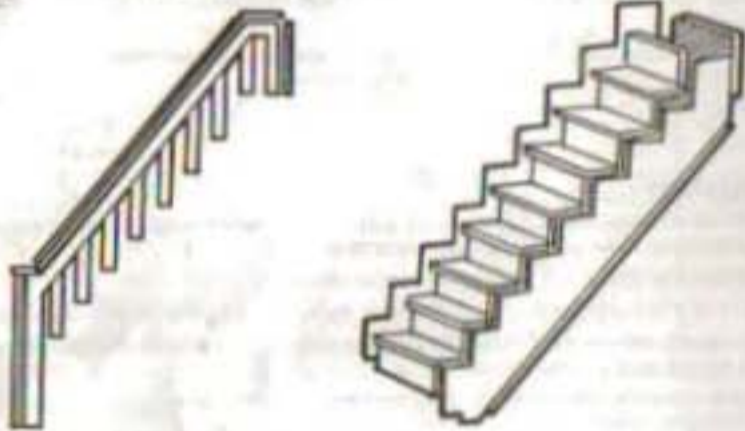

3. Complete staircase from bottom up, installing at bottom tread #26M or #27J, then riser #27B, then tread and so on. Bottom edge of riser rests on top of each tread below it. Be sure that as you face the staircase, treads overhang to your right and are flush with left side. Otherwise staircase will not fit flush against wall.
4. Install staircase against partition wall, with staircase back even with back edge of second floor.
5. Glue handrail #23F onto banister #23C centered over top post. Install long handrail #23B on banister (rounded end towards bottom). Apply glue to front edge of top banister post and install #23G under #23F. Install banister with top post on second floor.
6. Install railing #24C along stairwell opening, edge against partition wall. Apply glue to side edge of #24C and install railing #24B. Glue one post #24C to front edge of railing #24B. Glue handrails #24E and #24F on top of railings.

This kit has been carefully inspected before packaging. As with any natural wood product there may occur variations in color, grain properties, etc. If, however, any parts are found to be damaged or missing, we will gladly send to the original purchaser replacement parts upon receipt of written notification within 30 days of purchase. Notification must include your name, address, proof of purchase (customer receipt) and description of part(s) to be replaced.

507 Wortman Avenue
Brooklyn, N.Y. 11208

PARTS DESCRIPTIONS I-77

SHEET NUMBER & LETTER DESIGNATION



Sheet #22

- A first floor
- B large window frame
- C small window frame, exterior
- D window shutter
- E window shutter
- F window frame, interior

Sheet #23

- A left gable roof
- B third floor
- C banister
- D window frame
- E window trim bottom
- F handrail
- G banister post
- H handrail
- I door top ledges, exterior
- J door top trim, interior and exterior
- K bow window trim

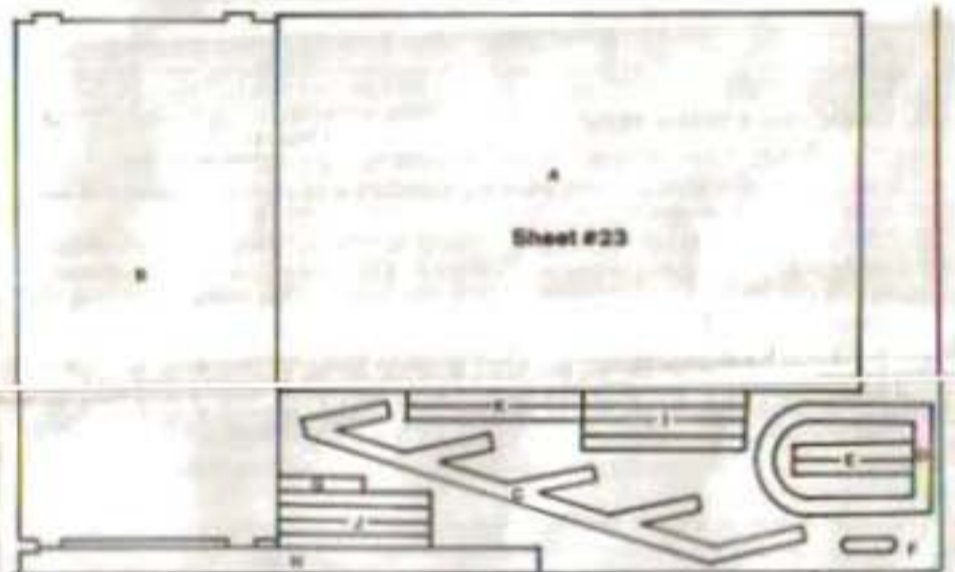

CONTINUED NEXT PAGE....

TEMPLATE

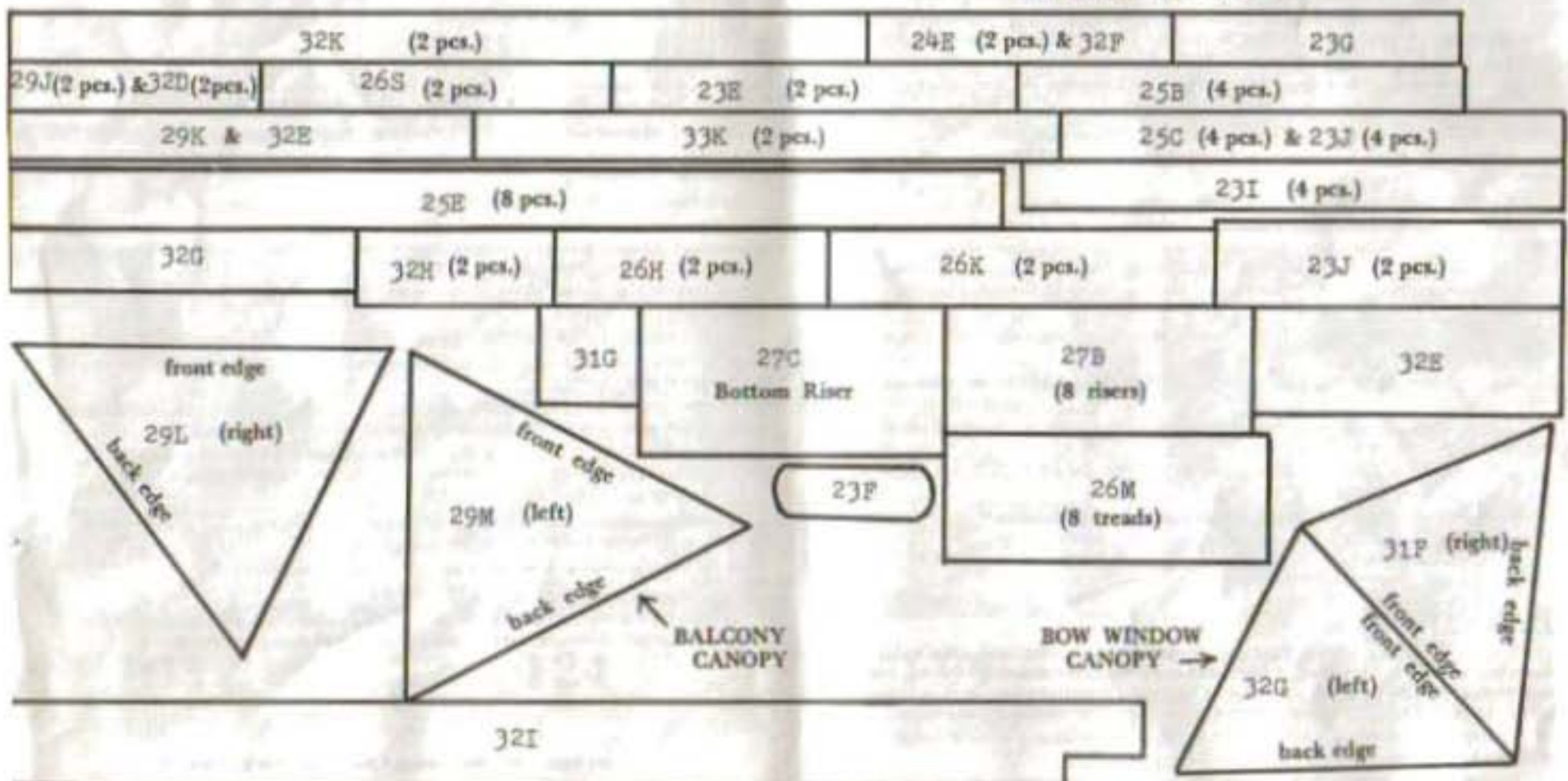

PARTS DESCRIPTIONS

Sheet #24

- A left side wall
- B stairwell railing
- C stairwell railing
- D porch railing
- E railing post

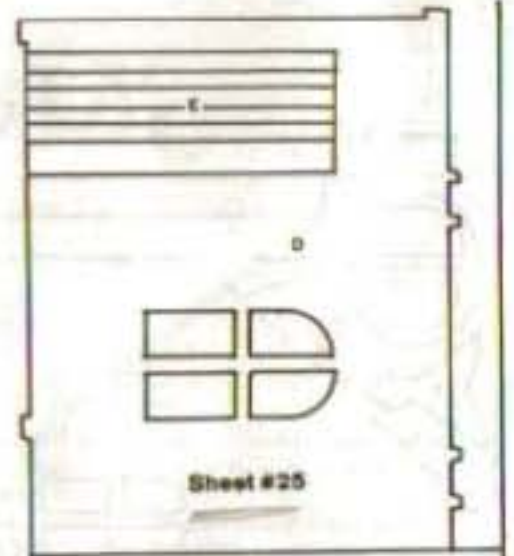

Sheet #25

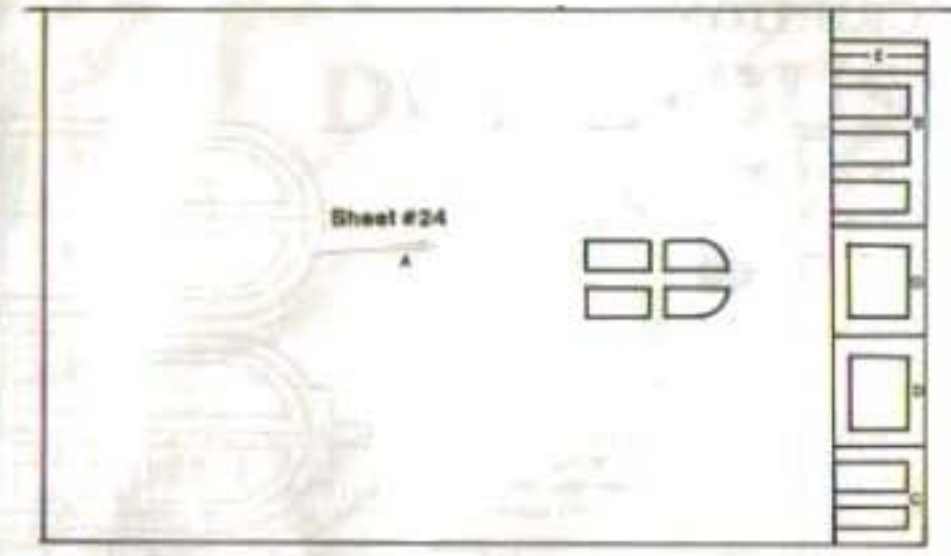

Sheet #24

Sheet #26

- A rear roof
- B door back
- C door front
- D decorative door top
- E bow window side frames
- F chimney side
- G chimney side
- H chimney trim
- I chimney side
- J chimney side
- K chimney trim
- L chimney top
- M staircase tread
- N roof truss
- O large window frame
- P window shutter
- Q side base
- R stair back
- S window bottom

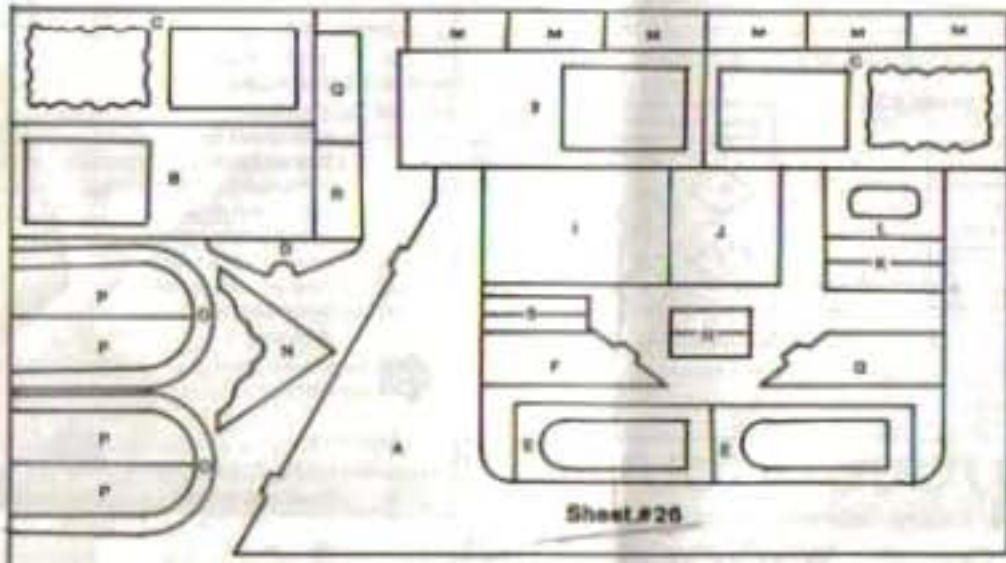

Sheet #26

Sheet #25

- A right front wall, second floor
- B large window bottoms, interior and exterior
- C large window ledges, interior and exterior
- D right front wall, first floor
- E door side trims

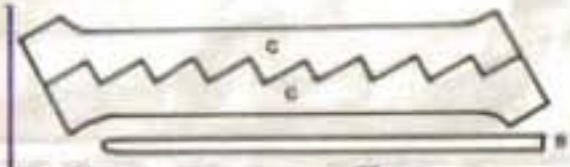

Sheet #27

- A front roof
- B staircase risers
- C staircase bottom riser
- D side arch, second floor
- E side arch
- F gingerbread trim, right wall
- G gingerbread trim, gable
- H gingerbread trim, gable
- I staircase tread
- J front post
- K side post
- L side post
- M second floor arch

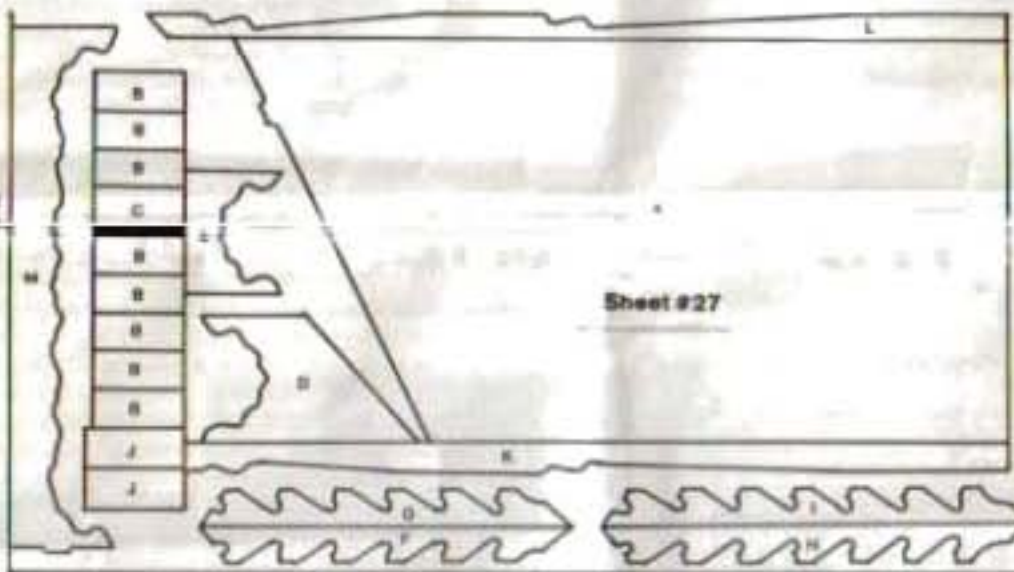

Sheet #27

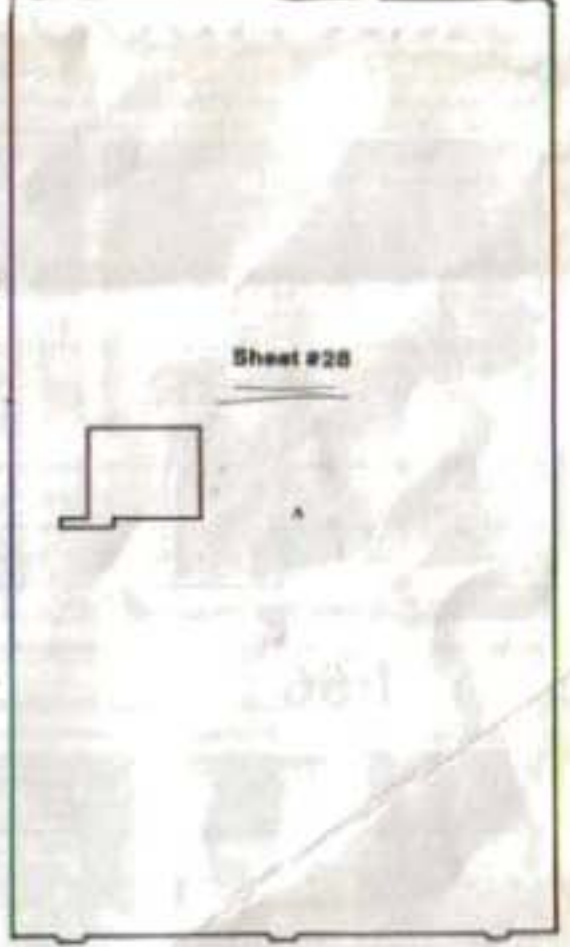

Sheet #28

Sheet #28

- A second floor
- B handrail
- C staircase sides

Sheet #29

- A partition, second floor
- B porch railing
- C porch railing
- D porch railing
- E porch railing
- F balcony canopy arches
- G balcony handrail
- H balcony canopy seat
- I balcony floor
- J trim under balcony
- K trim under balcony
- L balcony canopy
- M balcony canopy
- N balcony canopy
- O balcony canopy arch
- P front base

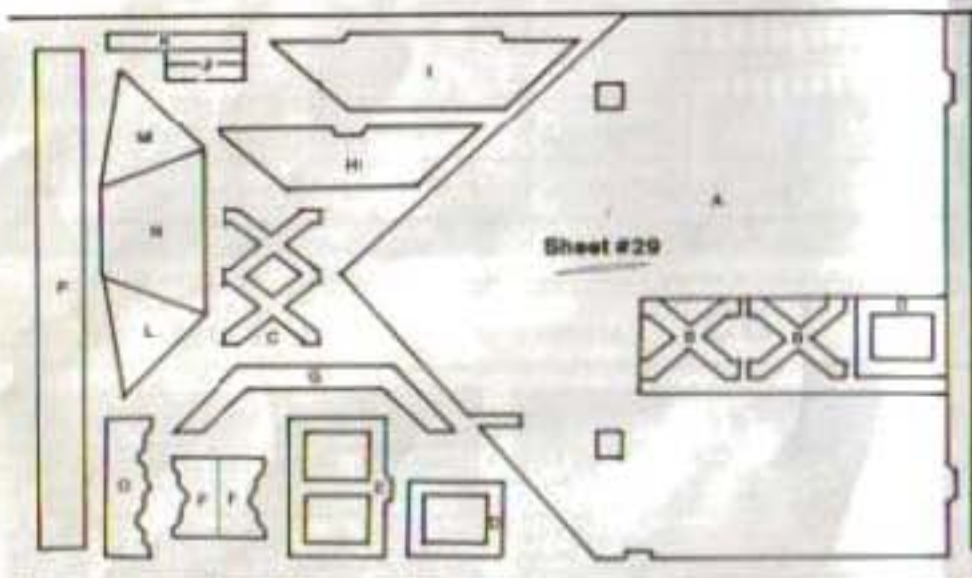

Sheet #29

Sheet #30

- A partition, first floor
- B door side trims
- C porch railings
- D porch railings
- E porch railings
- F porch railings
- G porch railings
- H first floor arch

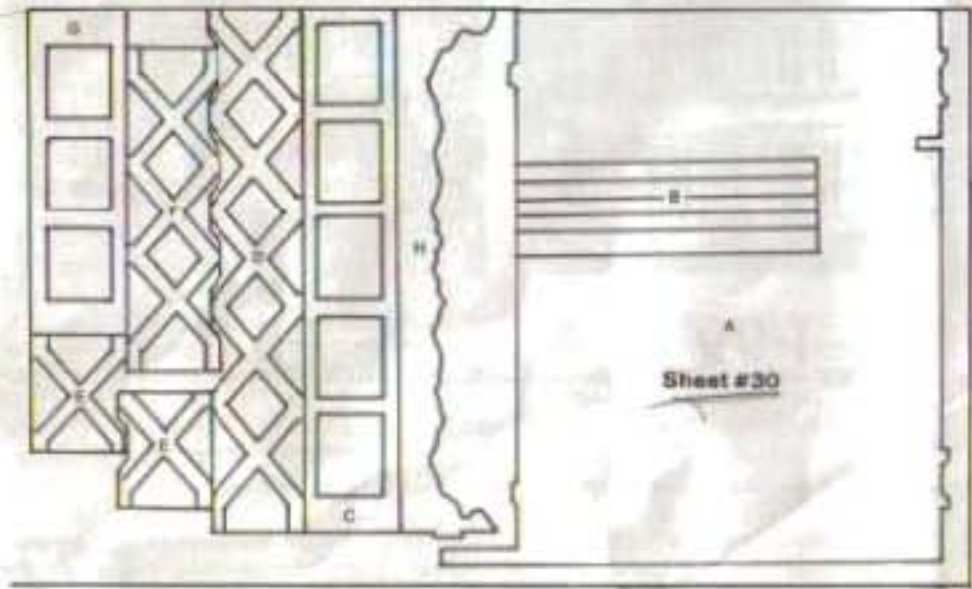

Sheet #30



PARTS DESCRIPTIONS



Sheet #31

- A right side wall
- B half round window frames
- C base strips
- D base strips
- E finial, right side
- F bow canopy, right
- G bow canopy spacer



Sheet #32

- A left front wall
- B bow frame
- C door trim
- D trim under bow window
- E trim under bow window
- F finial, gable roof
- G bow canopy, left
- H bow canopy, center
- I bow window seats
- J bow window ledge
- K handrail post
- L roof trim

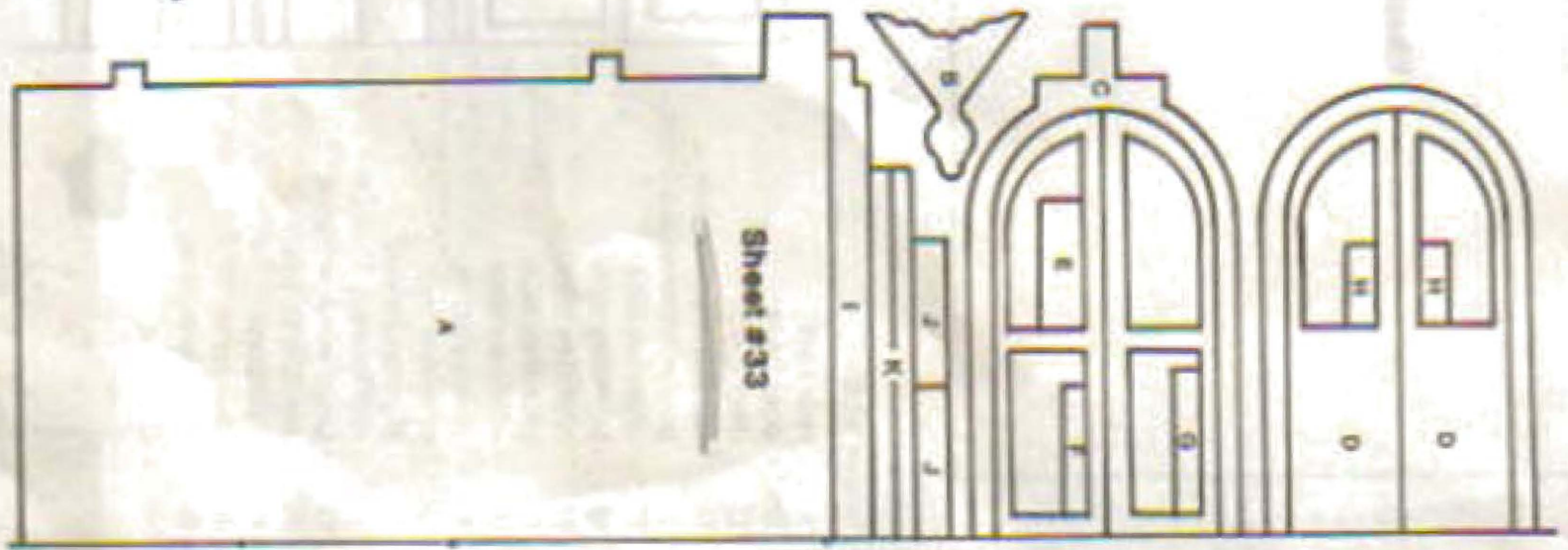

Sheet #33

- A right gable roof
- B finial, gable roof
- C exterior balcony door frame
- D door backs
- E porch railing post
- F porch railing post
- G house trim
- H balcony door decoration
- I porch handrail
- J porch handrail
- K bow window interior trim
- L interior balcony door frame

Glue • Paint • Shingles • Siding • Hardware • Not Included