

Thank you for your purchase of a Batrie Extension. Your Extension has been precision made in Vermont with meticulous care by our craftpeople using only the finest quality materials.

This extension will last for years, even generations, if proper care and attention is given during assembly. Take your time during assembly and be sure to read the instructions completely before you proceed.

This extension will fit on the left side of the DH-71K dollhouse with only slight customizing of the Nosing. Any other placement of the extension will require more extensive customizing.

Check all parts and packs against the parts list before beginning construction to identify the parts and to make sure you have everything. If you need replacement parts be sure to *include the exact name and measurements taken directly from the parts list.*

**Assembly Notes:** A large, clutter-free, well lighted work area is most helpful during assembly, and a flat work surface is essential.

#### Supplies:

White glue	Masking tape
Pencil	'Light' Spackle or Wood Putty
Utility knife	Sandpaper: 100 grit and 320 grit

Read the instructions carefully, look at each of the illustrations. With the parts in your hands, think the assembly through before you proceed.

Arrange pieces in groups ready for assembly. Follow the instructions and assemble enough in a dry run to be sure you know ahead of time when and how each part fits. Always be sure of the parts orientation before gluing.

Check all the joints to be sure everything is tight or straight. If more tape or a helper is needed, it's good to know that before the parts have glue on them.

**Make sure everything is straight and flat as the glue dries... That's the shape that will be permanent.** Make all joints flush. Keep surfaces and edges square.

**Painting:** Many parts are easiest to paint before assembly. Use high quality semi-gloss latex enamel, sanding between coats with 320 grit silicone carbide sandpaper. Avoid old gloppy paint and poor quality paint brushes. Do not paint surfaces to be glued.

After assembly but before any outside details are attached, repair any defects, fill the nail holes, sand carefully with 320 grit silicone carbide sandpaper one clapboard course at a time, then re-paint. Sometimes a 3rd coat is necessary.

When nailing, always check the inside of the joint for a crooked nail before the nail is driven all the way in.... then you can grab it with pliers if it's necessary to pull it out.

Drive the last bit of the nail in with a hammer and nail set or awl to leave the nail head a little below the surface. Then sand the surface without wrecking the clapboard shape, and fill the nail hole with 'light' spackle or wood putty. Sand again when the fill is dry, and paint when you paint the wall.

Do not nail the floors to the walls ... use only glue, tape, and weight.

#### Parts list:

##### (1) Instructions

- (1) Base Floor (1/4) 11<sup>7</sup>/<sub>8</sub> x 11<sup>7</sup>/<sub>8</sub>
- (2) Upper Floor/Ceiling (3/8) 11<sup>7</sup>/<sub>8</sub> x 11<sup>7</sup>/<sub>8</sub>
- (2) Liner (1/8) 10 x 10<sup>11</sup>/<sub>16</sub>
- (1) Foundation: (3/8) 11<sup>9</sup>/<sub>16</sub> x 1<sup>15</sup>/<sub>16</sub>
- (1) Foundation: (3/8) 10<sup>7</sup>/<sub>8</sub> x 1<sup>15</sup>/<sub>16</sub>
- (1) Foundation: (3/8) 8<sup>11</sup>/<sub>16</sub> @ 22<sup>1</sup>/<sub>2</sub>°
- (1) Foundation: (3/8) 8<sup>7</sup>/<sub>16</sub> @ 22<sup>1</sup>/<sub>2</sub>°
- (1) Foundation: (3/8) 4<sup>9</sup>/<sub>16</sub> @ 22<sup>1</sup>/<sub>2</sub>° ^ 22<sup>1</sup>/<sub>2</sub>°

##### Milled Clapboard Walls:

- (2) 8<sup>3</sup>/<sub>16</sub> x 10, window
- (2) 7<sup>15</sup>/<sub>16</sub> x 10
- (2) 3<sup>7</sup>/<sub>8</sub> x 10, window

##### Connectors 10":

- (4) 135°
- (4) End Cap

##### Railing Pack:

- (6) Flutepost 1<sup>5</sup>/<sub>8</sub>
- (6) Post Cap 1<sup>1</sup>/<sub>16</sub> x 1<sup>1</sup>/<sub>16</sub>
- (28) 1/8 Dowels: 1
- (8) 3<sup>1</sup>/<sub>2</sub> Rail
- (2) 4<sup>9</sup>/<sub>16</sub> Rail, mitered 45° ^ 45°

##### 3/8 Nosing:

- (3) 8<sup>3</sup>/<sub>4</sub> Mitered 90°L, 22<sup>1</sup>/<sub>2</sub>°R (8<sup>9</sup>/<sub>16</sub> Edge)
- (3) 8<sup>3</sup>/<sub>4</sub> Mitered 22<sup>1</sup>/<sub>2</sub>°L, 90°R (8<sup>9</sup>/<sub>16</sub> Edge)
- (3) 5 Mitered 22<sup>1</sup>/<sub>2</sub>°L, 22<sup>1</sup>/<sub>2</sub>°R (4<sup>23</sup>/<sub>32</sub> Edge)

##### (2) Packs of Two W12-K Windows, Each Pack Contains:

- (4) Stiles 5
- (4) Sills 2
- (2) Plexi 4<sup>5</sup>/<sub>8</sub> x 2<sup>1</sup>/<sub>8</sub>
- (2) Stool Cap 3<sup>1</sup>/<sub>4</sub>
- (2) Pediment 3<sup>1</sup>/<sub>4</sub>

**Window Assembly (Standard W12K):**

1. Test assemble (no glue) one window set (see the parts list) before you do anything else; identify the parts, see how they fit, and see where the glue goes. Now is the time to clean and paint the window parts (before you glue anything together), but do not sand or paint the gluing surfaces (Illustration #1).

Practice holding the frame pieces face-down on the work surface and putting on the rubber-band. When you can do it every time without pieces flying, then you are ready for glue (Illustration #2).

2. Glue and rubber band together the Stiles and Sills with the Window Plexi in place. Make sure the assembly is square, and that the Sills are flush with the Stiles across the face and at the top and bottom as the glue dries.

3. Glue and rubber band the Pediment and Stool Cap to the window frame. The back edge of the Pediment and Stool Cap line up with the lip of the Stiles (Illustration #3).

4. Touch-up the sanding and paint, but stay away from the Window Plexi!

5. Check the fit of the windows in the wall openings. Make sure the window sits straight. Trim the corners of the openings square if necessary for a good fit (Illustration #4).

Glue the windows in place only after the extension body is complete and painted.

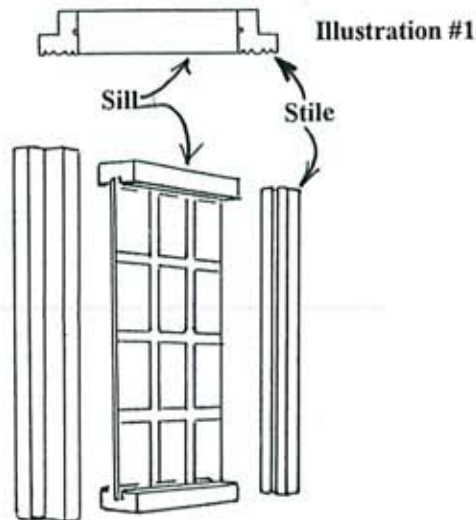

Illustration #1



Illustration #2

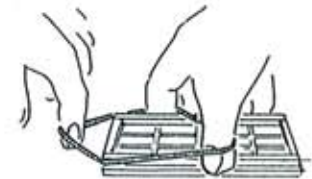

Illustration #3

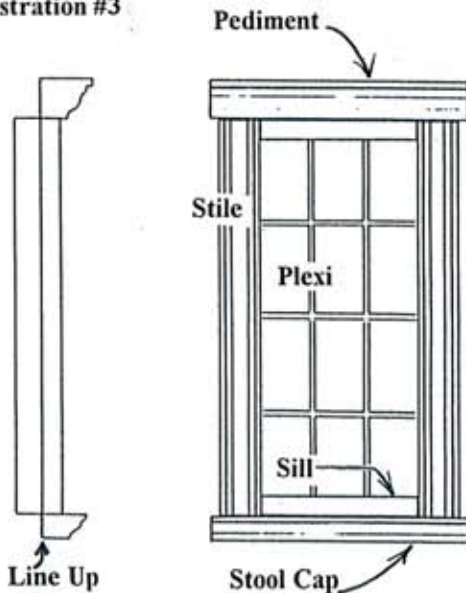
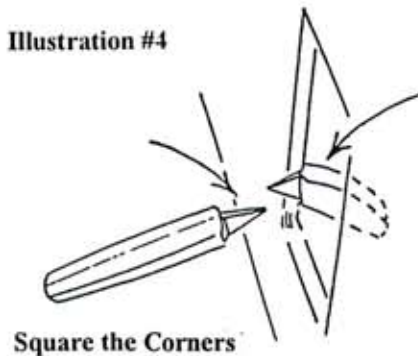
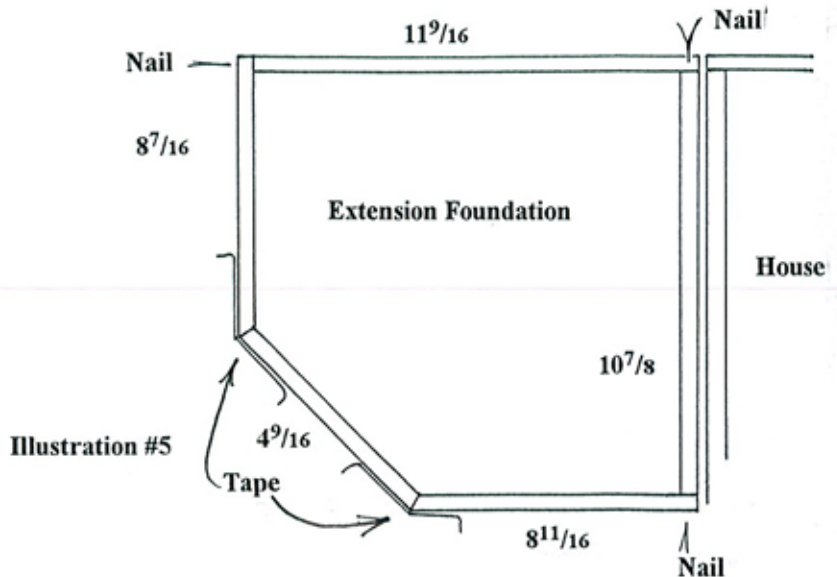

Illustration #4



**Assemble the Foundation and Base Floor:**

- 1. Glue and nail together the foundation pieces that join at 90°. Pay careful attention to which piece gets nailed through first at each corner (Illustration #5).
- 2. Glue and tape the 45° foundation in place.
- 3. Remove the house Nosing where the extension floors will attach to the house floors. Clean off the old glue to ensure a good joint between the floors.
- 4. Glue and tape the extension foundation to the house foundation flush at the back edge.
- 5. Glue, tape, and nail the Base Floor to the foundation and house Base Floor, spaced evenly all around and lined up at the back edge.



Weight the base and foundation set to lay **absolutely flat** on a flat worksurface as the glue dries. *Getting the Base assembly flat is necessary for a flat extension!*

End Cap

**Extension Body Assembly:**

Illustration #6

- 1. Set the Liner in place against the house wall.
- 2. Without glue, tape together the Walls and Connectors on the Base Floor (be sure the inside edges of the 135° Connector corners are in line with the Floor panel). Adjust the wall layout until all the panels are straight up and down, and parallel with the edges of the floor (the back End Cap lines up with the back of the floor, the Walls are spaced evenly at the sides and front, and the side End Cap is tight to the house wall and touching the Liner) (Illustration #6).
- 3. Trace the outside of the wall layout on the floor. Now is a good time to paint the space outside of the tracing.
- 4. Replace the wall layout, this time permanently gluing the Walls and Connectors in place.
- 5. Without glue, tape the Ceiling panel on top of the walls. Trace the outside of the wall layout on the underside. Paint the space outside of the tracing. Replace the Ceiling, this time gluing and nailing to the walls and house floor (tight, lined up, and leaving an even over-hang).
- 6. Repeat steps 1-5 for attaching the 2nd floor walls and Ceiling.

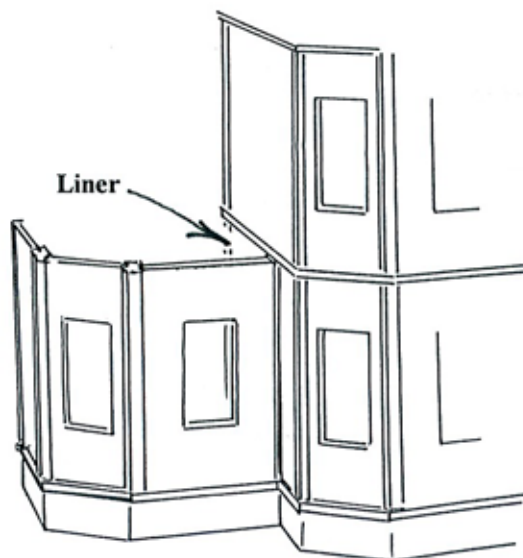
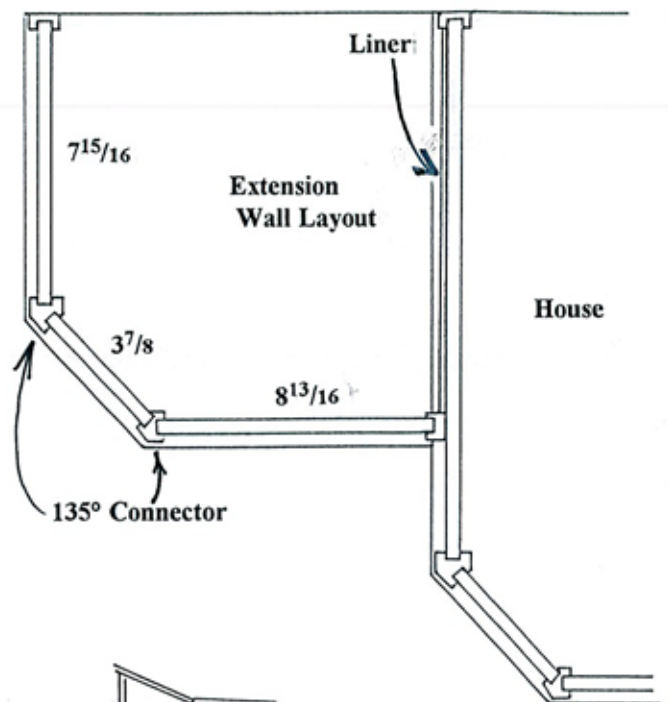

**Attach Nosing:**

The Nosing is designed to cover the end grain of the plywood floors and to overhang down below the floors, with the top of the Nosing flush with the floor.

Because this extension is designed to be used in a variety of ways, you must customize the Nosing where it joins the house Nosing. Use a X-Acto® miter box or a molding cutter for a perfect 45° cut at the corner.

Attach the Nosing to the edges of the floors, beginning with the re-fitted corner, and working toward the back (Illustration #7).

Illustration #7

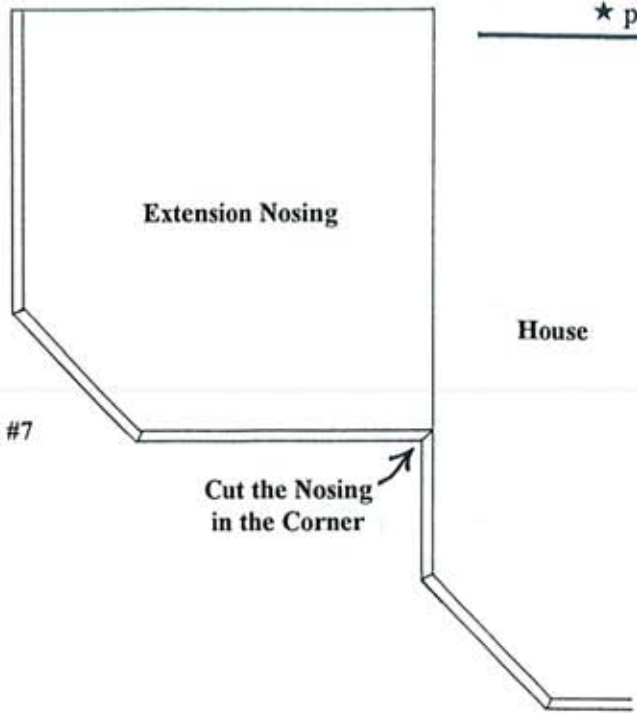

**Post and Railing Assembly:**

- 1. Paint and sand the Rails and Dowels before assembly. Wipe any paint out of the grooves, and do not paint the Rail ends at all.
- 2. Match Rails into assembly pairs. Use the marking guide to mark the Dowel locations at 5/8" spacing (Illustration #8):

# of Sets	Length	Dowels
4	3 1/2"	5
1	4 9/16" Miter	6

Illustration #8

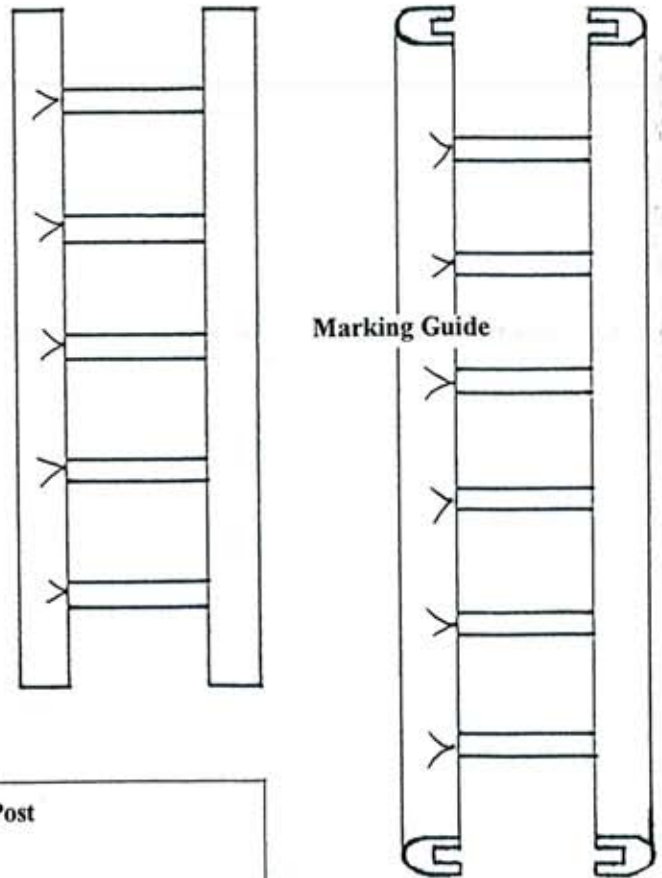

- 3. Put a dab of glue in the groove by each mark for one Rail only of each assembly pair. Push a Dowel into the groove at each mark. Be sure all the Dowels are even, straight, and square.

Let the glue dry.

- 4. Repeat step #3 for the second Rail of the assembly pair squeezing the Dowels in one at a time at the marks. Hold the Railing set in a square or lined up with the square edge of a piece of paper to make the Rail ends exactly line up. Final adjust the Dowels - straight and square.
- 5. Glue the Postcaps onto the Fluteposts.

Set up the railings and posts spaced evenly from the edge of the ceiling. Mark the location of the posts, then glue everything in place (Illustration #9).

**Finish the Outside**

- 1. Touch up the paint
- 2. Install the windows.

Illustration #9

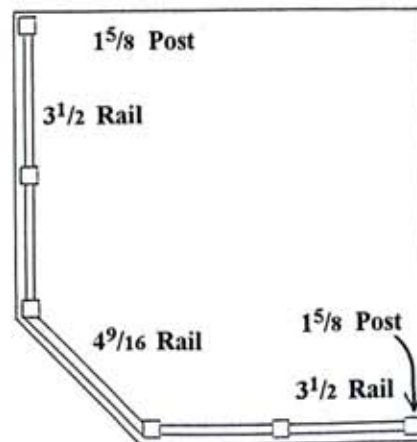

The Extension Kit part of your project is done.  
Enjoy the Rest!