

TIFFANY DOLLHOUSE ECONO-KIT

by

WALMER DOLLHOUSES

2100 Jefferson Davis Hwy.

Alexandria, Va. 22301

(703) 548-8804

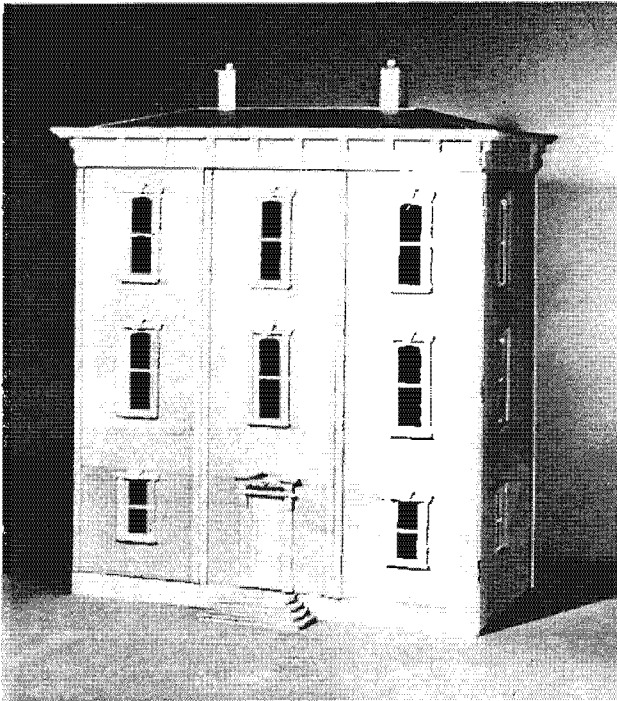

← This photograph shows the front view of the completed Tiffany Dollhouse Kit.

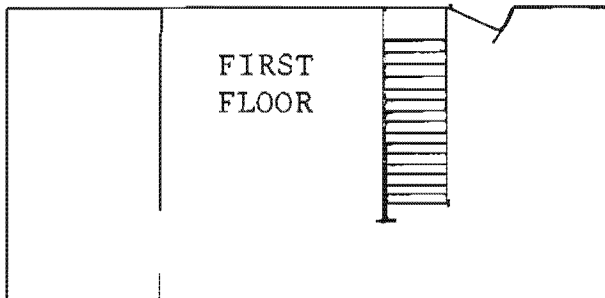
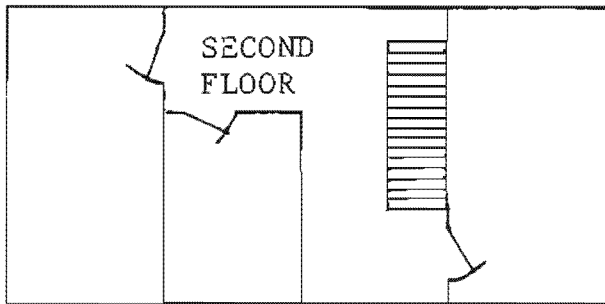
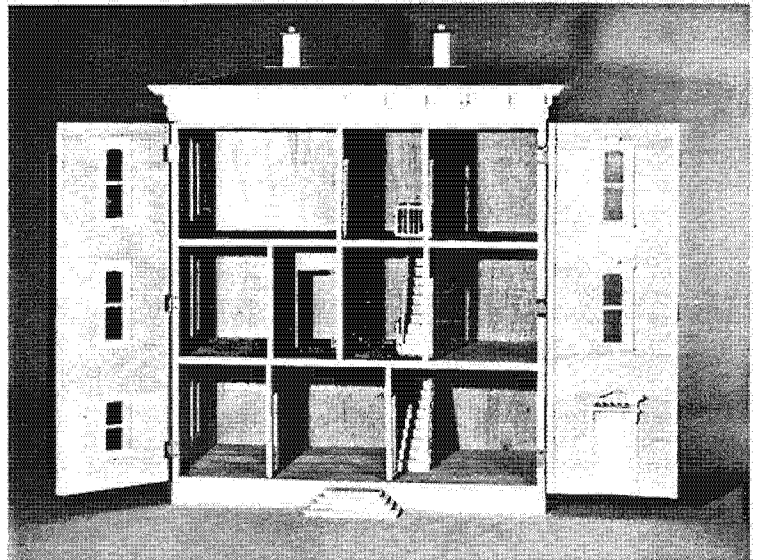

← LEFT RIGHT →

All references in these instructions to left and right will be as viewed from the front of the dollhouse.

First and Second Floor Plans are furnished for clarity in the positioning of partitions in Step 18.

Auxiliary Parts - Tiffany House #503
(not to scale)

Heavy L-Strip
31 5/16"
2 pcs.

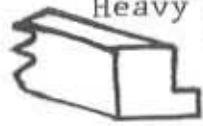

Light L-Strip
31 5/16"
4 pcs.
33 3/16"
2 pcs.



Top Horizontal Frame
3 pcs.

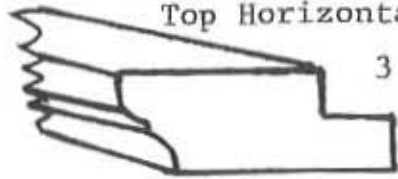

Outside Corner Molding
2 pcs.

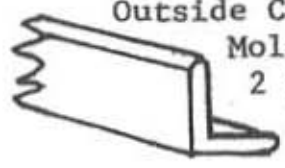

Facing Channels
10"
7 pcs.
3/8"



Facing Strips
31 3/16"
2 pcs.
1/2"

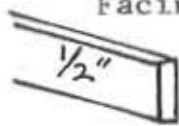

Chimneys,
Caps, &
Stacks
2 pcs.



Underframe
3/4 x 1 7/8"
2 pcs. 31 3/16"
3 pcs. 14 7/16"
#1

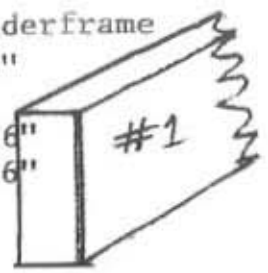

Door Latches
2 pcs.



Splice Strip for
back - 33 1/2"
1 pc.
1/8"
3/8" PLY

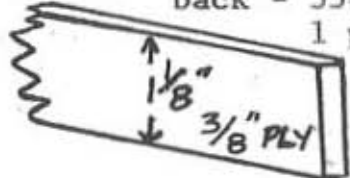

Lower Sill
32 5/16"
1 pc.

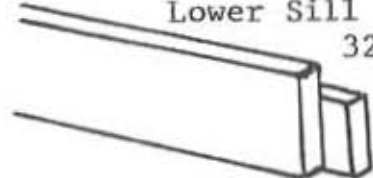

Plus: (for Kit/Complete only)

- 1 Prehung Door
- 14 Interior Windows
- 14 Exterior Window Trim
- 1 Staircase with rail
- 1 Staircase w/o rail
- 1 Upstairs rail
- Nails and screws
- 9 Hinges

Top Vertical Frame
#2
#3
#4
1 pc. 2 pcs. 1 pc.

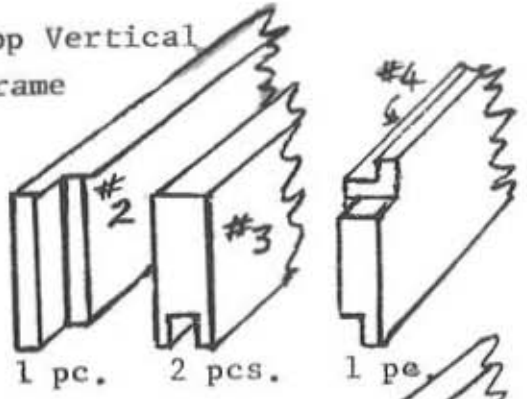

#5
1 pc.

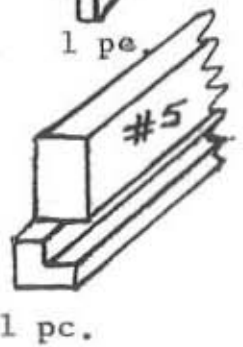

Eave Brackets
22 pcs.



Rooftop Support
3/8" PLY
1/4" PLY
8"

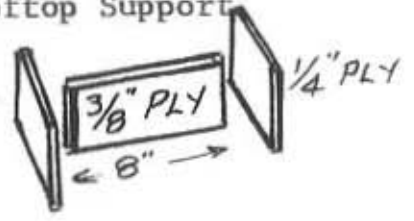

Front Steps

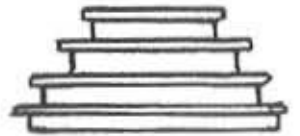

MAJOR PARTS: TIFFANY DOLLHOUSE ECONO-KIT

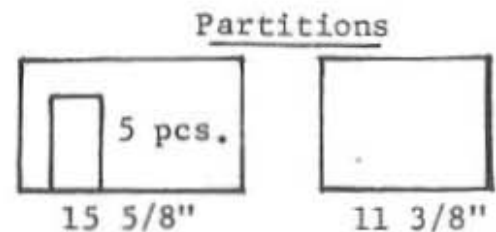
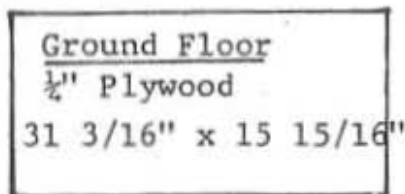
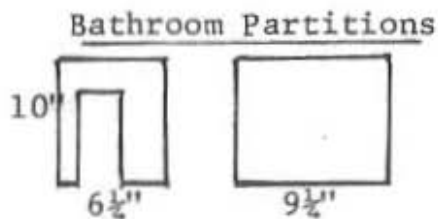
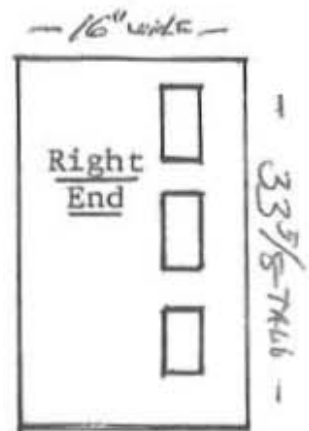
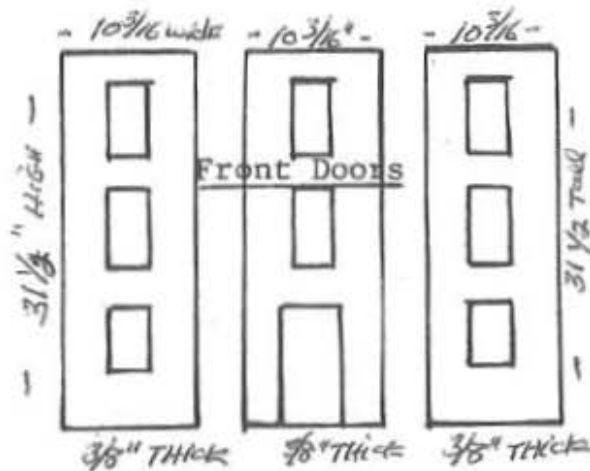
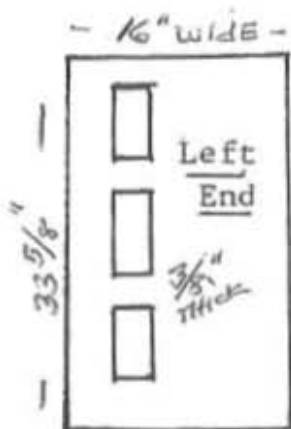
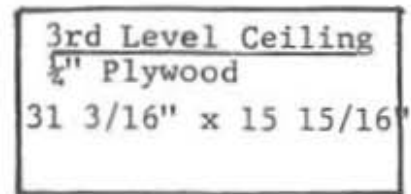
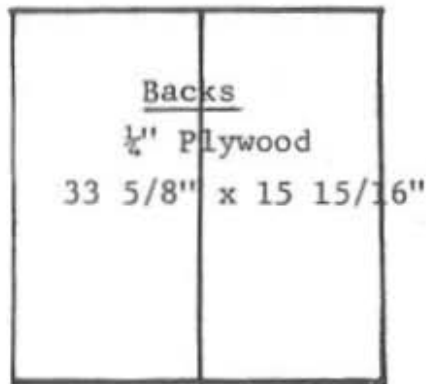
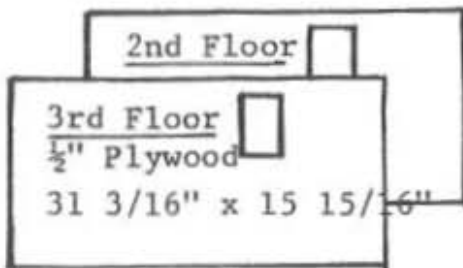
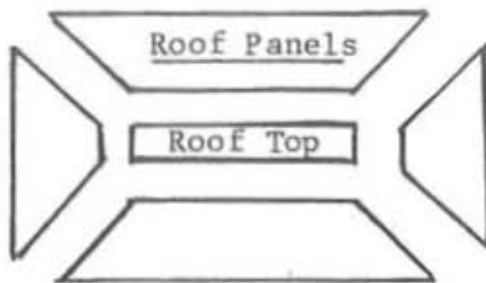

SEQUENTIAL ASSEMBLY INSTRUCTIONS

for the

TIFFANY DOLLHOUSE ECONO-KIT

WHERE TO DO IT - It is very important to use a level and flat surface to assure accurate alignment and level positioning of all mating parts.

1. SANDPAPERING

Extensive sand papering is not required since almost all edges of the plywood are covered with molding, corners, or facings. Sandpaper only to the extent necessary to remove frayed wood that would inhibit good fits of the parts during assembly.

NOTE: The better side of the plywood (the smoother and tighter grained side) should be selected to become the sides which are painted and/or exposed.

2. INSTALLATION OF UNDERFRAME ONTO THE GROUND FLOOR

Select the better side of the plywood - the smoother and closer grained side - place it down. Then glue the parts of the underframe to each other and to the ground floor flush to the outer edges of the plywood. Nail the joints of the underframe together and allow the glue to set.

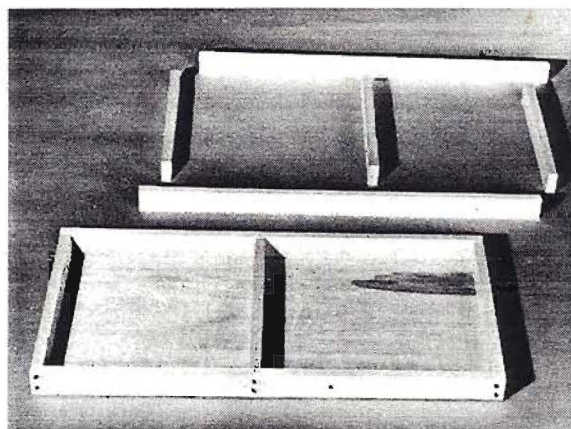

3. ASSEMBLY OF THE TOP VERTICAL FRAME

The top vertical frame will eventually fit onto the top edge of the ends and back of the house - and over the front doors. For positive identification, the elements of the top vertical frame are marked #2, #3, #4 and #5.

NOTICE: It is very important that this frame is assembled accurately - and square.

For assistance in proper positioning, the marked numbers should be facing inside the frame.

a. Glue and nail the joints of #3 and #4 as shown. Grooves are all down and flush at the bottom surface.

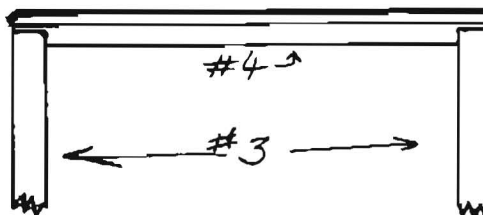

3. (Continued)

b. Glue and nail the joints of #2 and #3 as shown (both edges will be flush). To assure the frame remaining square while glue joints set, tape a square tightly into one corner as shown. Allow glue to set.

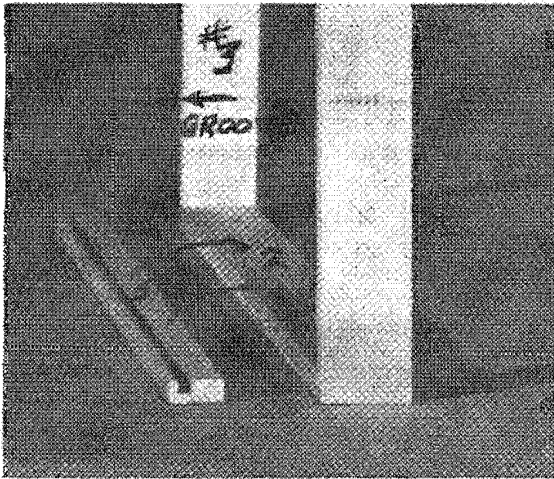
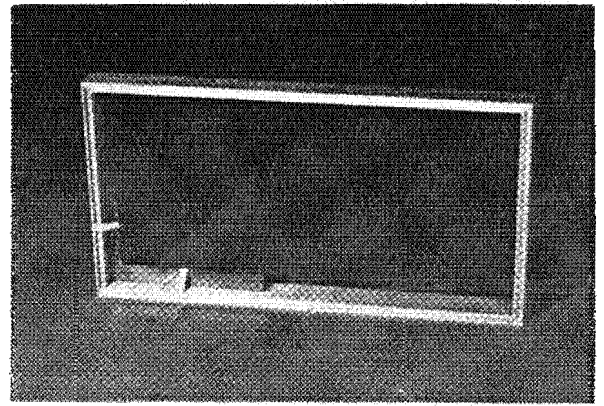

c. Glue and nail #5 to #2. Be absolutely sure that the grooves in #3 are toward #5. When in proper position, the groove in #5 will protrude beyond the frame as shown.

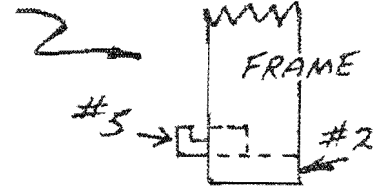

4. INSTALLATION OF L-STRIPS ONTO FRONT DOORS

Proper orientation and placement are important.

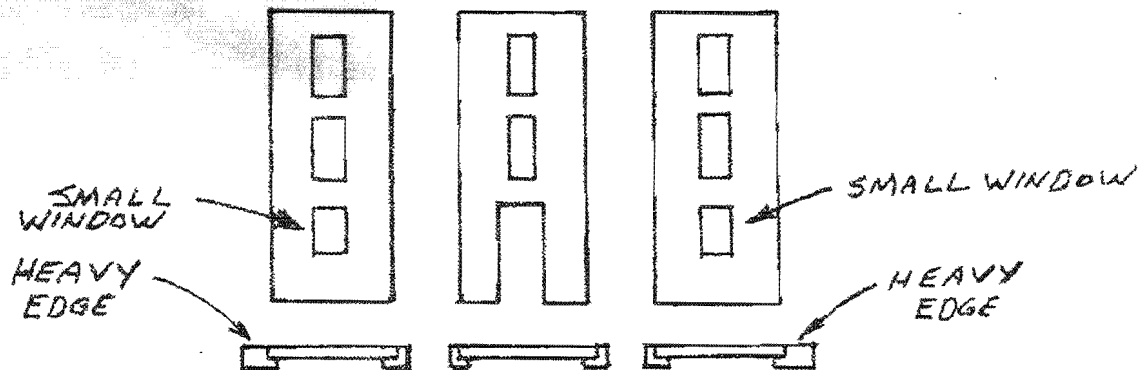

Referring to the above exaggerated drawing, observe the following:

- Good side of plywood down.
- Small window openings opposite door opening.
- Light L-Strips are between doors.
- Heavy L-Strips (with heavy edge up) are on the outside edges.

Glue and clamp strips to the edges of the doors to obtain tight joints - flush at both ends.

5. ASSEMBLY OF BACK PANELS

Lay the back panels on a smooth flat surface with the good side down. Join the two back panels with the splice strip as shown. The back panels should be flush with one end of the splice strip and protrude $\frac{3}{8}$ " beyond the other end. Use glue and $\frac{1}{2}$ " nails to assure a secure joint. When joining, be sure the back panels are tight together.

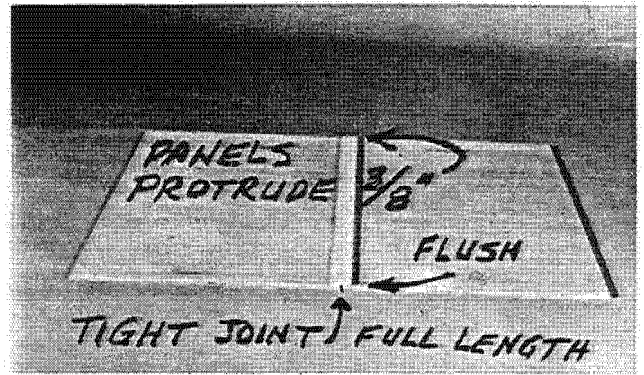

6. INSTALLATION OF RIGHT END ONTO GROUND FLOOR

Stand the ground floor assembly on end and, using a floor panel for support, glue and nail the right end to the underframe as shown. This arrangement allows nailing downward into a solid surface. Check to be sure:

- The good side of the plywood is up, (to the outside)
- The small window opening and the narrow space are oriented as shown.
- That the edges of the end are exactly flush with the underframe.

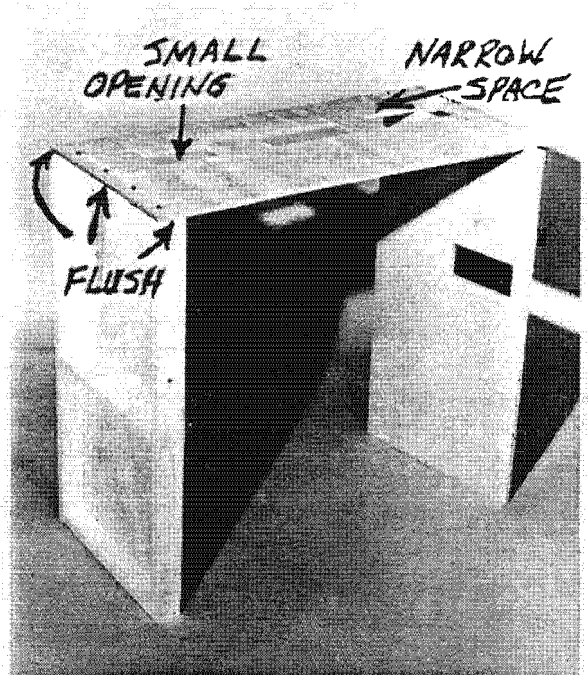

7. INSTALLATION OF LEFT END ONTO GROUND FLOOR

While avoiding strain on the glue joint from step 5, rotate the right end down onto the floor - and glue and nail the left end onto the underframe as shown. Again, carefully observe the position of the small window opening and the narrow space to be the same as the right end - and carefully observe the flush edges.

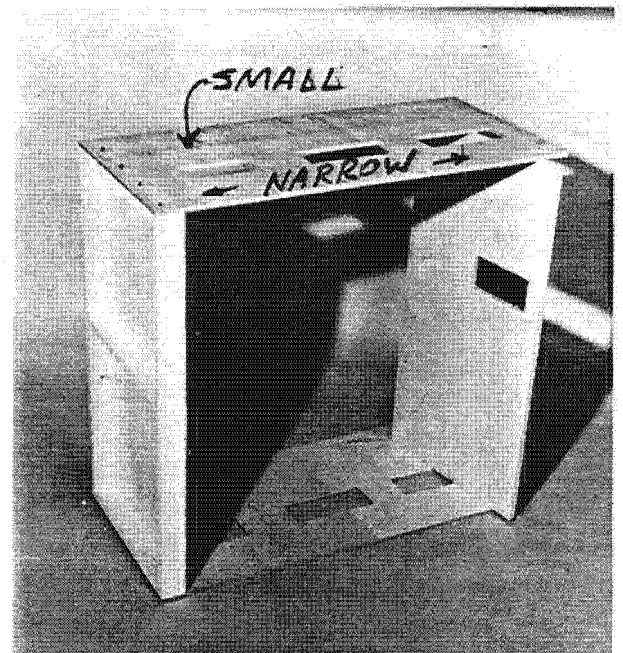

8. INSTALLATION OF BACK

Special care in this step is necessary to assure that the shell of the house is square - and also very essential to proper fit of everything that follows.

Again, with due care to the tender glue joints during movement, glue and nail the back onto the underframe and both ends. (Floor panel provides temporary support at top edge of back).

Special points to observe:

- a. Narrow space is down, wide space up next to back.
- b. Flush edge of splice strip down - flush with the bottom edge of the underframe.

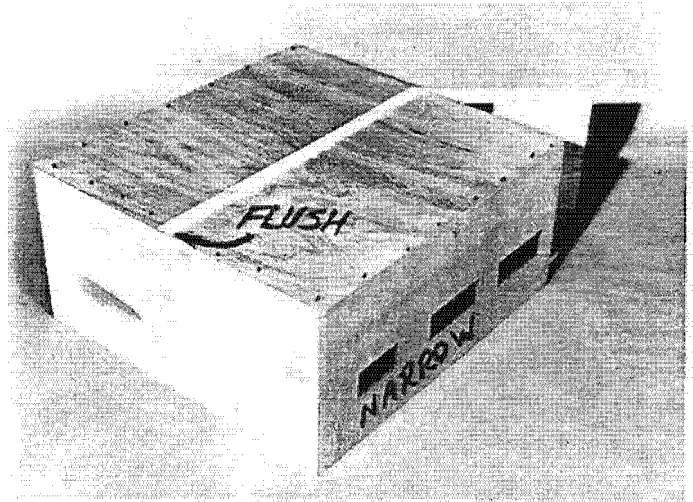

With utmost care to assure flush bottom edges and corners, nail the back to the underframe. Then nail the back to the edges of the ends - again being sure that all edges and corners are flush. When complete, check for square at the front and adjust as necessary to be square.

9. INSTALLATION OF SECOND & THIRD FLOORS

As shown, use partitions (10" high) out near the ends to establish the level for positioning the second floor. Be sure the partitions are vertical so that the second floor is level and a full 10" above the ground floor. Also, be sure the stairwell opening is oriented as shown. Apply glue to the edges of the floor making contact with the front and ends. Make marks on the outside of the ends and back $12\frac{3}{8}$ " up from the bottom edges. Using these marks, nail through the ends and back into the second floor. In the same manner, place partitions on the second floor to install the third floor. Exterior marks at $22\frac{3}{4}$ " up from the bottom edge.

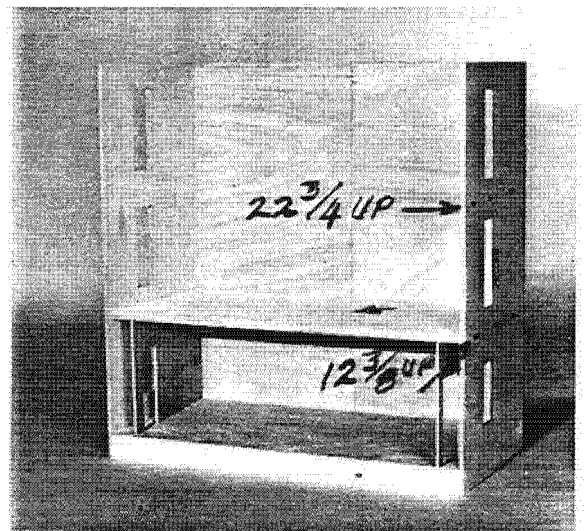

Special Note: At this point, check to be sure that the ends remain square with the ground floor.

10. INSTALLATION OF TOP VERTICAL AND HORIZONTAL FRAMES

Using plenty of glue to assure contact all around, glue the top vertical frame (assembled in step 3) onto the top edges of the back and ends. Glue and nail the top horizontal frame onto the front and sides of the vertical frame. Fit all three pieces together to get flush fits with the inside of the vertical frame - and good tight glued fits at the mitered corners. Nail into the recessed edges into the top of the vertical frame. If necessary, very fine nails can be inserted into the mitered corners to assure a tight glue joint. (Wood spackle can close any residual crack at the mitered corners).

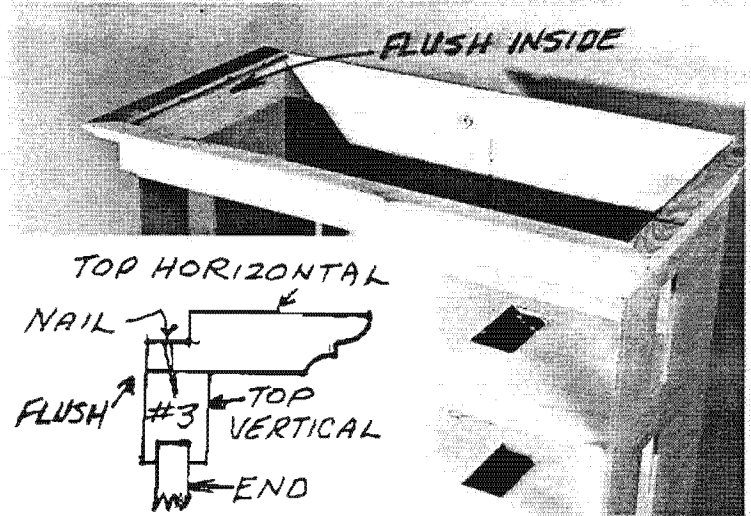

11. INSTALLATION OF 3rd LEVEL CEILING

When top frames are secure, turn the house upside down and, with glue applied, tilt the ceiling panel up as shown and slide it forward into the groove in piece #5 (see step 3c) and then down firmly against the edges of the vertical frame. Be sure the ceiling inserts cleanly into the entire length of the groove in #5 - binding here can destroy the square. Access through the window openings may help to move the ceiling panel into proper position. Apply weight and allow glue to set.

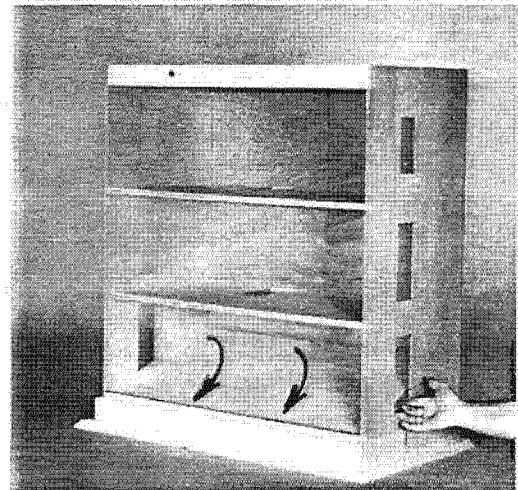

12. INSTALLATION OF L-STRIPS, FACING STRIPS AND LOWER SILL TO FRONT EDGES OF ENDS AND FLOORS

a. Glue two light L-strips to the front edges of the ends - with the L's flush on the inside edges as shown. Use clamps to assure tight glue joints.

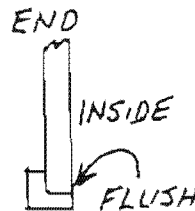

b. Glue the two facing strips to the front edges of the 2nd and 3rd floors.

c. Glue and nail the lower sill to the underframe as shown.

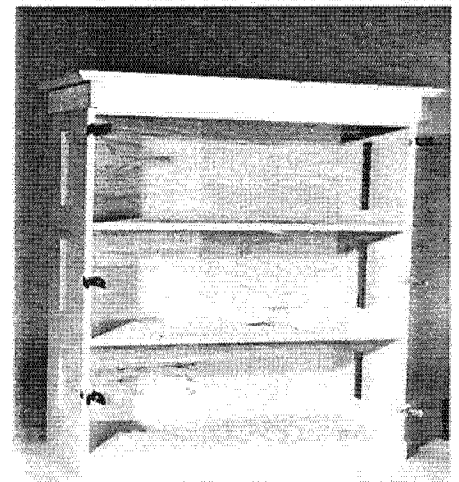

13. INSTALLATION OF HINGES BETWEEN BIFOLD DOORS

Note: Two of the nine hinges have a slotted hole in one leaf of the hinge. DO NOT use them in this step.

With bifold doors oriented as shown, (and tight together) install three hinges - one centered and two located 2" from top and bottom. Drill pilot holes 3/32" diameter and 1/2" deep.

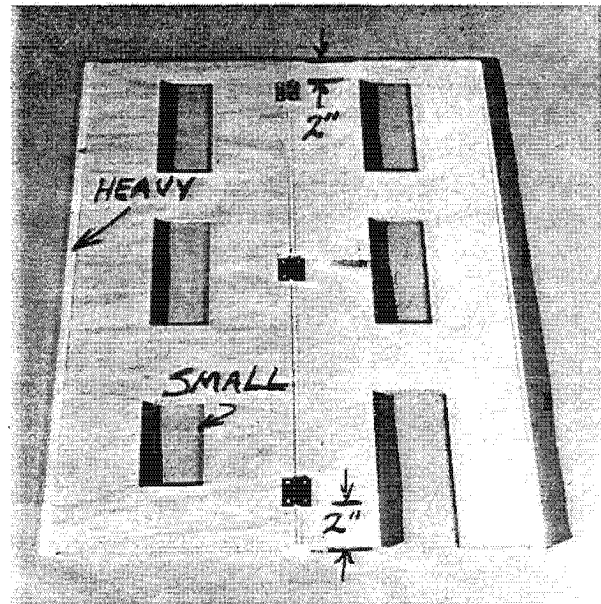

14. INSTALLATION OF HINGES TO THE OUTER DOORS

Using same spacing as above, install the two hinges with slotted holes at the top of the outer doors with hinge pins just outside the edge of the door as shown. Then install the remaining hinges as shown.

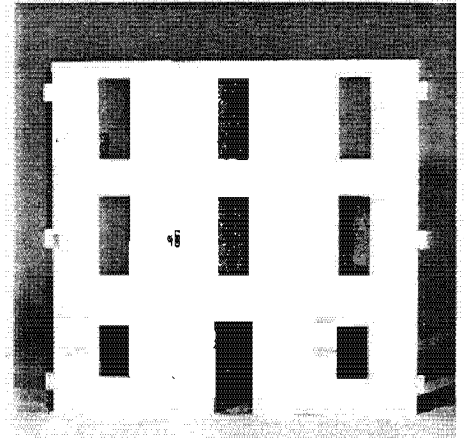
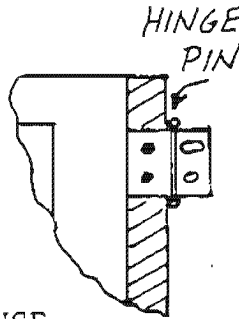

15. INSTALLATION OF DOORS ONTO HOUSE

The general technique here is to install one screw in the bottom hinge - and one screw in the center of the slot in the top hinge. Then swing the door shut into the opening. If the clearance at the bottom and top of the door is not equal, the door is not exactly plumb (vertical). Adjustment can be made by shifting the slotted hinge in or out to make the clearances even. After both the bifold and the single door are adjusted to be plumb, and the doors both close without interference, install all remaining screws. If doors make contact at center, shift the hinges outward on one side (or both if necessary) to get closure. Use the hinge hole not yet used for adjustment.

Install rotating door latches onto lower sill using #6 round head screws provided.

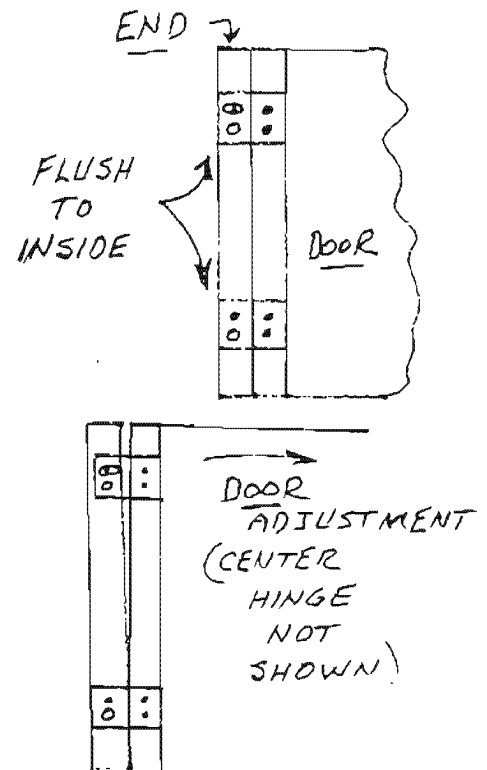

16. INSTALLATION OF DOOR, WINDOWS, TRIM AND FRONT STEPS

- a. Front steps are installed flush against the lower sill and spaced evenly left and right as shown.
- b. Prehung door is installed from the exterior - up far enough in the opening to have clearance above the steps as shown.
- c. The framed windows are installed from the interior (arches up).
- d. Exterior trim is glued around the windows, with the recessed edges of the side frames to the inside.

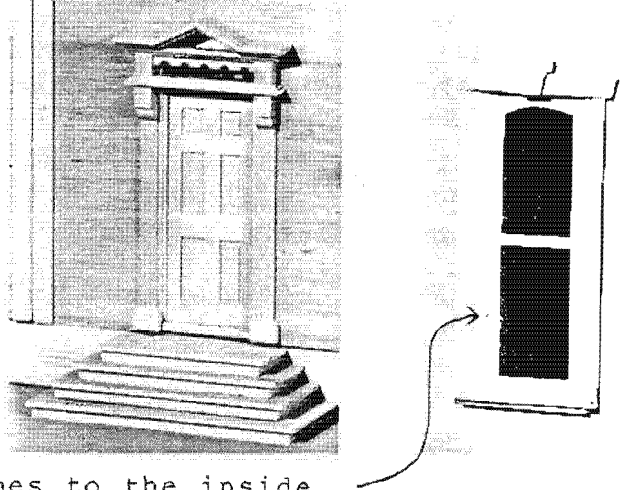

17. INSTALLATION OF ROOF, CHIMNEYS AND EAVE BRACKETS

- a. Assemble the roof top support with glue and nails and center it in 3rd level ceiling as shown.
- b. Assemble chimney parts and glue the chimneys to the roof top as shown.
- c. With the roof top on the support as shown, drop roof panels in place as shown - adjusting roof top to accommodate all panels. Glue is optional. A loose assembly could allow access for installation of transformer in the space under roof panels.
- d. To install the eave brackets on the front, glue the first one in place on one corner and the remaining 9 front brackets spaced at intervals of 3" inside to inside. To install the eave brackets on the ends, glue the first one in position on one corner and the remaining 5 at intervals of $2\frac{13}{16}$ " inside to inside.

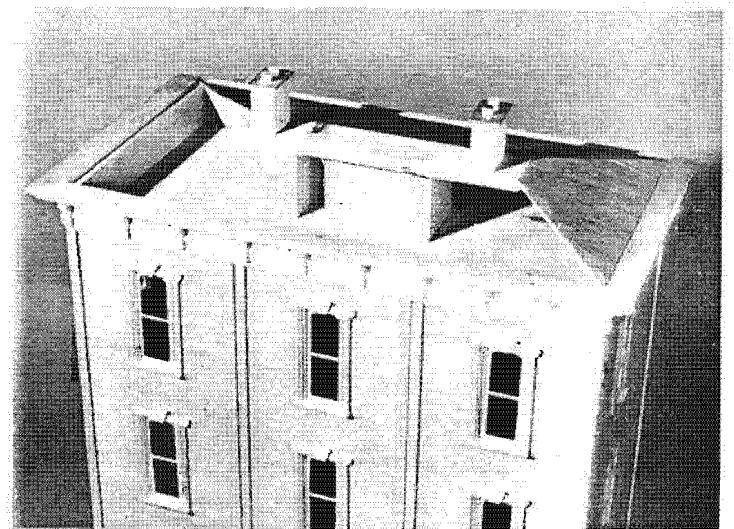
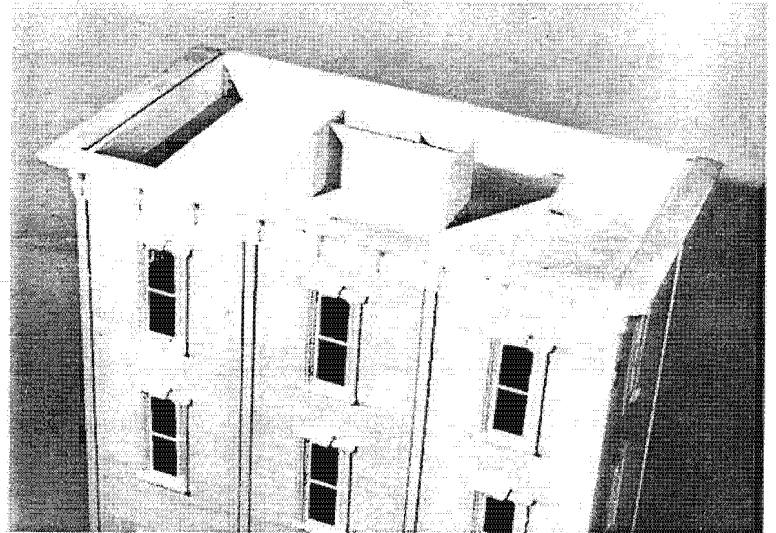

18. INSTALLATION OF PARTITIONS

Except for the partitions adjacent to the stair opening, the positioning of partitions is optional. The design arrangement is shown on the front cover sheet.

The partitions may be secured in place permanently with glue or temporarily with small nails through the floor above into the top edge of the partition.

Attachment of baseboard and cove molding (available separately) to the bottom and top of the partitions also facilitates the positioning of partitions.

19. INSTALLATION OF TRIM PARTS

(Refer to photos on front cover). In installing trim parts, masking (or scotch) tape is suitable to hold the trim parts until glue is set.

- a. Glue the square cut corner molding to the rear corners.
- b. Glue the 10" facing channels to the front edges of the partitions.

After all facings are installed, a light sanding of the edges will provide a smooth touch.

20. INSTALLATION OF STAIRS

Slip stairs into place from below. The top landing fits over the floor above and slides up against the front of the house. The stairs with the right hand handrail are installed between the ground floor and the second floor. The stairs with the left hand handrail between the second and third floors. Set upstairs rail in place on the 3rd floor. Glue is optional.