

A Miniature World Of Difference

KW-152



COLONIAL FARMHOUSE  
Scale Model House Kit #KW152

HOFCO HOUSE, INC.  
1 Council Drive  
P.O. BOX 103  
Woodsboro, Md. 21798

### THE SCIENCE OF HOFCO HOUSE

Congratulations! You have purchased today's most advanced architecturally designed house kit available. Since 1977 HOFCO HOUSE has engineered and perfected the finest scale model houses. Our success is directly attributed to satisfying the precise needs and dreams of our customers. Our advanced innovations easily create a realistic and intriguing miniature heirloom that you and future generations will cherish forever.

HOFCO HOUSE delights in hearing from you. Please send us pictures of your completed house to record in the "HOFCO HOUSE HALL OF FAME".

### HOFCO HOUSE, INC. WARRANTY

HOFCO HOUSE GUARANTEES ALL THEIR PRODUCTS! Every part must meet our high standards of quality before leaving our plant. Our research and development team scans the world market for the finest materials available. Sometimes a substitution is necessary. Any substitution of components will be of equal or better quality.

### ASSEMBLY INSTRUCTIONS

#### 1-PARTS LIST with approximate measurements

Identify location of parts by matching letters or numbers on photos, diagrams, and figures. To aid in identification, letters or names of parts are stamped on some of the parts. Quantity is indicated in "( )" parenthesis. If quantity of part is not listed, only one of the part is included.

Example: Below in the first item "A" on the figures locates the Assembled Foundation & First Floor. There is only one part 21 3/4" x 30 1/4", but there are four parts "F3" Partitions 3/8" x 15 1/2" x 9 5/8".

As all measurements are given in inches, the sign ("") for inches has been omitted for ease in reading the numbers in the following listing.

A	Assembled Foundation & First Floor 21 3/4 x 30 1/4	H	Porch Floor 3/8 x 5 7/8 x 31
B	Side Wall 3/8 x 15 1/2 x 28 1/2	I	Porch Roof 3/8 x 6 7/8 x 31 3/4
C	Second Floor 3/8 x 15 1/2 x 29 3/4	J	Front Roof 3/8 x 12 1/2 x 31 3/4
D	Attic Floor 3/8 x 15 1/2 x 29 3/4	K	Rear Upper Roof 3/8 x 2 x 31 3/4
E	Rear Wall 1/4 x 20 5/8 x 30 1/2	L	Rear Lower Roof 3/8 x 10 x 31 3/4
F	Partitions	M	Porch Roof Support 1/4 x 3/4 x 29 7/8
F1	3/8 x 5 3/4 x 9 1/2	N	Rear Upper Roof Reinforcement 3/8 x 2 x 28 3/4
F2	3/8 x 9 1/2 x 9 5/8	O	Rear Lower Roof Reinforcement 3/8 x 1 1/4 x 29 3/4
F3 (4)	3/8 x 15 1/2 x 9 5/8		
G	Front Wall 3/8 x 20 3/8 x 30 3/4		

- P Side Wall Trim
- P1 (2) 3/16 x 7/16 x 10 1/2
- P2 (2) 3/16 x 7/16 x 10 7/8
- P3 (2) 3/16 x 5/8 x 21
- P4 (2) 3/16 x 5/8 x 21 1/4
- Q Front Wall Right Edge Trim  
3/16 x 3/8 x 20 5/8
- R Front Wall Left Edge trim  
3/16 x 5/8 x 20 3/4
- S Front Wall Trim
- S1 (2) 3/16 x 5/8 x 8 3/8
- S2 3/16 x 5/8 x 11
- S3 3/16 x 5/8 x 11 3/8
- T Porch Post and Base (4)
- U Bathroom Partition Trim
- U1 3/16 x 3/8 x 9 1/2
- U2 3/16 x 5/8 x 9 5/8
- V Chimney (2)
- W Porch Step
- #1 Right & Left Entrance Porch Rail (2)
- #2 Side Porch Rail (2)
- #3 Front Porch Rail (2)
- #4 Extra Long Porch Newel Post (4)
- #5 Second Floor Interior Rail
- #6 Short Third Floor Interior Rail
- #7 Long Third Floor Interior Rail (2)
- #8 Interior Spacer Newel Post (2)
- #9 Interior Newel Post (4)

- Right Hand Stairway
- Left Hand Stairway
- Stairway Rail (2)
- Front Door
- Colonial Window (5)
- Hinges (9)
- Magnetic Catch (4)
- Nail Bag
- Sandpaper
- Colonial Farmhouse Instructions
- SPECIAL NOTE:  
Front Wall-Part "G" maybe warped. Don't worry this will straighten when you assemble porch
- SUPPLIES AND TOOLS NEEDED-floor & roof.

- Hammer
- Screwdriver
- Small Nail-set or Punch
- Ruler and Square
- Pencil
- Standard Wood Putty
- Standard Woodworking Glue
- Silicone Rubber (Optional)
- Paper Towels

HOFCO HOUSE REPLACEMENT POLICY

HOFCO HOUSE GUARANTEES ALL THEIR PARTS! We will replace any part at no charge regardless of the problem. Do not contact your dealer! Write or call HOFCO HOUSE CUSTOMER SERVICE direct. Please have the following information available:

- 1-Kit name and number \_\_\_\_\_
- 2-Replacement part name and number \_\_\_\_\_
- 3-Reason for replacement
  - ( ) Missing
  - ( ) Damaged
  - ( ) Accidentally broken
  - ( ) Warped beyond useability
- 4-Your name, address, and phone number

MAIL TO: HOFCO HOUSE, INC.  
1 Council Drive  
P.O. BOX 103  
Woodsboro, Md. 21798-0103

PHONE NUMBERS: Continental USA  
1-800-638-2069

Maryland  
1-800-233-9834

Other Areas  
1-301-898-7834

Customized Accessory List - Kit #KW152

Clapboard Siding to cover 1400 square inches  
 Roof Shingles to cover 1100 square inches  
 Interior Flooring for 3 floors to cover 1550 square inches  
 Porch Flooring to cover 200 square inches

2-General Directions

Read through each assembly direction and examine the corresponding photos and figures thoroughly before applying glue or nailing. This allows you to become familiar with the construction techniques.

Apply glue moderately to all parts to be joined together including those that are nailed. Nail wherever you think necessary. Always keep nails straight! Don't worry about any exposed nails in your house. After the glue has dried, punch the exposed nails out! Glue alone will secure the two parts. The main function of the nails is to hold the two parts together while the glue dries.

Read the "Time Saver Assembly Tips for the Customized House" before beginning the basic construction. You will save yourself time and money in later improvements. Assemble your house in the order suggested for a professional collectors item. Have patience and your efforts will be forever rewarded!

*Robert C. Holweck, President*

Robert C. Holweck  
 President

- 3- Side Wall - Parts B Photo-#1, #2, #3, #4, #5, #6, #7, & #8. Figure-#1 & #5  
 A-Apply glue to side edge of first floor.  
 B-Place side wall so that the edges are flush with the front and back edge of the first floor.  
 C-Nail using 1" wire brads or paneling nails along first floor. Be positive nails are straight!  
 D-Repeat for the other side.
- 4-Second Floor - Part C Photo-#9, #10, #11, #12, & #13. Figure-#4 & #5  
 A-Place a partition against the side walls of house. The partitions will serve as temporary support and a height gauge.  
 B-Apply glue on ends of floor.  
 C-Lay in the second floor from the back with the stairway opening somewhat towards the right side. Stairway opening in floor should measure about 5" from the rear and 4" from the front of the house.  
 D-Nail in place using 1" wire brads or paneling nails. Tap nails in straight to prevent splitting floor!
- 5-Attic Floor - Part D Photo-#14, #15, #16, & #17. Figure-#4 & #5  
 A-Place a partition against the side walls of house. The partition will serve as temporary support and a height gauge.  
 B-Apply glue on ends of floor.  
 C-Lay in the attic floor the same way as the second floor.  
 D-Nail in place using 1" wire brads or paneling nails.
- 6-Rear Wall - Part E Photo-#18, #19, #20, #21, & #22. Figure-#7  
 Note: This wall will "square" your house. Make sure walls are even!  
 A-Temporarily place partitions as shown in photo #18. They will serve as a temporary support and height gauge.  
 B-Place angled edge of rear wall at top and even with slant of side walls.  
 C-Apply glue to all contacting edges.  
 D-Nail with 3/4" wire brads making sure all side and top edges are even.

7-Partitions - Parts F Photo-#23, #24, #25, #26, #27, #28, #29, #30, #31, #32, #33, #34, #35, #36, & #37. Figure-#3 & #5  
 Note: Use your square and ruler on all partitions! Stairway partitions must be placed as shown. All other partitions may be placed to meet your individual needs.

- A-Glue and nail first floor partitions to left of stairway opening with the doorway toward the rear. Nail using 3/4" wire brads.
- B-Suggested placement of the other first floor partition part F3 is about 8 1/2" to the left of standing first floor partition with doorway toward the back.
- C-Glue and nail first floor partitions to right of stairway opening with the doorway toward the rear. Nail using 3/4" wire brads. Place a heavy object on second floor to hold partitions in place while drying.
- D-For bathroom partition it is necessary to assemble both walls including the hinges before placement in house. Place trim U1 on the side edge of partition F1. Generously glue this trim to allow a firm bond for hinges. Nail with 1/2" wire brads and allow to dry.
- E-Place trim U2 on the front side of partition F2. Generously glue this trim to allow a firm bond for hinges. Nail with 1/2" wire brads and allow to dry.
- F-Suggested placement of final partition F3 is in line with first floor partition F3. Glue and nail with 3/4" wire brads.
- G-Place two hinges starting about 3/4" from both ends of partitions. Center partition F1 which functions with partition F2 allowing a 1/16" space for painting. Punch screw holes with a nail and screw hinges in place.
- H-Set bathroom partition in place to be familiar with final installation. Glue and nail part F2 in place allowing about 1/16" space between part F1 & F3.
- I-Place a heavy object on attic floor to help hold partitions in place while drying.

8-Assembling Rear Lower Roof and Reinforcement - Parts L & O Photo-#38 & #39.

- A-Center reinforcement with long edge of rear lower roof.
- B-Generously glue and nail with 1/2" wire brads.

9-Installation of Rear Lower Roof with Reinforcement Photo-#40, #41, & #42.  
 Figure-#7 & #9

Note: Reinforcement allows stability for roof hinges.

- A-Lay rear lower roof on top edges of back and side with reinforcement at top.
- B-Temporarily lay part K above part L and allow a 1/16" space below the peak of the roof. This space is necessary to allow for painting.
- C-Glue and nail part L in place using 3/4" and 1" wire brads.

10-Side Wall Trims - Parts P1, P2, P3 & P4 Photo-#43, #44, #45, #46, #47, #48, & #49.  
 Figure-#8 & #9

- A-Glue and nail parts P3 trims flush with the rear wall using 1/2" wire brads.
- B-Generously glue parts P4 flush with front edge of side walls to allow a firm bond for hinges. Nail with 1/2" wire brads.
- C-Glue and nail parts P2 flush under rear lower roof and even with peak of roof. Nail with 1/2" wire brads.
- D-Glue and nail parts P1 even with top of side wall and flush with other moldings. Nail with 1/2" wire brads.

11-Front Wall and Right Edge Trim - Parts G & Q Photo-#50, #51, & #52. Figure-#6

Note: Generously glue this trim to allow a firm bond for hinges!

- A-Place trim Q on the side edge of the front wall nearest the doorway with the front wall angle and trim angle matching at top. Glue and nail with 3/4" wire brads.

12-Porch Roof Support - Part M Photo-#53. Figure-#6

- A-Place support for porch on front of Front Wall with top of support 11 3/8" from bottom edge and right side of support indented 5/8" from edge.
- B-Glue and nail with 1/2" wire brads.

## 13-Temporary Installation of Front Wall Photo-#54, #56, &amp; #57. Figure-#8

Note: This process is necessary to align front porch, assure proper opening, and allow for thickness of paint. Also this will remove any bowing or twist in the front wall when totally finished.

- A-Lay house on back. Position front wall in place with bottom of front wall against foundation and right side wall flush with trim part P4.
- B-Place 3/4" wire brads as a spacer for future painting between right front wall and side wall. The left front wall will extend slightly beyond trim part P4.
- C-Temporarily nail front wall squarely in place with 1" wire brads on the outer corners. Allow nails to extend for removal. Set house upright!

## 14-Nail-setting of Hinge Area Photo-#54

- A-Inset nails with a nail punch.
- B-Fill holes with standard wood putty and allow to dry.

## 15-Porch Floor - Part H Photo-#55, #56, &amp; #57. Figure-#8 &amp; #9

Note: Make certain no glue touches the foundation!

- A-Position porch floor even with right side of front wall including trim Q. Glue to front wall only!
- B-Press porch floor firmly against front wall and temporarily nail 1" wire brads into porch foundation to hold porch floor in place while drying and constructing porch. FOR EASE IN REMOVING NAILS, DO NOT DRIVE BRADS IN TOO FAR!

## 16-Porch Posts and Bases - Parts T Photo-#58 &amp; #59.

- A-Generously apply glue to flat end of post.
- B-Center post base on post.
- C-Press firmly together and nail with 3/4" wire brads.

## 17-Installation of Porch Posts Photo-#60, #61, &amp; #62. Figure-#8 &amp; #9

- A-Pre-nail 3/4" wire brads at an angle into porch post base only. Then generously glue and nail flush with outer corners of porch.
- B-Using front porch rail #3 as a spacer, glue, position, and nail porch posts in place.

## 18-Front Wall Left Edge Trim - Part R Photo-#63 &amp; #64.

- A-Position trim flush with the front wall with the angles matching at the top. Glue and nail with 3/4" wire brads.

## 19-Porch Roof - Part I Photo-#65, #66, #67, &amp; #68. Figure-#8 &amp; #9

- A-Generously glue all contacting edges of porch roof.
- B-Position approximately 3/8" beyond front wall trim edge part Q.
- C-Nail through roof into porch roof support using 1" wire brads.
- D-Using your ruler and square measure from front wall to post bottom and position post the same distance at top.
- E-Glue and nail through roof into porch post with 1" wire brads.
- F-Repeat procedure measuring in all directions for proper placement for each post.

## 20-Front Wall Trim - Parts S1, S2 &amp; S3 Photo-#69, #70, #71, &amp; #72. Figure-#8 &amp; #9

- A-Generously apply glue to part S2 and place under porch roof flush with edge of right front wall edge trim. Nail with 1/2" wire brads.
- B-Generously apply glue to part S1 and place above porch roof flush with edge of right front wall edge trim. Nail with 1/2" wire brads.
- C-Repeat above procedures for left front wall trim except part S3 has a notch for the porch floor.

IMPORTANT! ALLOW ALL TRIM TO DRY AT LEAST ONE HOUR!

- 21-Installation of Front Wall Hinges Photo-#73, #74, #75, #76, #77, & #78.  
 A-Sand hinge area. Figure-#8 & #9  
 B-Position four hinges evenly across the trim starting about 3/4" from both sides.  
 C-Punch screw holes with a nail on side wall of house only. Screw hinges in place.  
 D-Some hinges are not tight in the joints which may cause the front wall to drop when opened. Therefore, pull top hinge up before setting in screws and bottom hinge down before setting in screws. Then screw in other hinges.
- 22-Rear Upper Roof and Reinforcement - Parts K & N Photo-#79 & #80.  
 A-Center reinforcement with long edges of rear upper roof.  
 B-Generously glue and nail with 1/2" wire brads.
- 23-Front Roof - Part J Photo-#81, #82, #83, #84, & #85. Figure-#2, #7, #8, & #9  
 Important! If front roof is bowed, place reinforcement strip on opposite side so that sides of roof are low and the middle of roof is high.  
 A-Form peak of roof so that front roof is over rear upper roof.  
 B-Glue and nail with 1" wire brads.  
 C-Immediately check for fit by placing roof on house. If roof is bowed up on a side, slightly twist roof in opposite direction on an edge of a table. Then check for even fit. A magnetic catch will be installed later which will also pull in the roof.
- 24-Roof Hinges Photo-#86 & #87. Figure-#7  
 A-Place front roof and rear upper roof in position.  
 B-Place three hinges evenly across the rear roof starting about 1 1/2" from both ends. Center the middle hinge.  
 C-Punch screw holes with a nail and screw hinges in place.
- 25-Chimney - Part V Photo-#88. Figure-#8 & #9  
 A-Generously glue angled bottom of chimneys and position in place at top of roof approximately 3/4" from side edge.
- 26-Porch Rails and Porch Newel Posts - Parts #1, #2, #3, #4, & W Photo-#89, #90, #91, #92, #93, #94, #95, #96.  
 Note: If you use Silicone Rubber to glue you stairway, railings, windows, or doors, they can be removed at a later time without much difficulty to paint or decorate. Silicone Rubber is available at most hardware stores.  
 A-Some adjustments may be needed in railing lengths. Sand or cut if necessary.  
 B-The photo diagrams show the placement of the railing by the numbers on the parts list.  
 C-Glue assembled railing sections in place.  
 D-It is helpful to use masking tape to hold rails in place until dry.  
 E-Center porch step between extra long porch newel post #4. Glue to porch floor.
- 27-Stairway Photo-#97 & #98.  
 Note: It is easier to decorate the interior before the installation of the stairway.  
 A-Apply glue to side and bottom of stairway and the edge of the top floor.  
 B-Set in place and allow to dry.
- 28-Stairway Railing - Parts #5, #6, #7, #8 & #9. Photo-#99, #100, #101, #102, #103, #104, & #105.  
 A-Assemble one spacer newel post #8 to one end of rail #5 making sure it will be on the stairway railing to the attic. Then assemble one newel post #9 to the other end.  
 B-Assemble one spacer newel post #8 to one end of rail #7.

## 28-Stairway Railing - continued

- C-Assemble one newel post #9 to one end of rail #7. Then assemble one newel post #9 to both ends of the other rail #7.
- D-Glue railing #5 on the second floor between the first and second floor stairway with spacer newel post #8 at bottom of stairway to the attic.
- E-Glue rail #6 and #7 about attic floor stairway openings.

## 29-Magnetic Catches Photo-#107.

- A-Screw a catch under second and attic floors about 1 1/2" in from left side wall.
- B-Screw plates in line with magnetic catches on back of front wall.
- C-Screw a catch under the side of the roof that may need to be pulled in.
- D-Screw plate in line with magnetic catch.

## 30-Windows and Doors Photo-#108.

Note: Paint windows and doors before you glue them in place or glue them with Silicone Rubber so you can remove them at a future date!

- A-Glue lightly the back of the window and door frames and position them in place. Do not nail! Allow to dry using masking tape to hold them in place.
- B-Read instructions on the box of windows and doors for more helpful information.

See your local dealer for  
Customized Accessories to  
 complement your house!



A Miniature World Of Difference



"TIME SAVER ASSEMBLY TIPS FOR THE CUSTOMIZED HOUSE"

**SIDING:**

It is easier to install the siding before you install the windows, doors, and porch roof. When the siding has reached the porch roof supports, install the roof and continue assembling your house.

**ROOF COVERING:** #1302 Square Butt Shingles for Colonial Styles...#1304 Fishscale for Victorian Styles...#1306 Octagon for Federal and Victorian Styles

You can install your cedar shingles at anytime during the construction of your house. To give a professional touch to your roof add roof molding and cap.

#1207 Roof Bottom Edge Molding...#1211 Pine Molding Strips for roof ends  
...#1221 Cedar Roof Cap for finishing peak of roof

**FLOOR COVERING:** #1231 Walnut...#1232 Oak...#1233 Pine...#1234 Cherry

You may use hardwood flooring inside and masonry on the porches or any combination you wish. As glue will not adhere to masonry surfaces, you must work around the porch and railing posts or use a special glue. Also, you should consider the effect the added height or lack of it would do to the roof or other areas of the house!

**MASONRY:** Brick, stone, and stucco may be applied on the foundation at anytime after you have installed the porch steps. The porch floor overhangs about 3/16" to allow for any masonry work. It is easier to install masonry work to the sides and front of the chimney before you glue and nail it to the house. Then you can finish the back side around the roof peak after the chimney is installed.

**DUSTPROOFING:** #1270 and #1271 Plexi-glass Brackets

Plexi-glass is used to provide a see-through cover for the back of your house. Your local hardware store will cut the plexi-glass to your precise measurements. Use HOFCO HOUSE Plexi-glass Brackets for ease in removing and replacing your covering. The Plexi-glass slides in from the top. Install this special bracket before measuring the Plexi-glass for exact size. This cover gives dust-free and security protection for display.

**PAINTING:** Regular exterior latex primer and latex house paint in the colors of your choice is used. It is convenient to apply the paint with a small one-inch brush for larger areas and a smaller art brush for fine detailed painting. First, prime all areas that are to be painted. Then sand the areas with fine sandpaper...before painting the finishing coat in the color of your choice. Don't forget to paint the interior ceilings before wallpapering and the installation of any special floor covering.

**ORDER OF DECORATION:** If possible decorate the interior of your house in this order!

1-Install the electrical lighting using a wiring kit. 2-Paint your ceilings.  
3-Lay and finish your hardwood flooring. 4-Stain or paint all interior trim including windows, doors, stairways, railings, and all moldings before gluing in place. 5-Wallpaper your walls. 6-Glue finish trims in place.



HOFCO HOUSE, INC.

KW152 COL. FARMHOUSE KIT

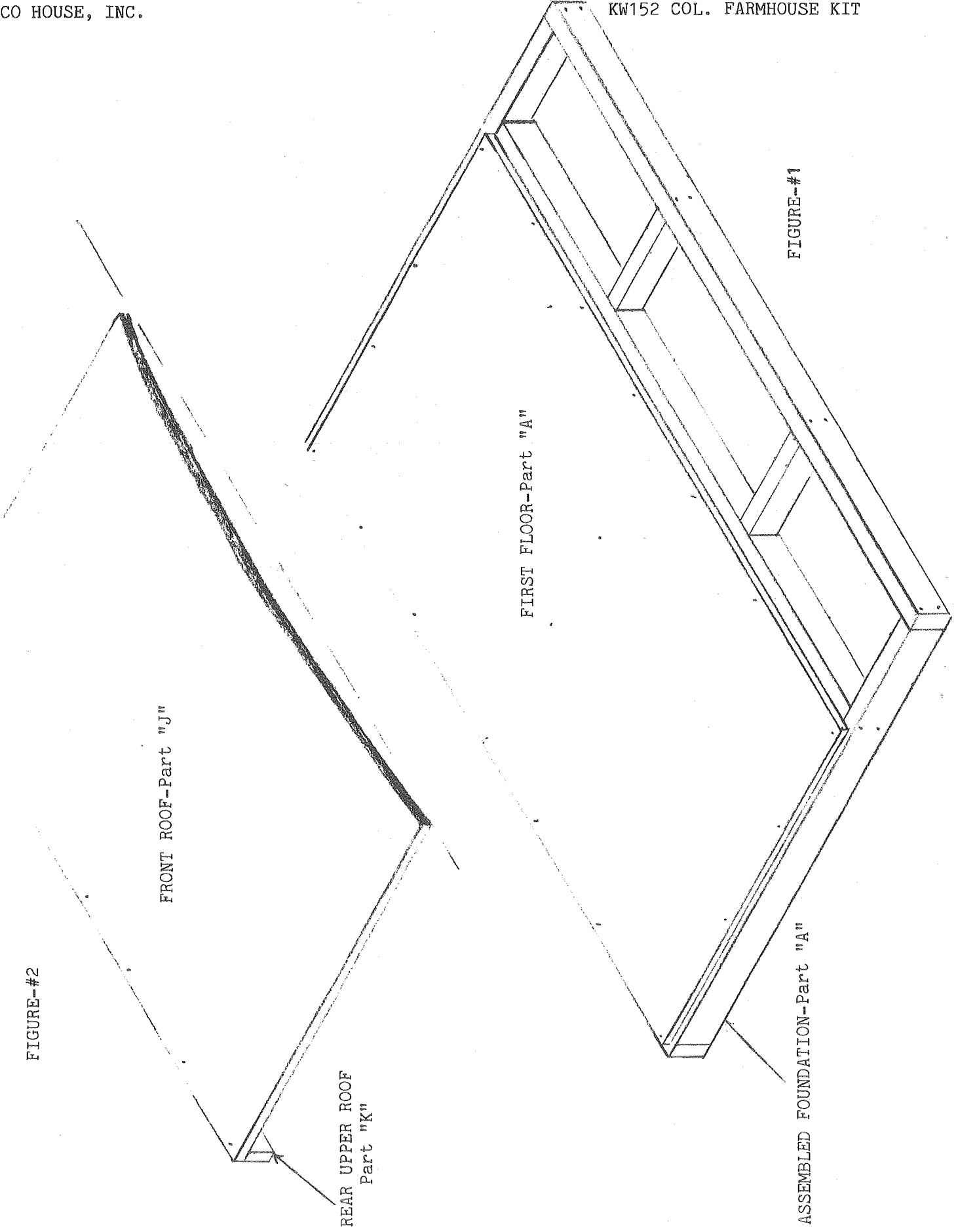

FIGURE-#2

FRONT ROOF-Part "J"

REAR UPPER ROOF  
Part "K"

FIRST FLOOR-Part "A"

FIGURE-#1

ASSEMBLED FOUNDATION-Part "A"

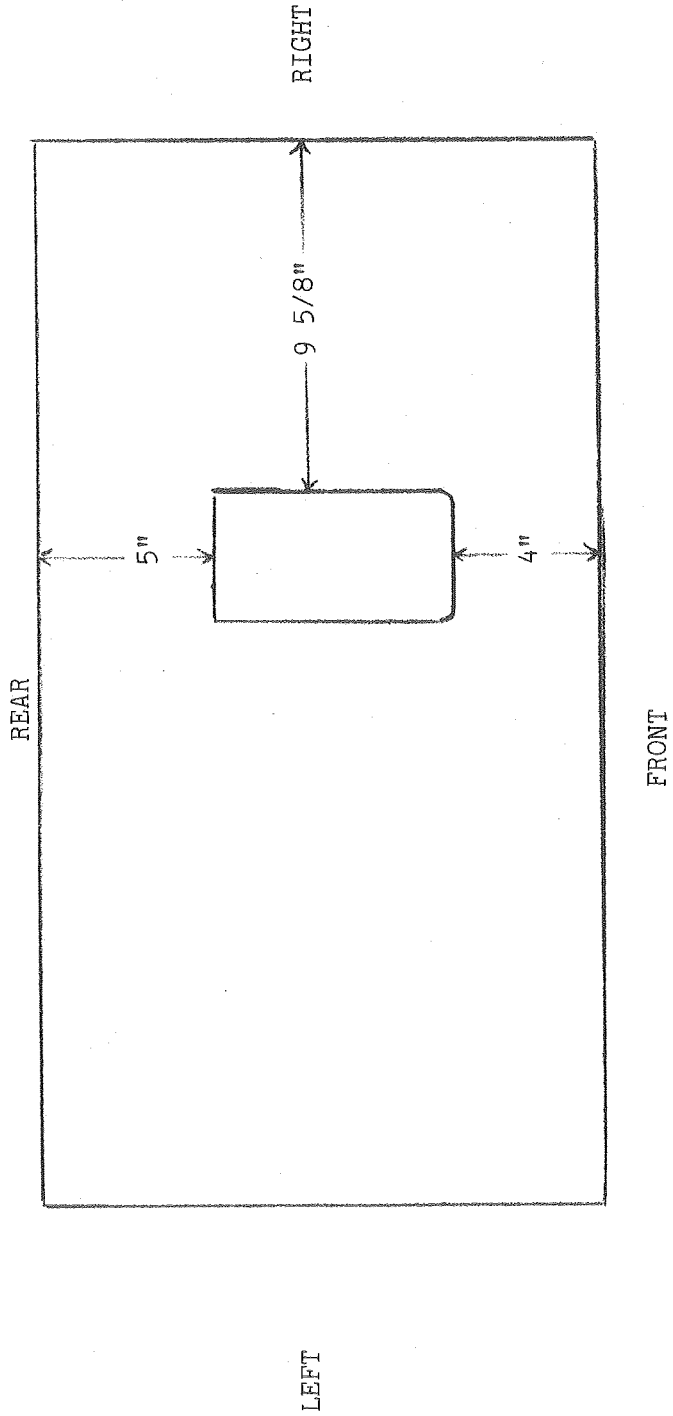
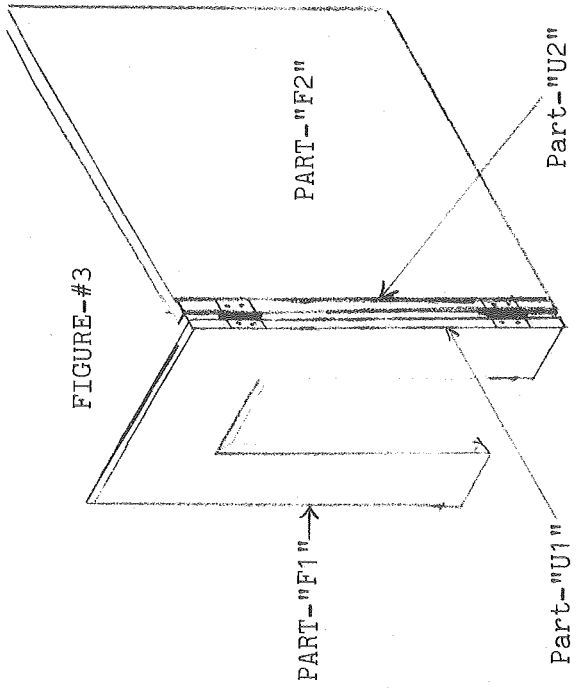

FIGURE-#4

FIGURE-#3

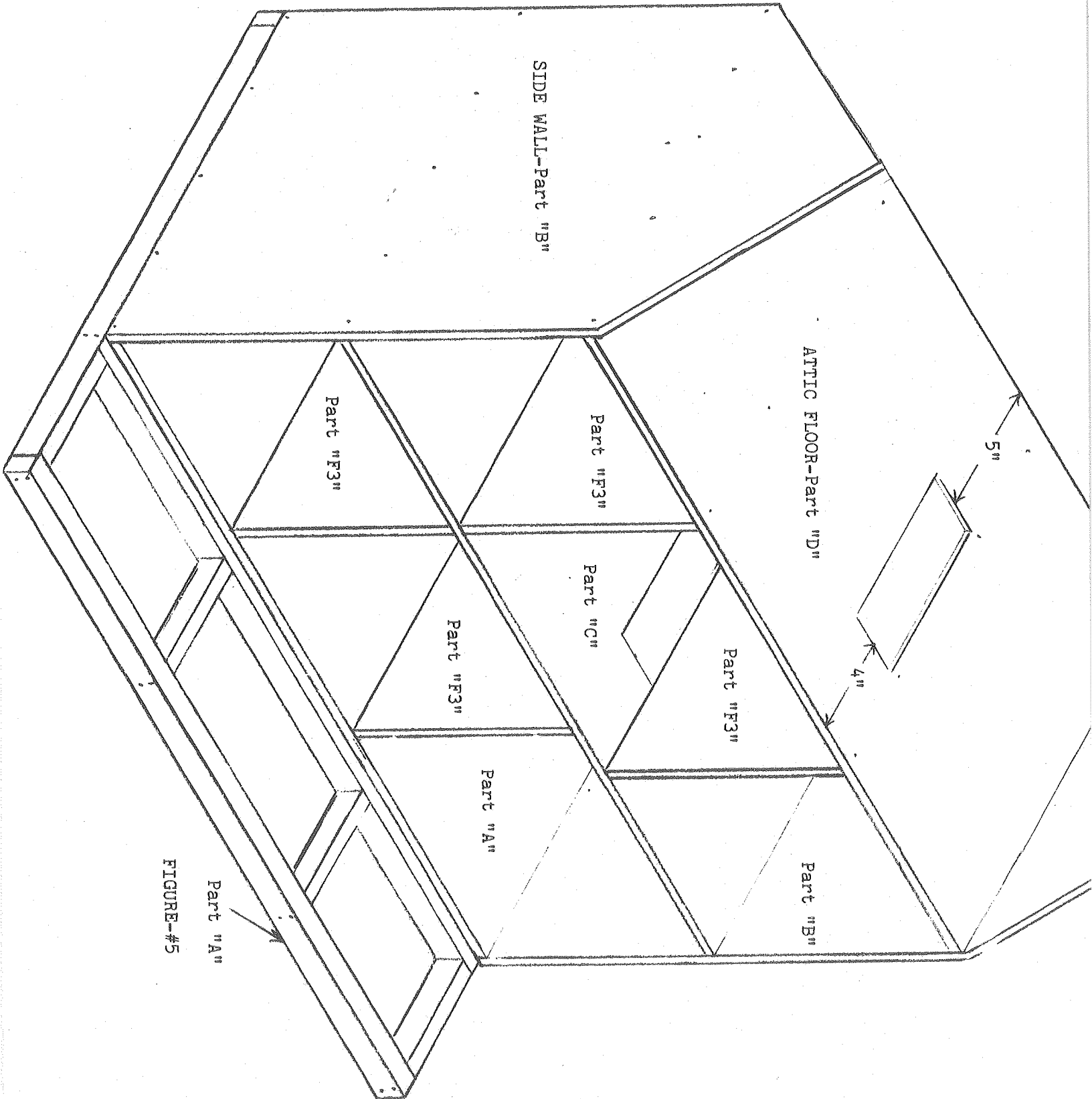
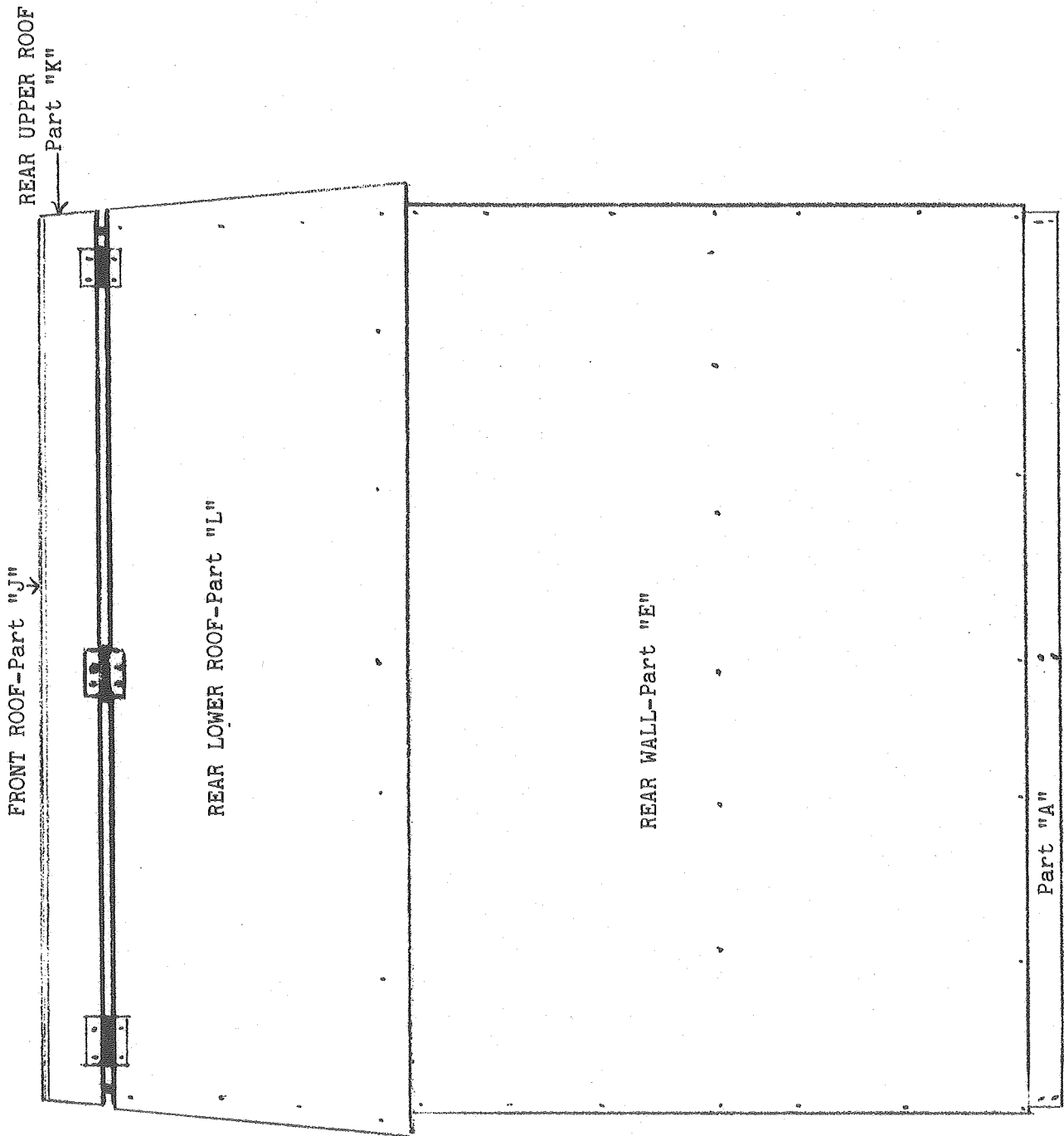

FIGURE-#5

FIGURE-#7



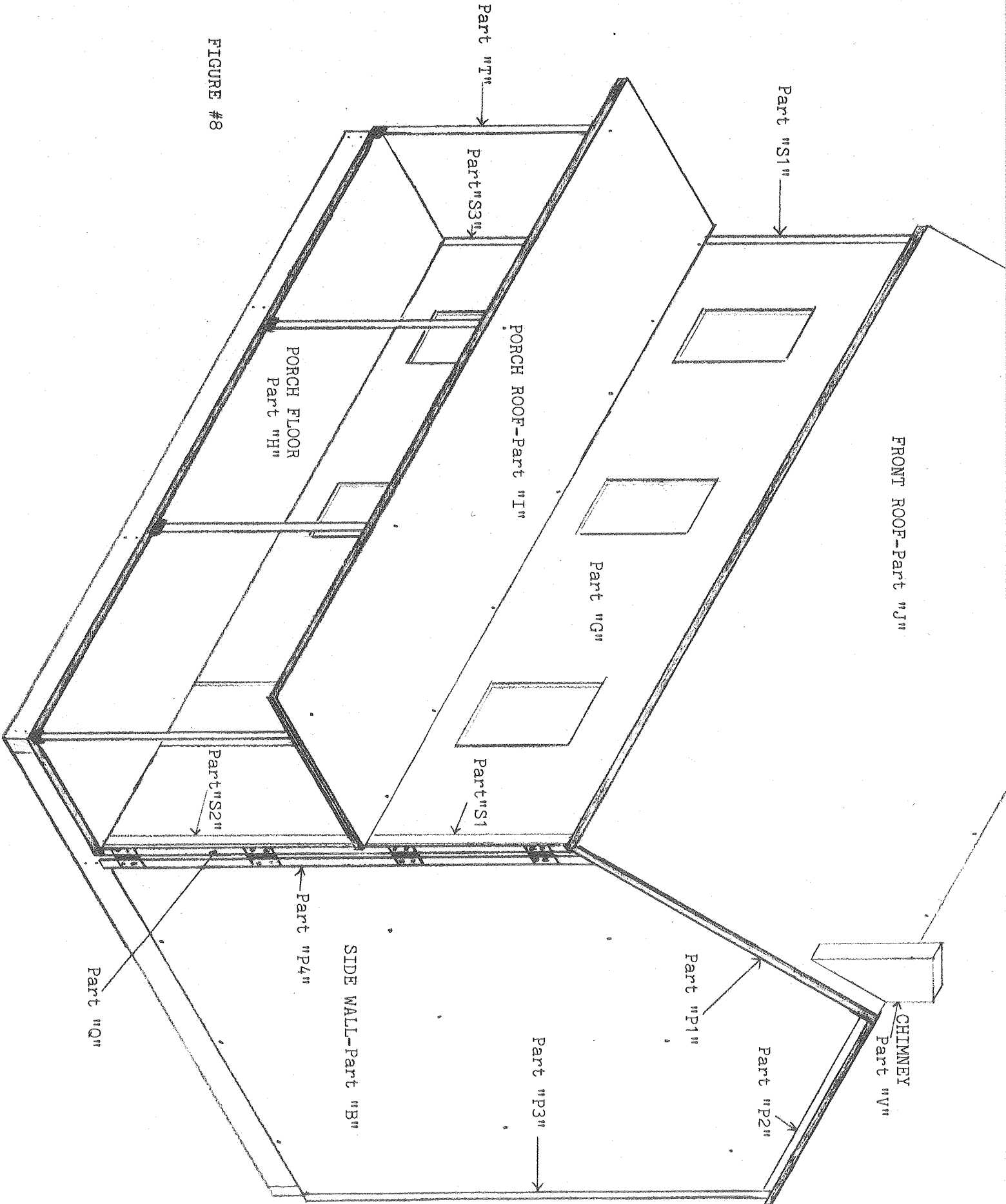
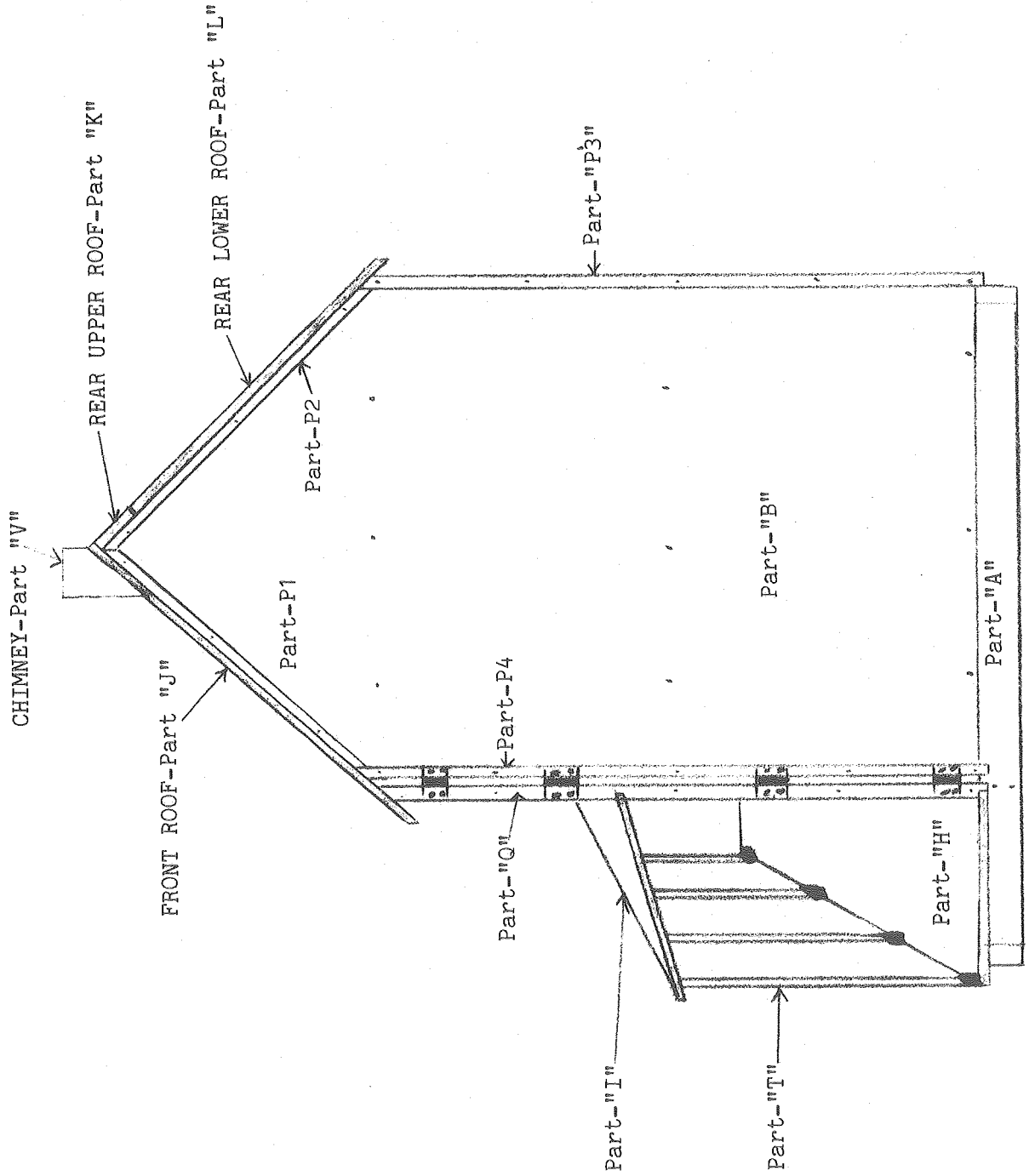
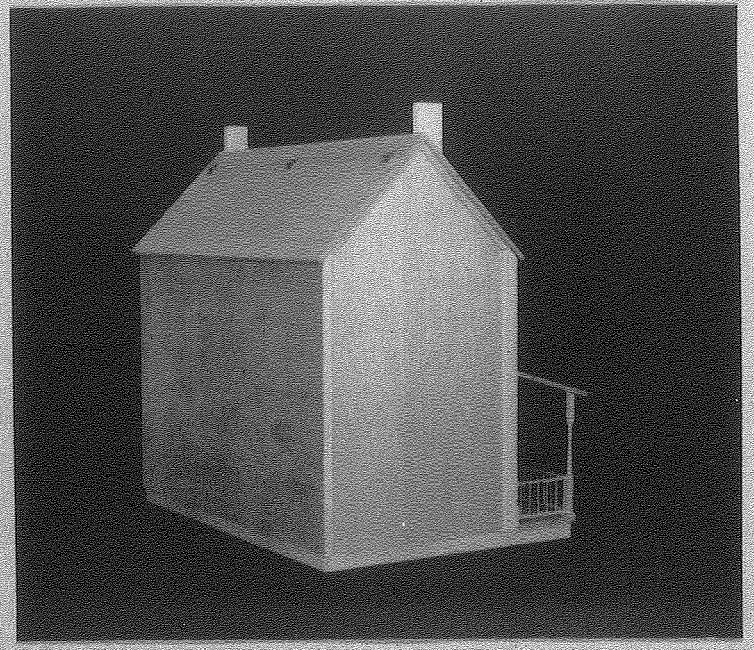
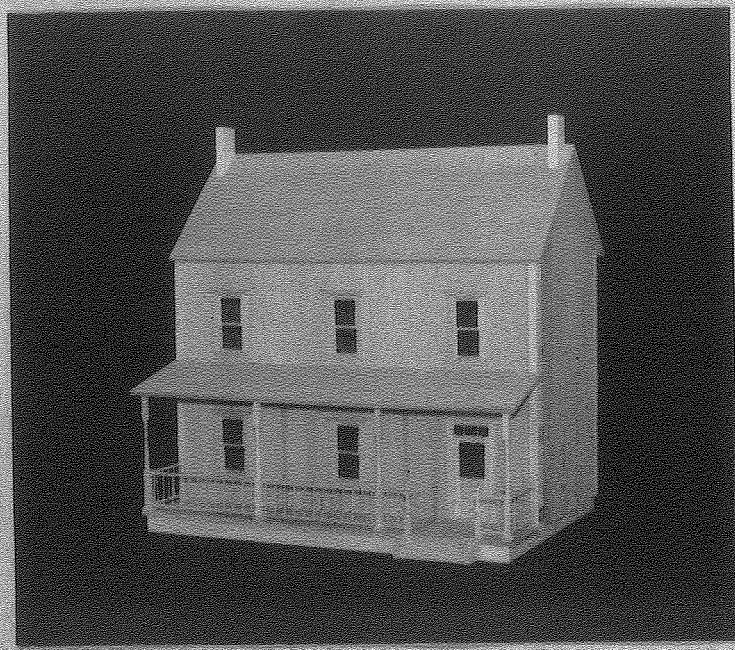

FIGURE #8

HOFCO HOUSE, INC.  
FIGURE-#9

#KW152 COLONIAL FARMHOUSE KIT





**HOFCO® House, Inc.**

1 Council Drive  
P.O. BOX 103  
WOODSBORO, MARYLAND 21798

# KW-152 COLONIAL FARMHOUSE FULL FRONT OPENING

DIMENSIONS: 23 1/2" DEEP  
32" LENGTH  
32 1/2" HEIGHT

SHIPPING WEIGHT: 42 POUNDS  
DESCRIPTION: SEVEN ROOMS - PLUS ATTIC

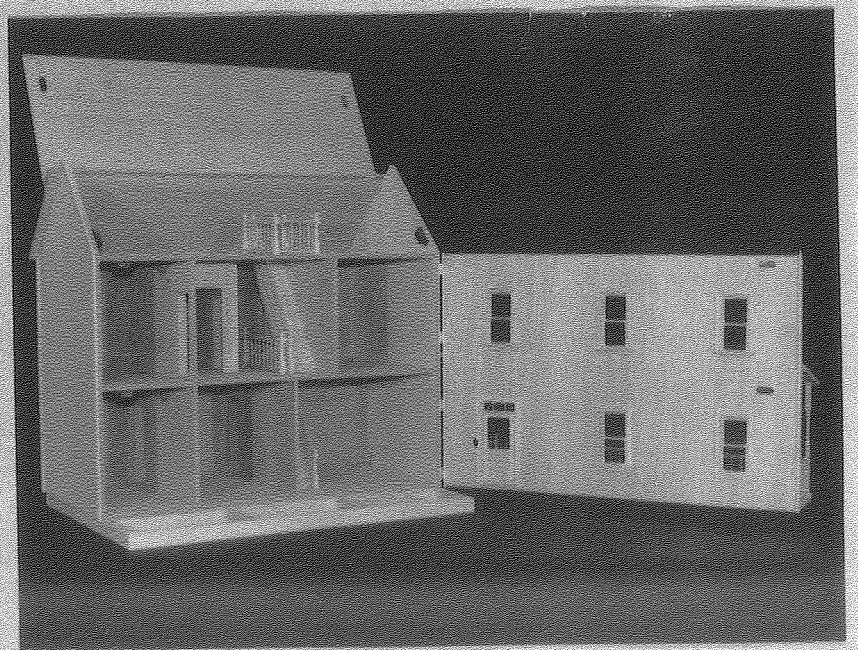
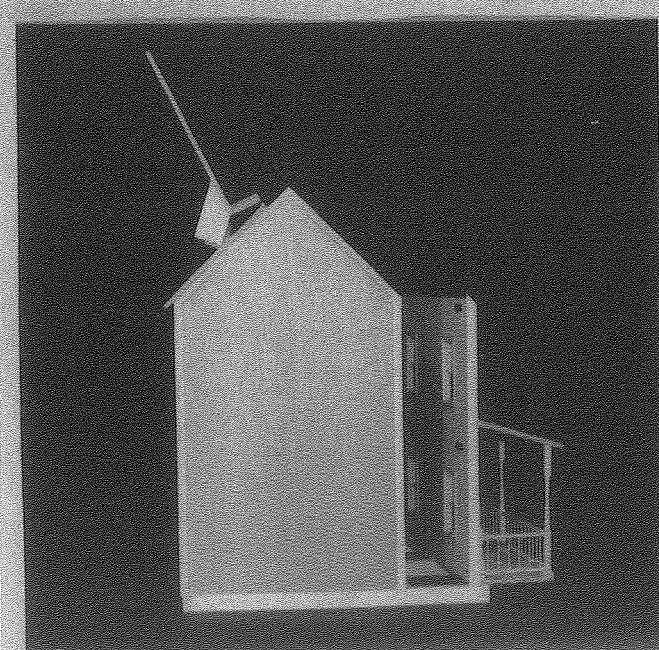

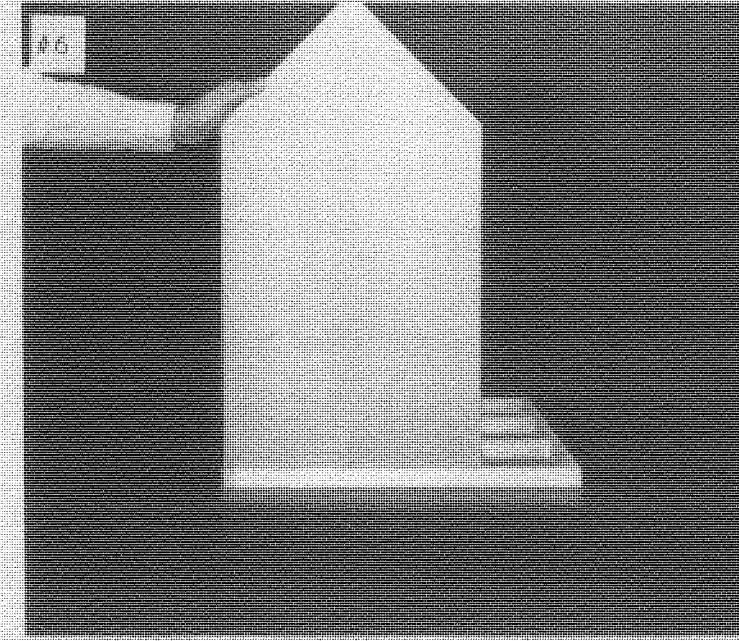
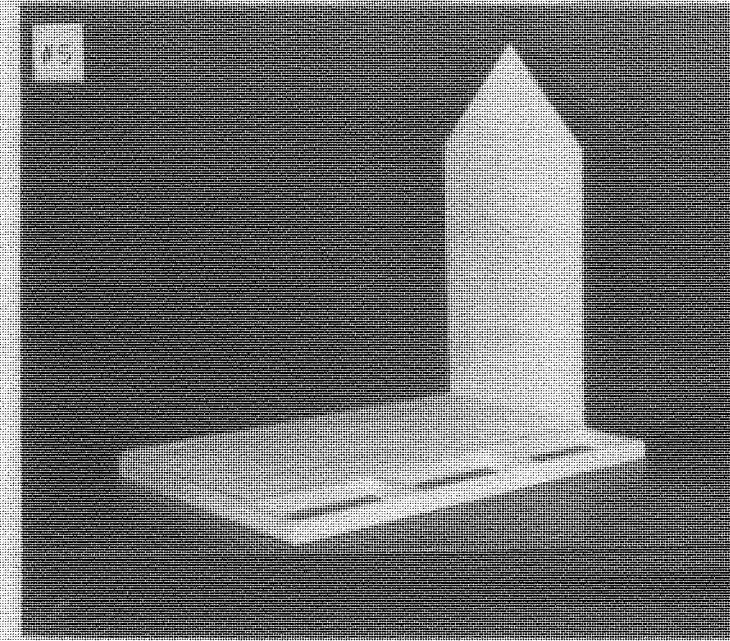
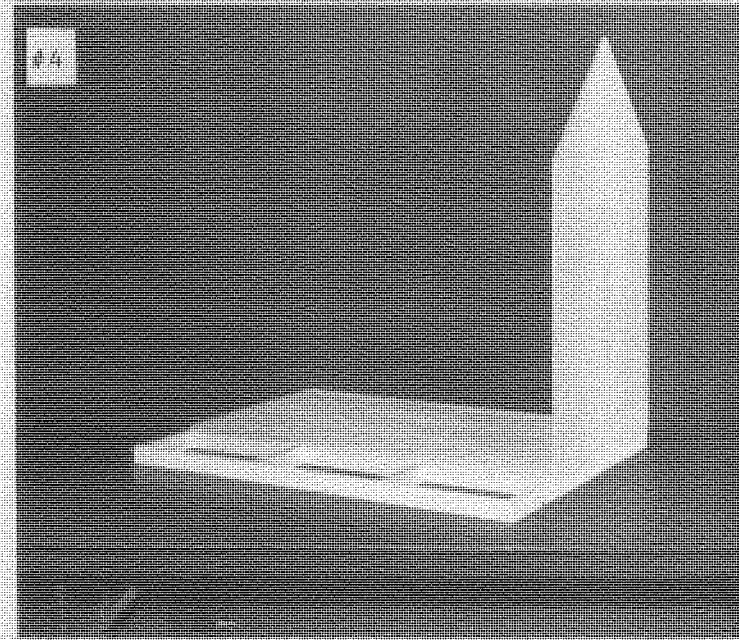
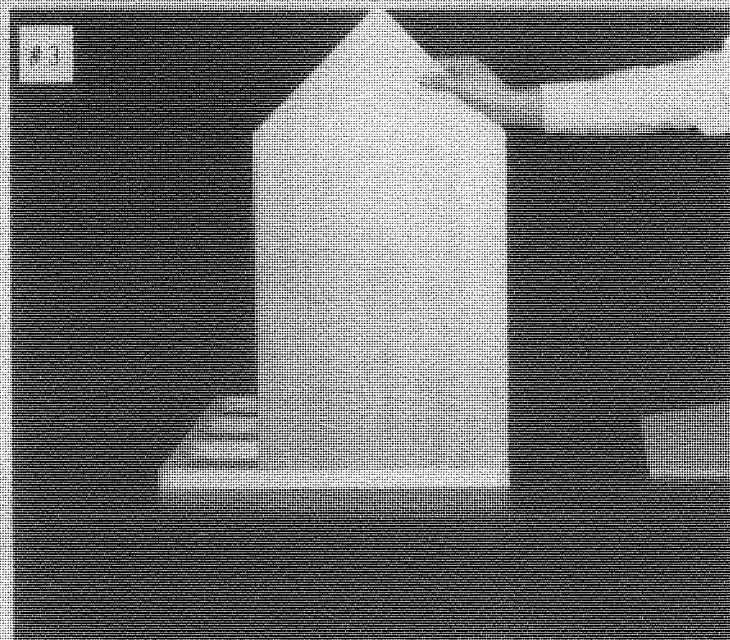
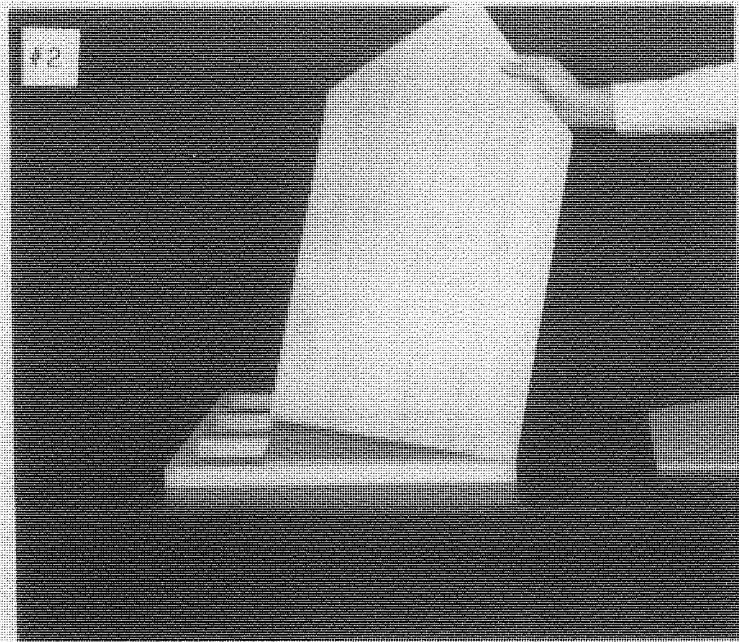
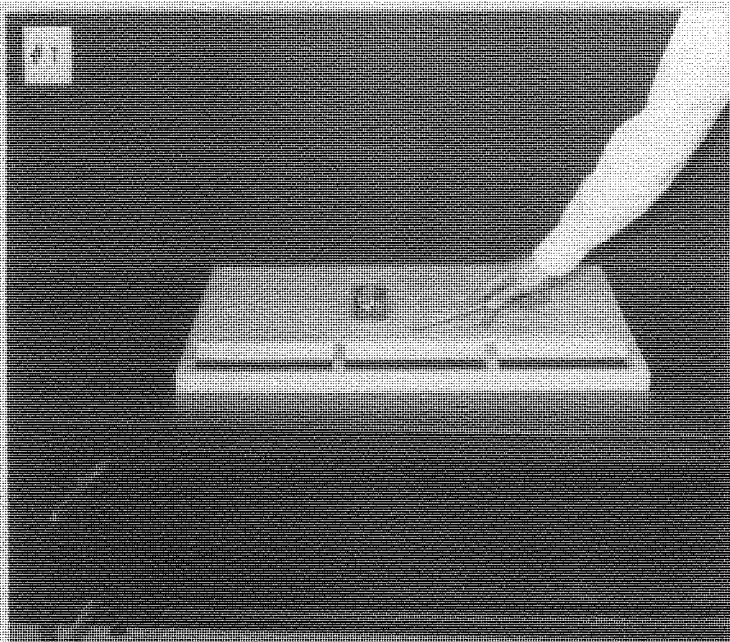



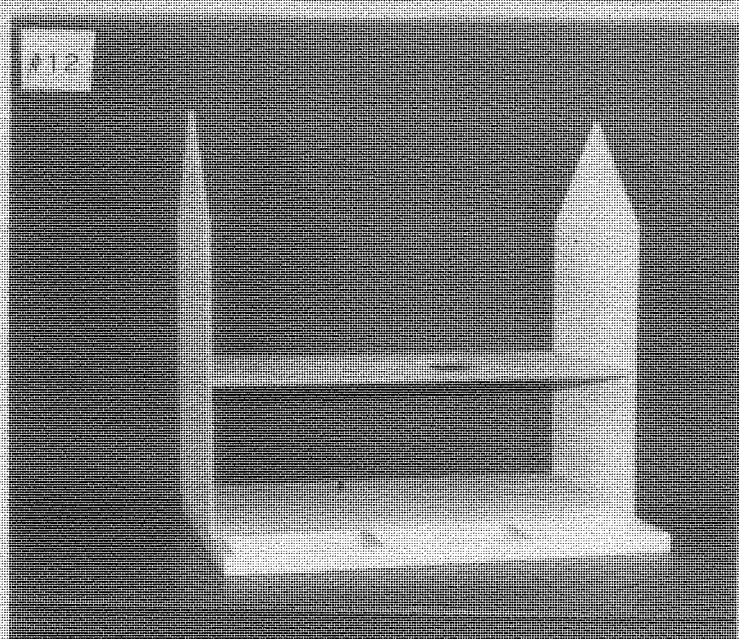
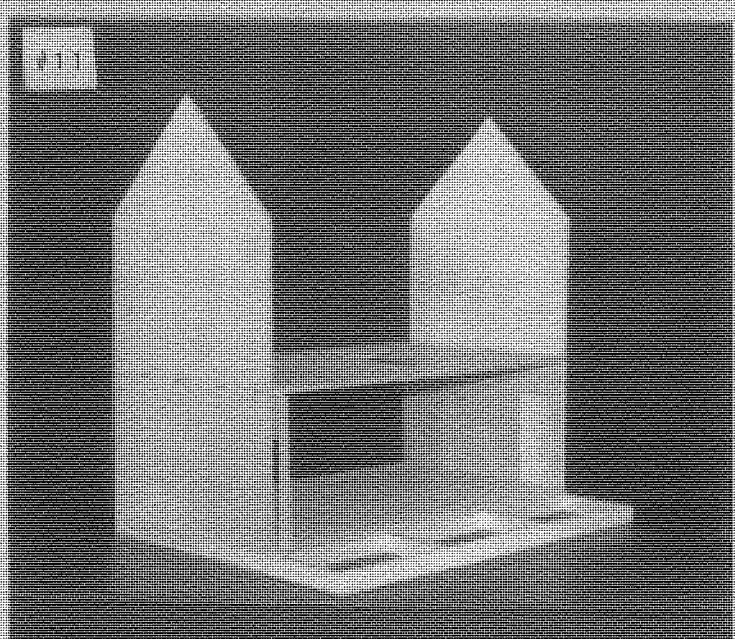
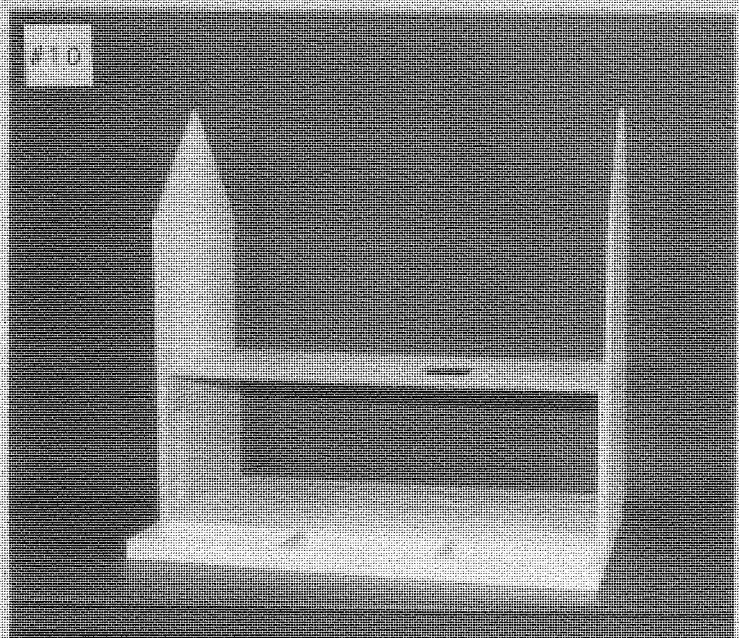
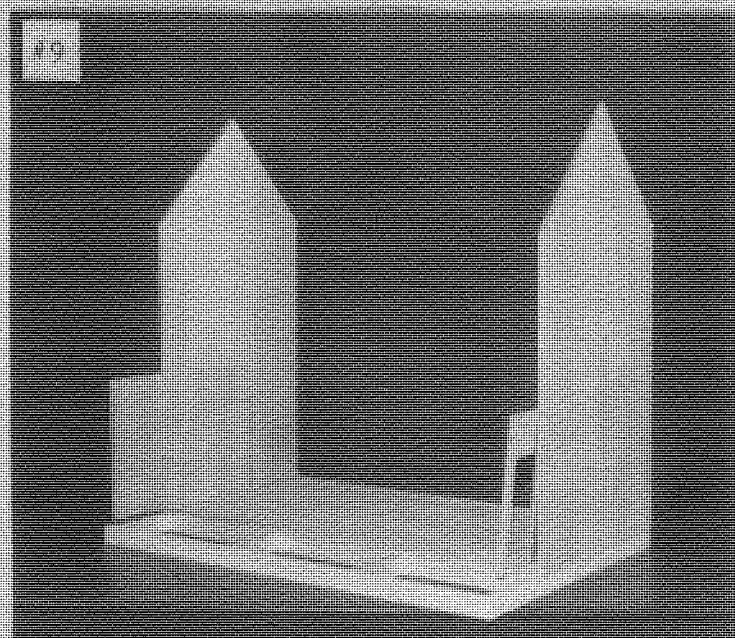
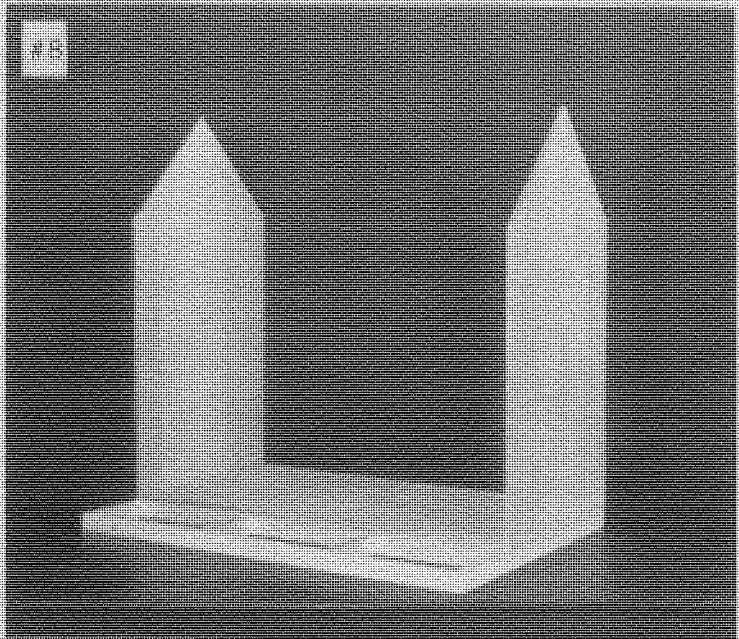
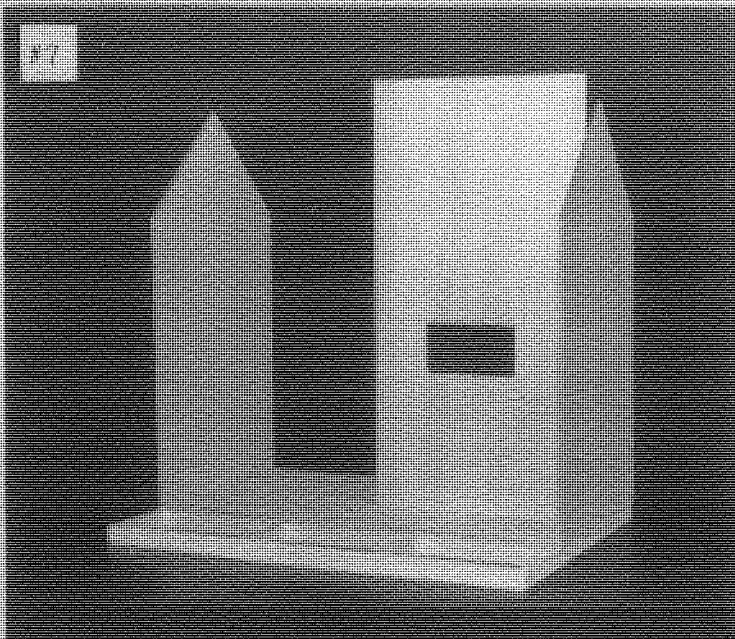

F13

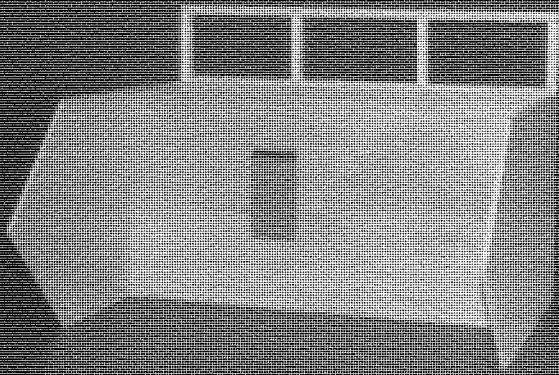

F14

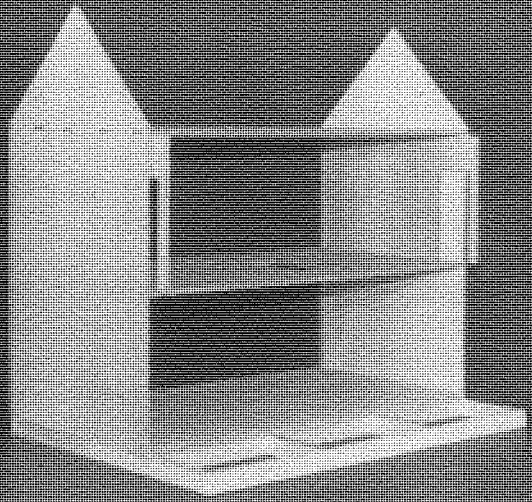

F15

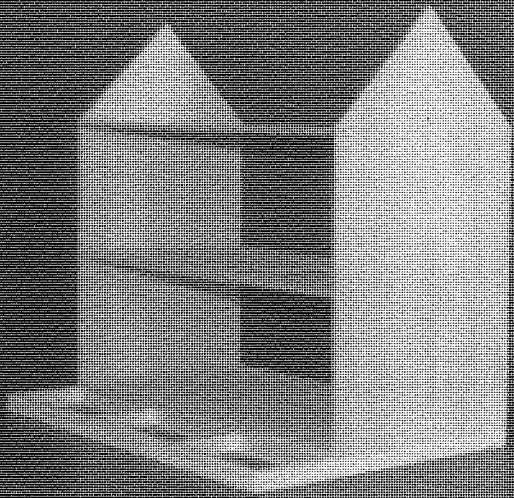

F16

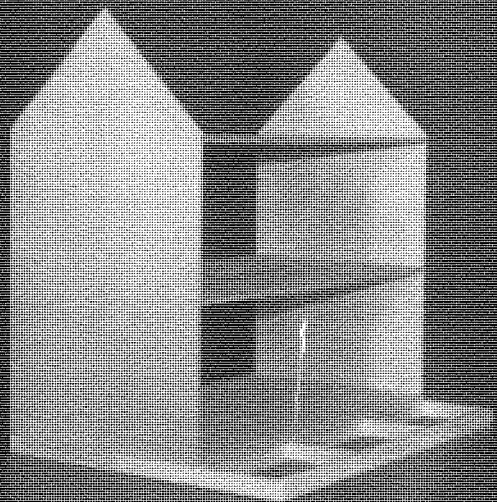

F17

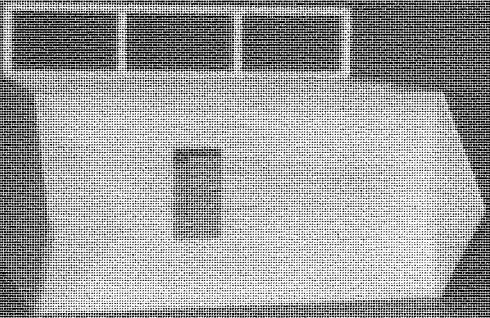

F18

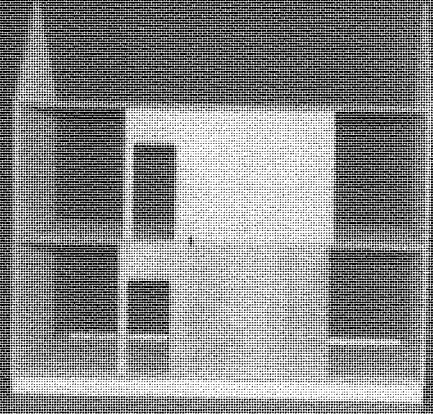

#19

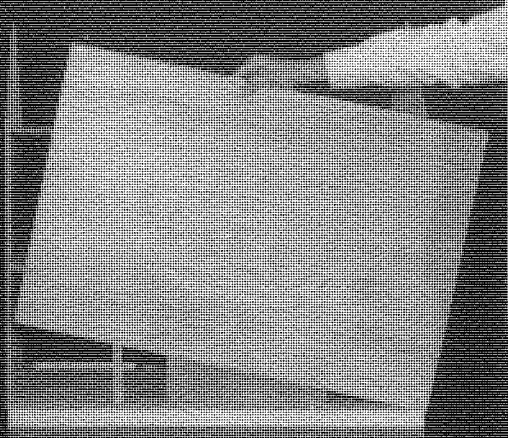

#20

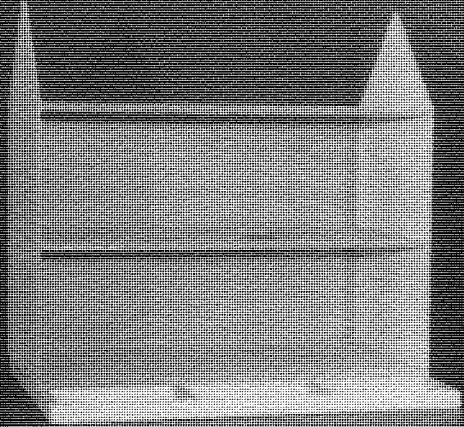

#21

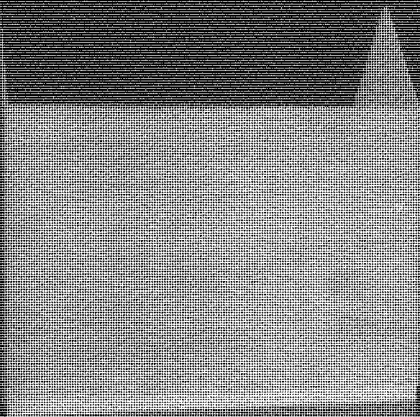

#22

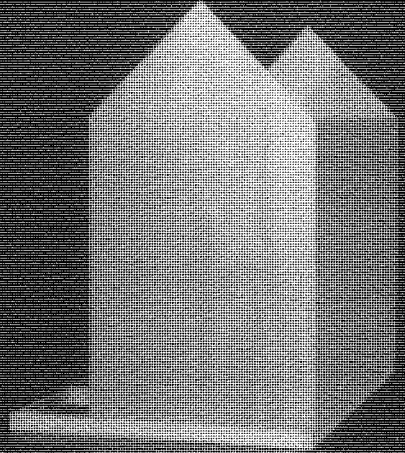

#23

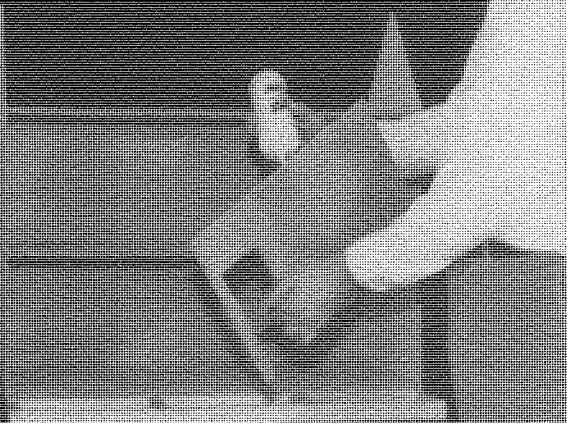

#24

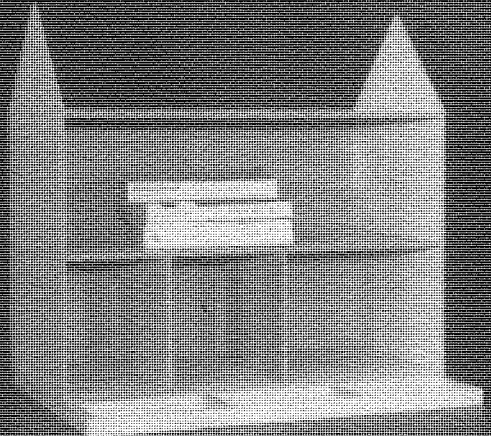

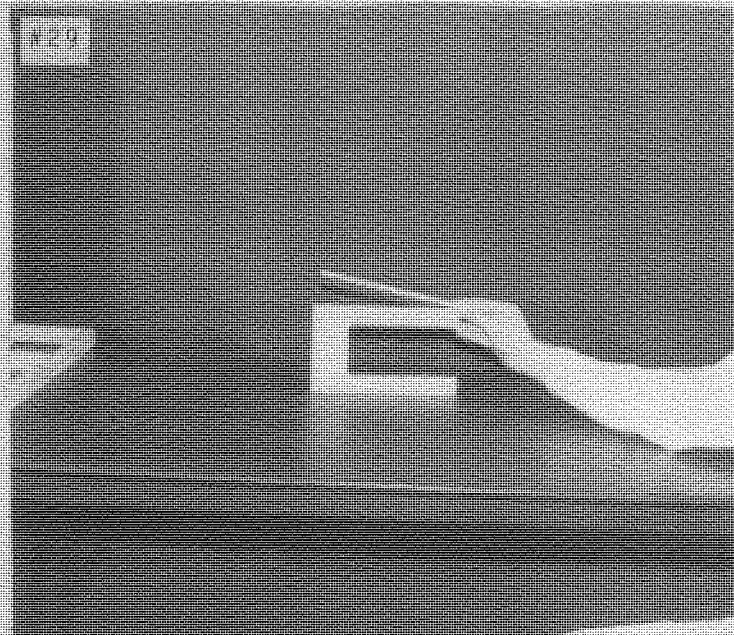
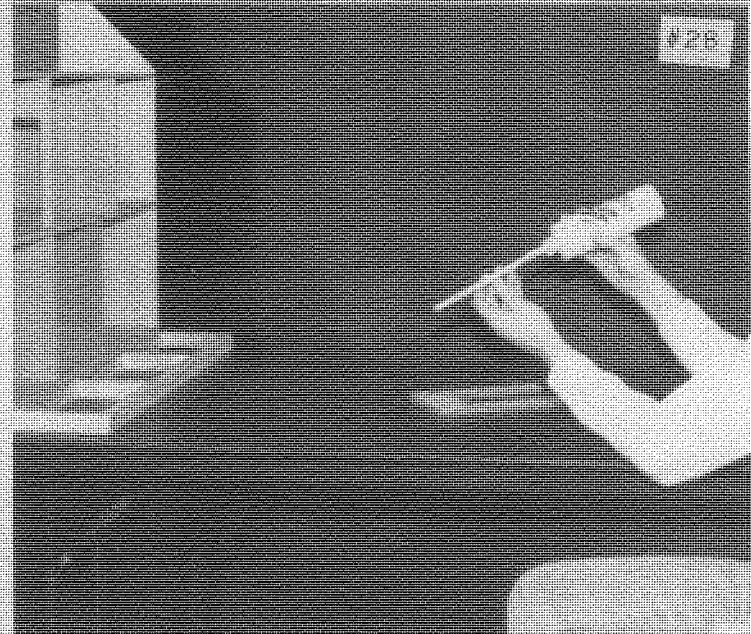
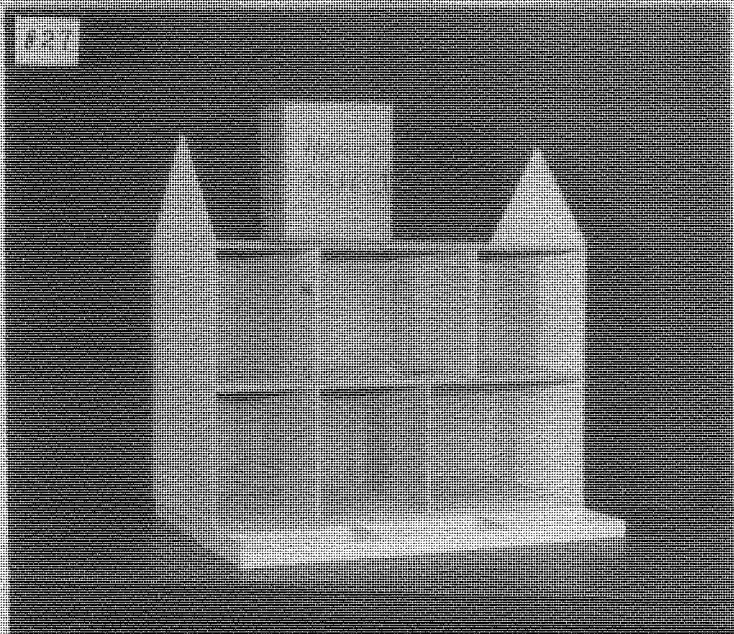
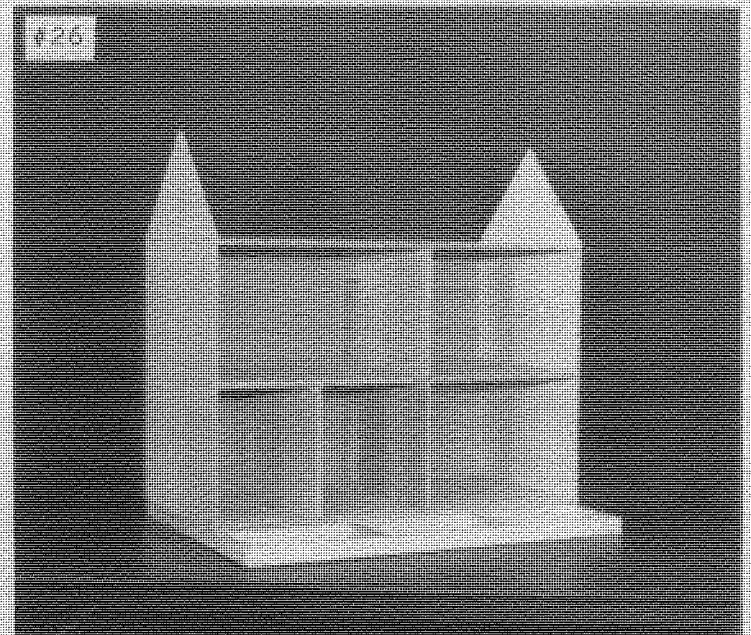
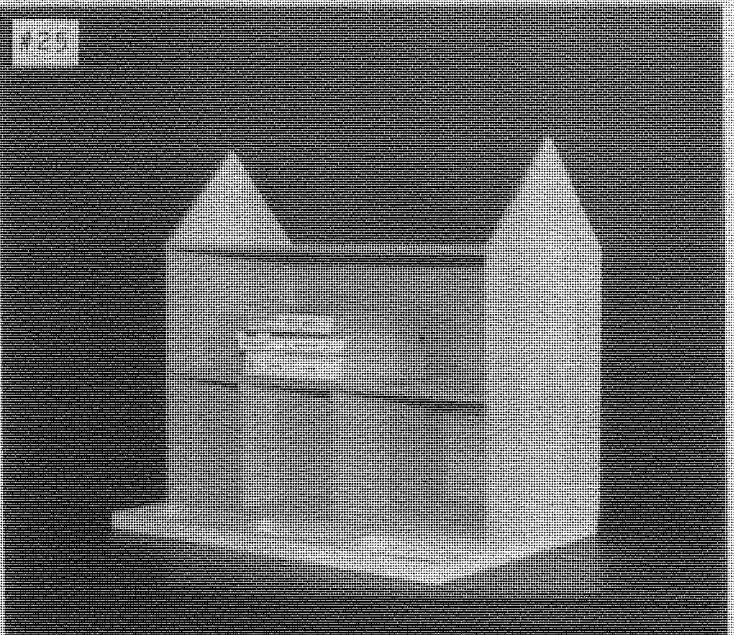

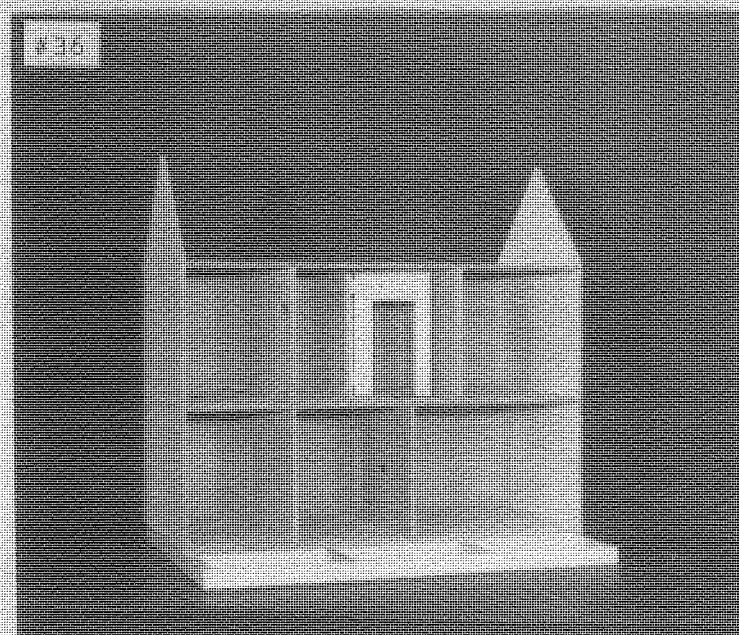
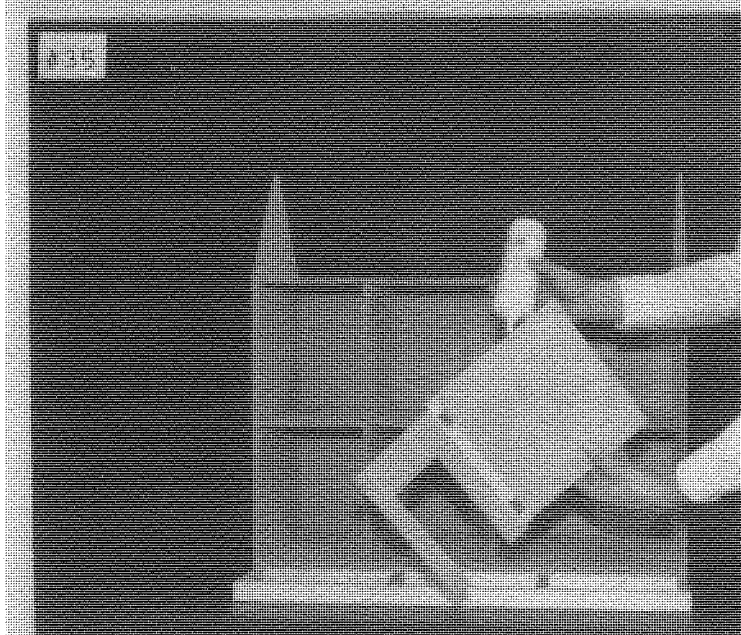
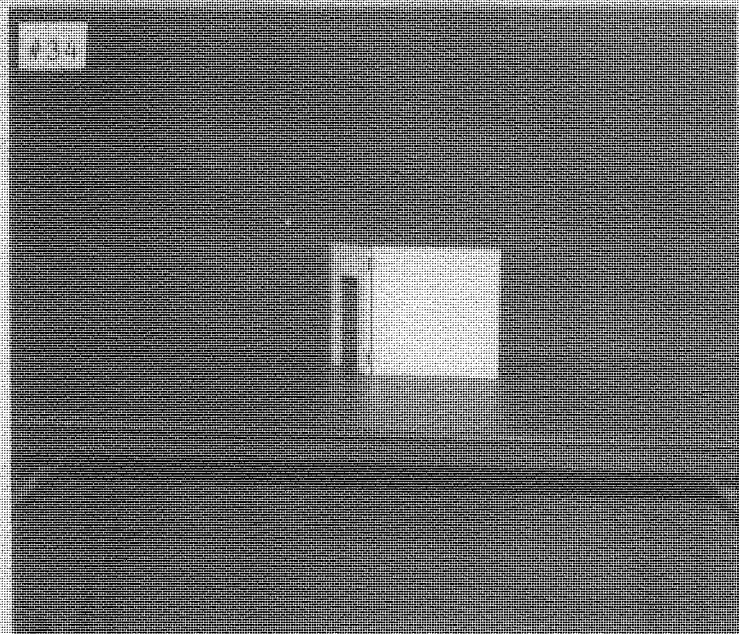
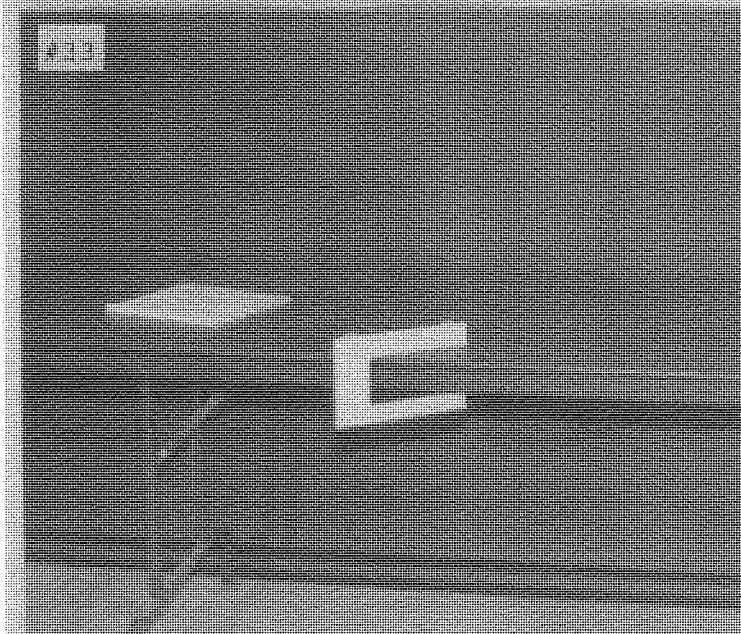

#37

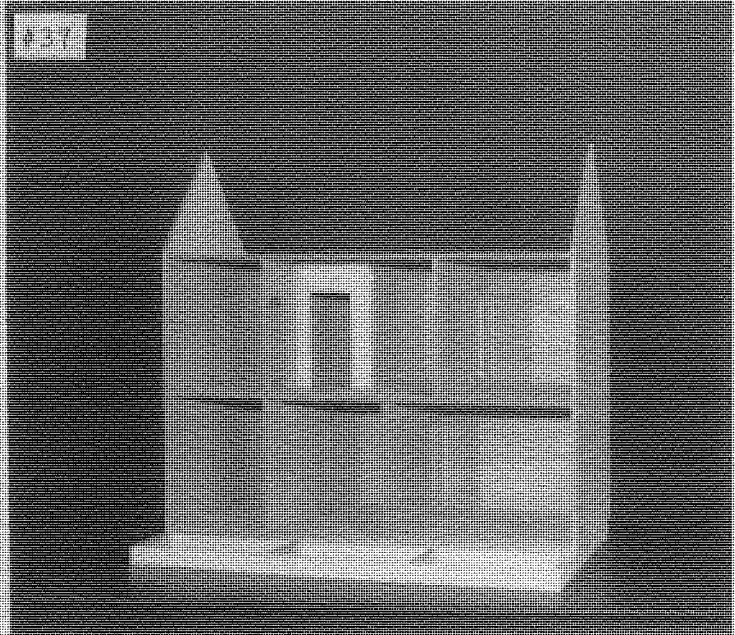

#38

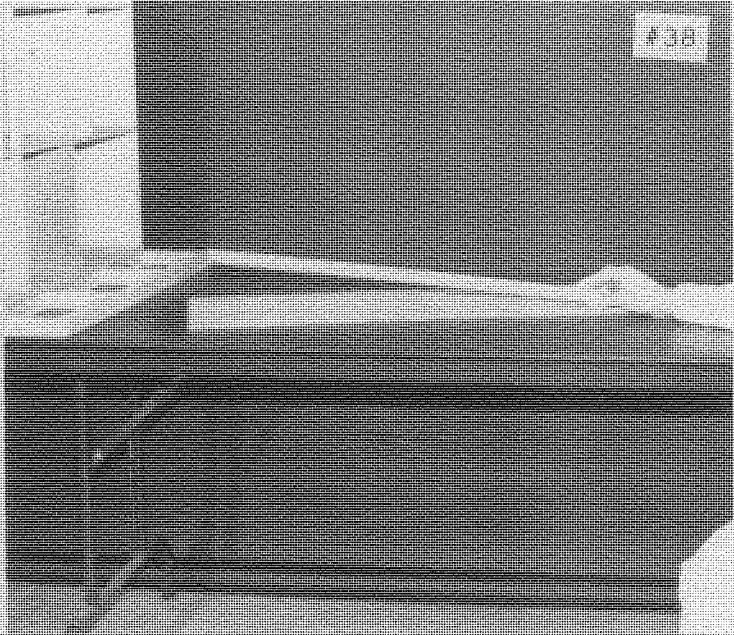

#39

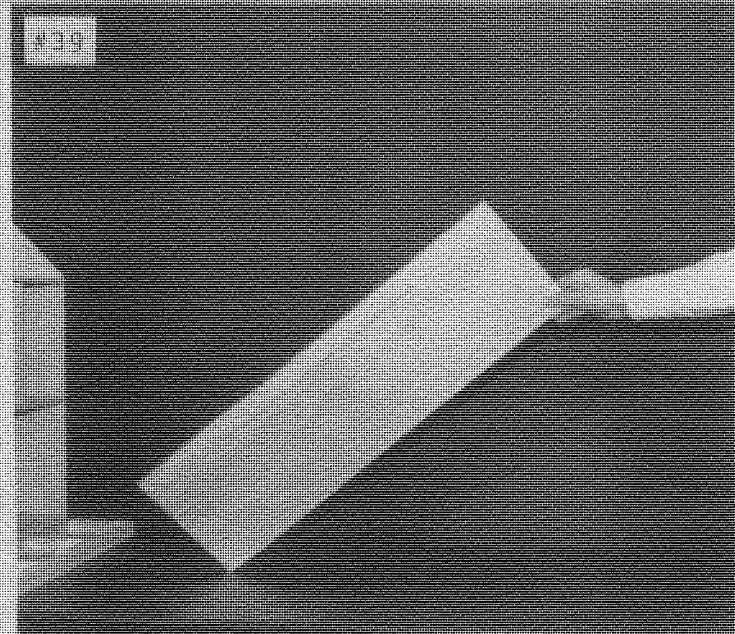

#40

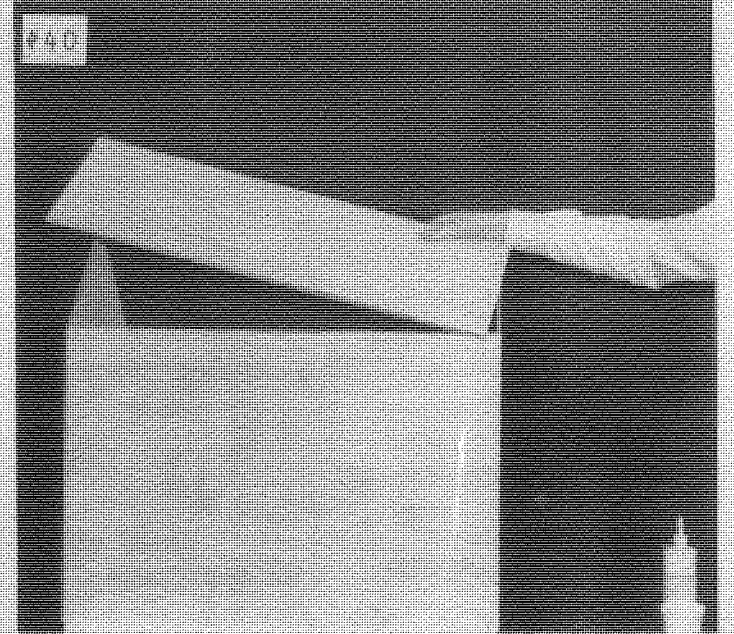

#41

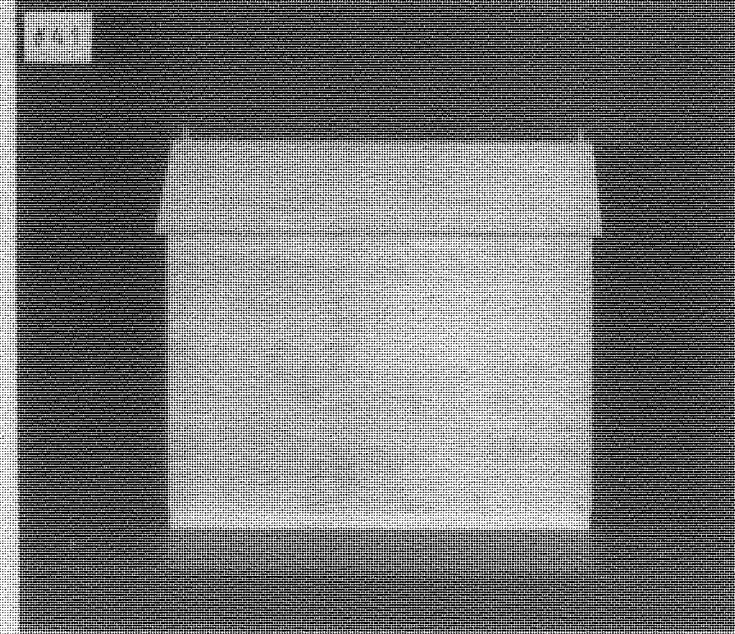

#42

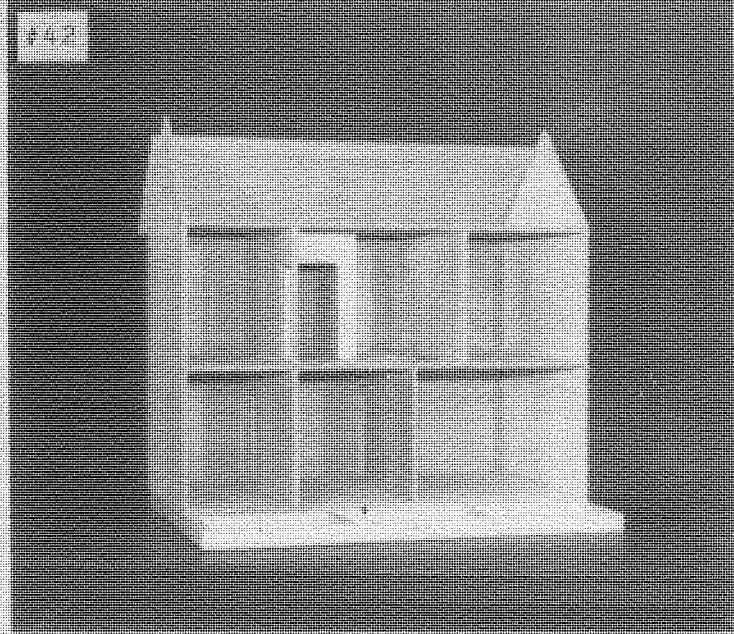

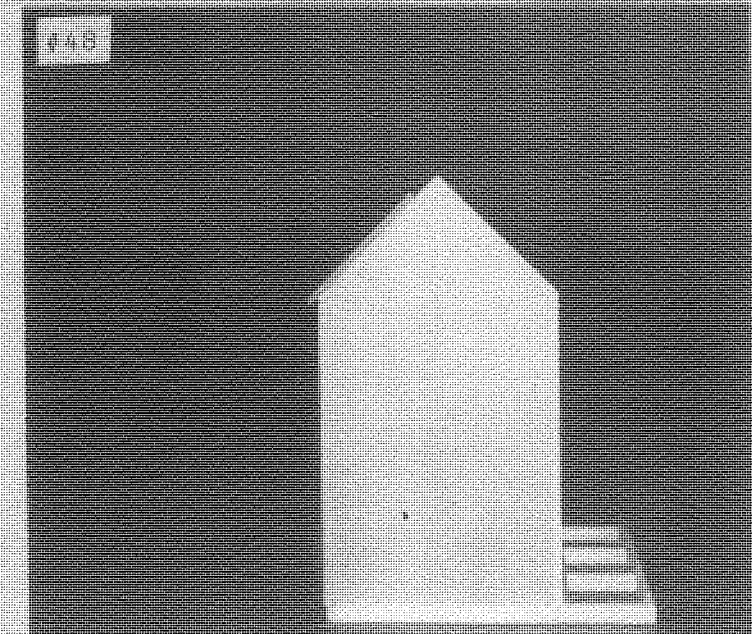
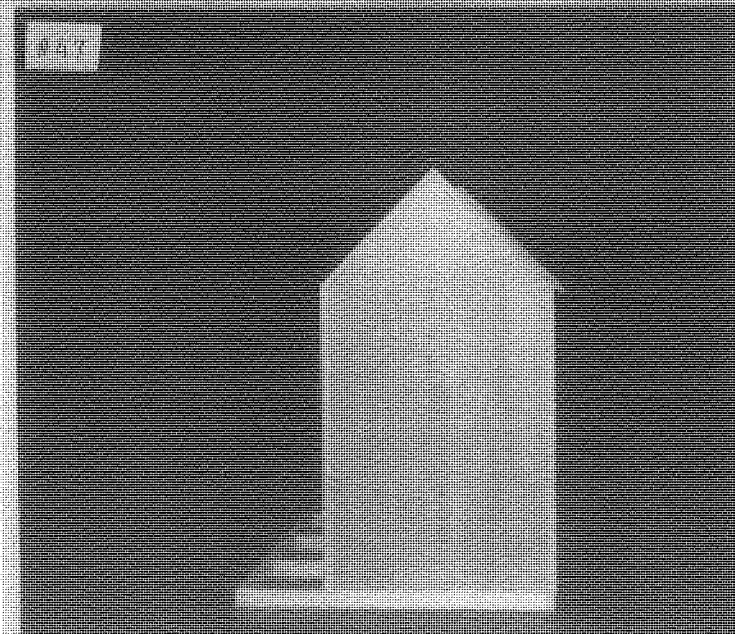
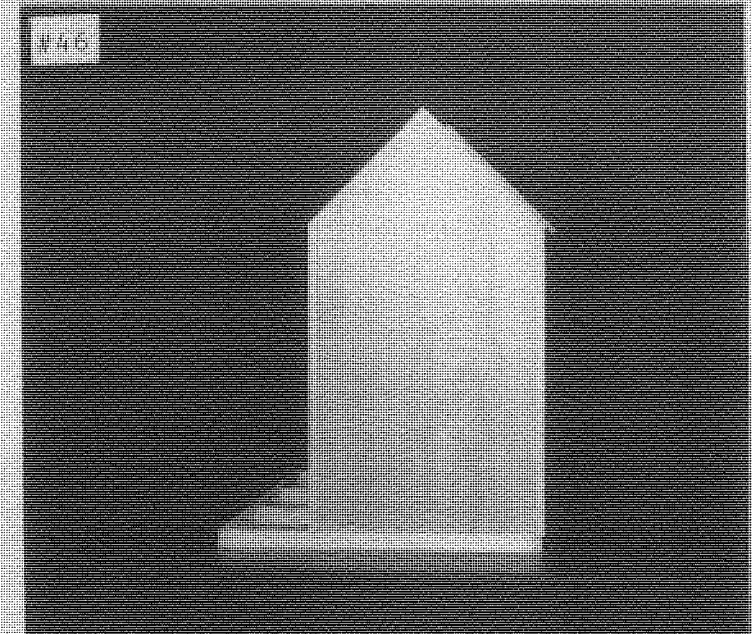
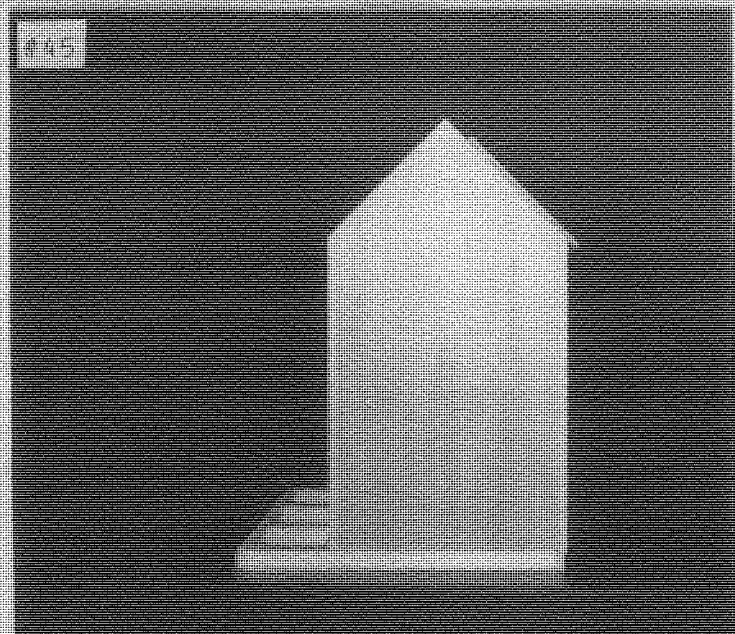
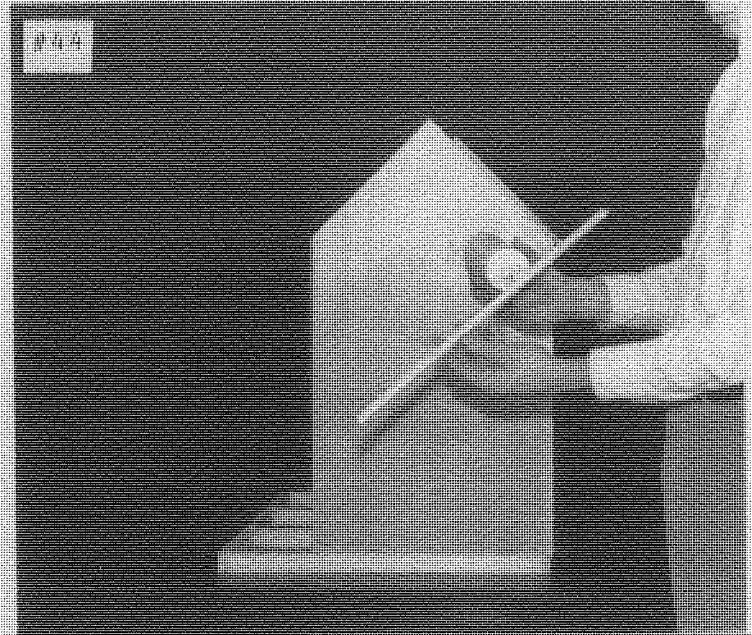
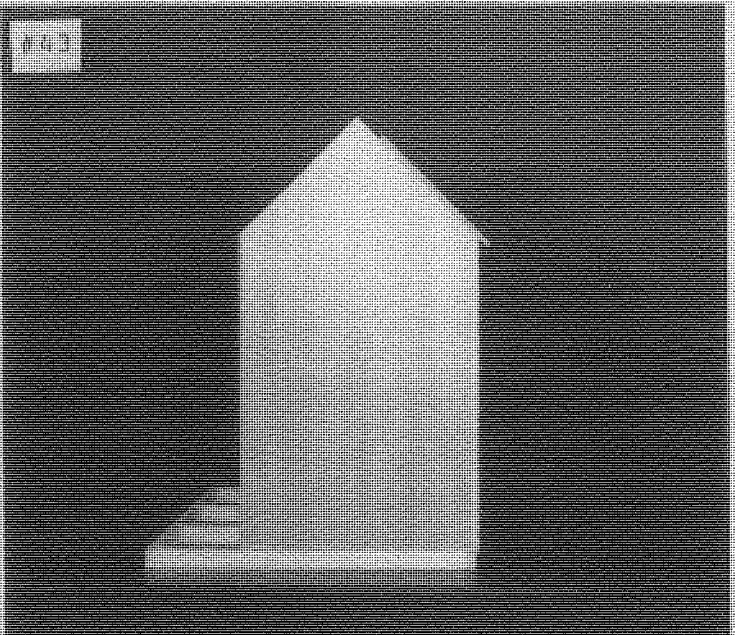

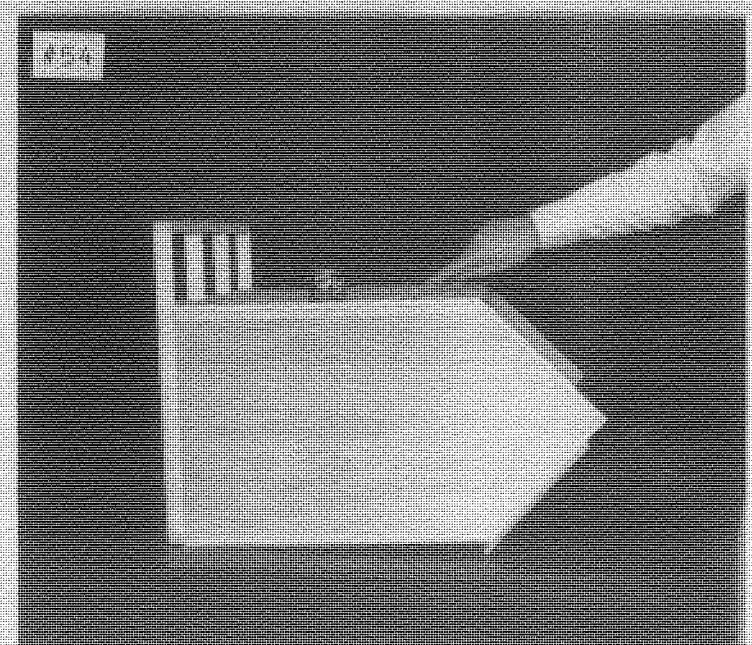
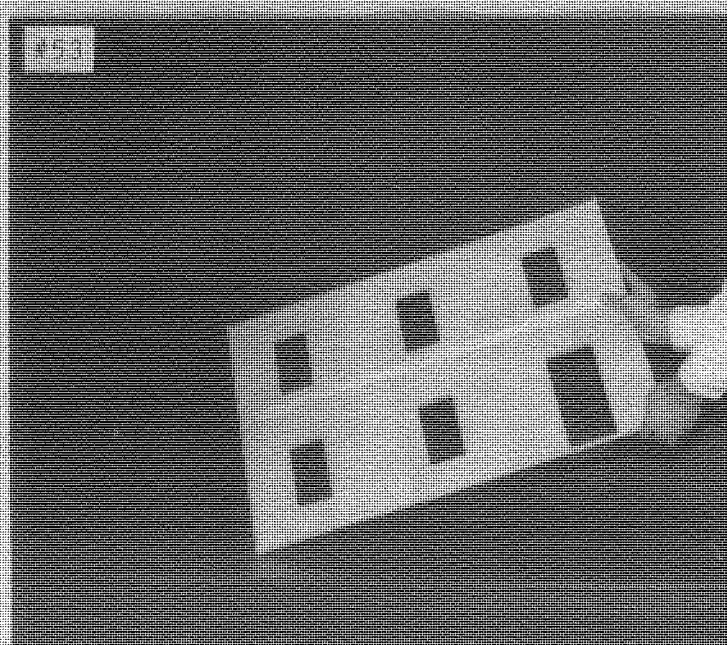
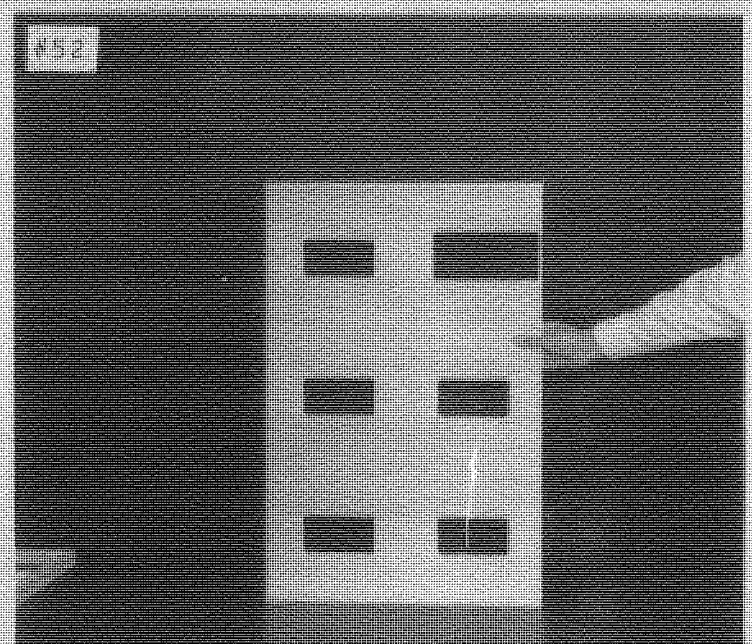
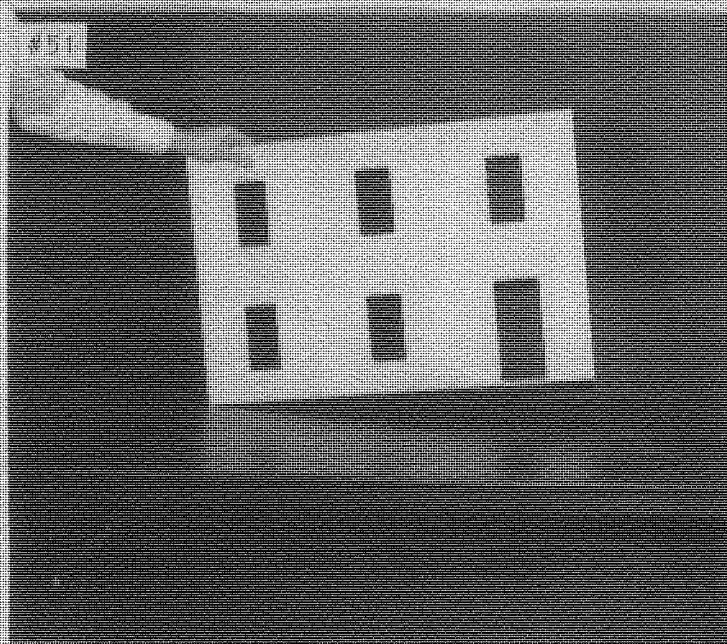
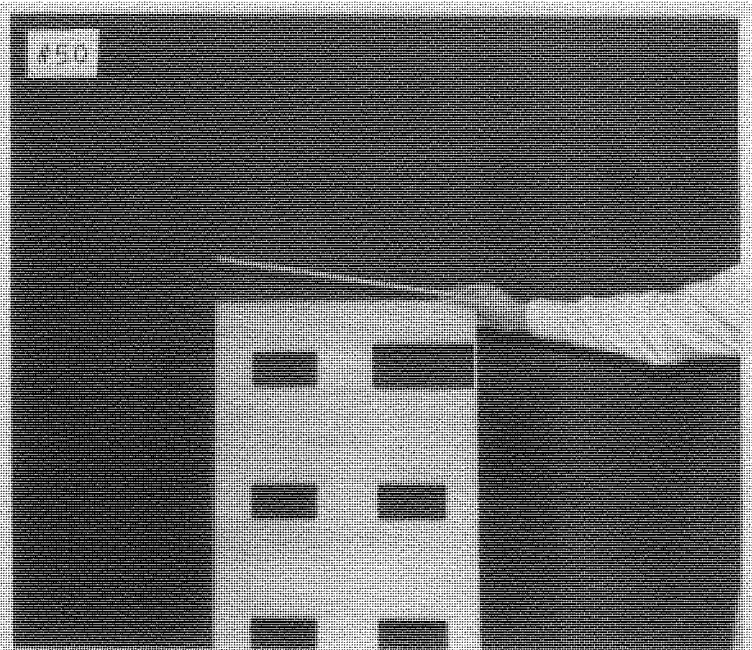
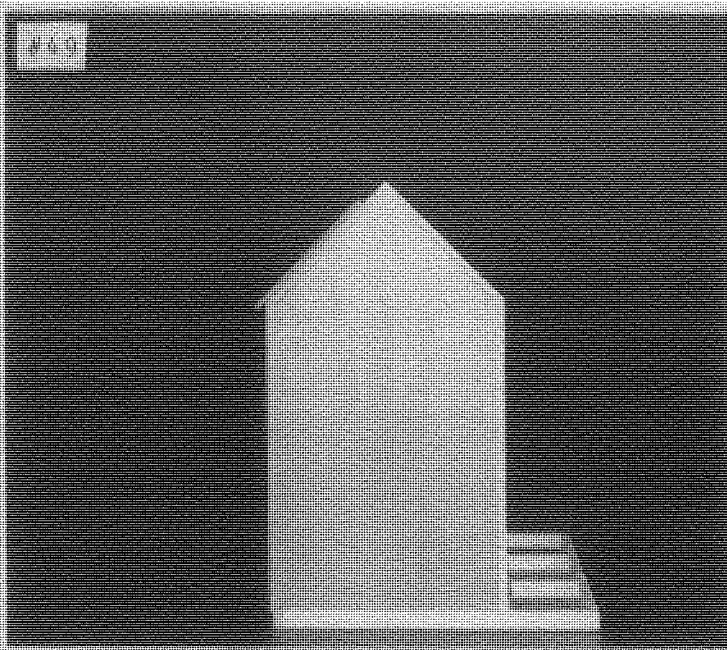



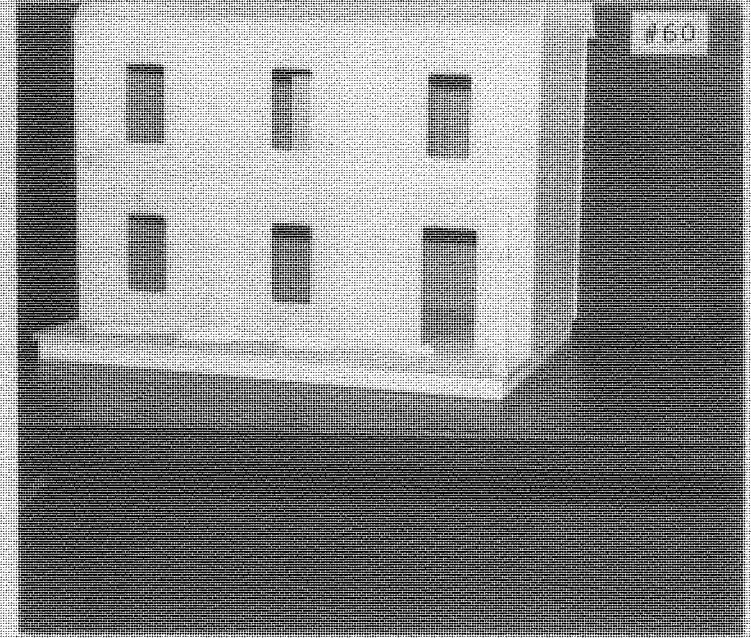
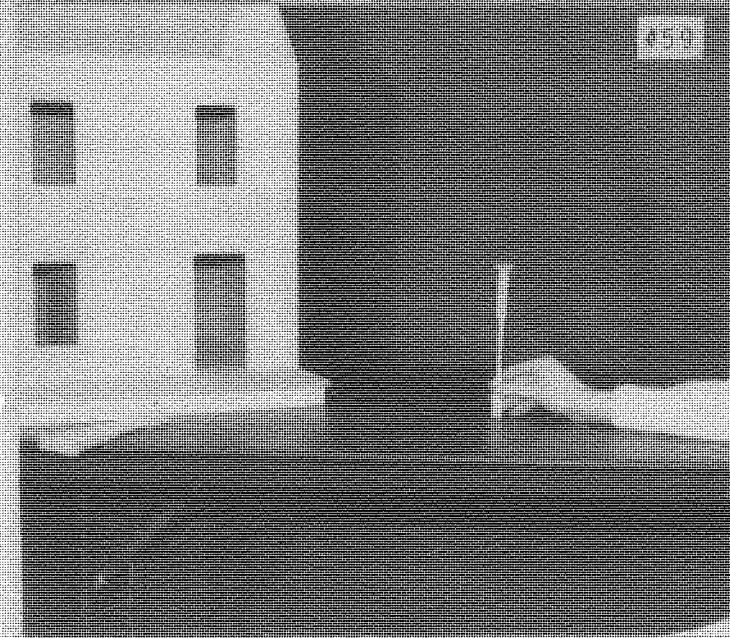
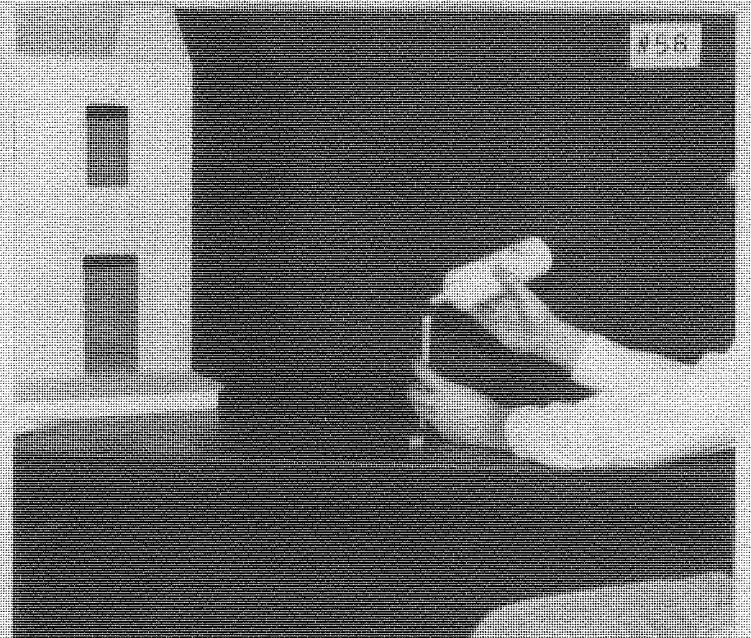
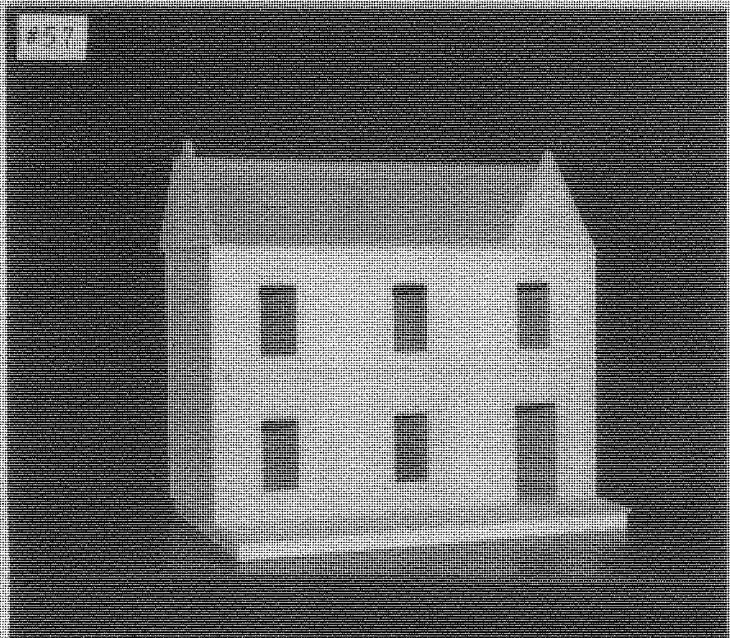
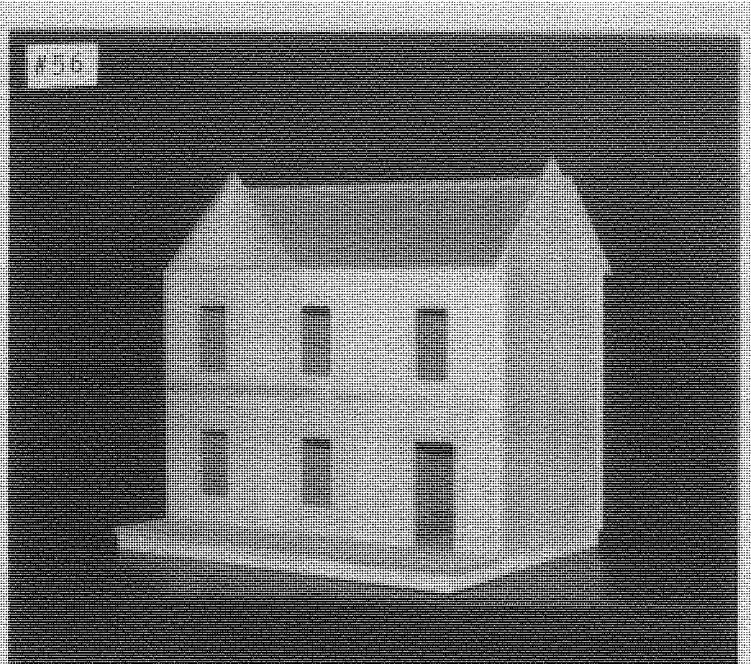
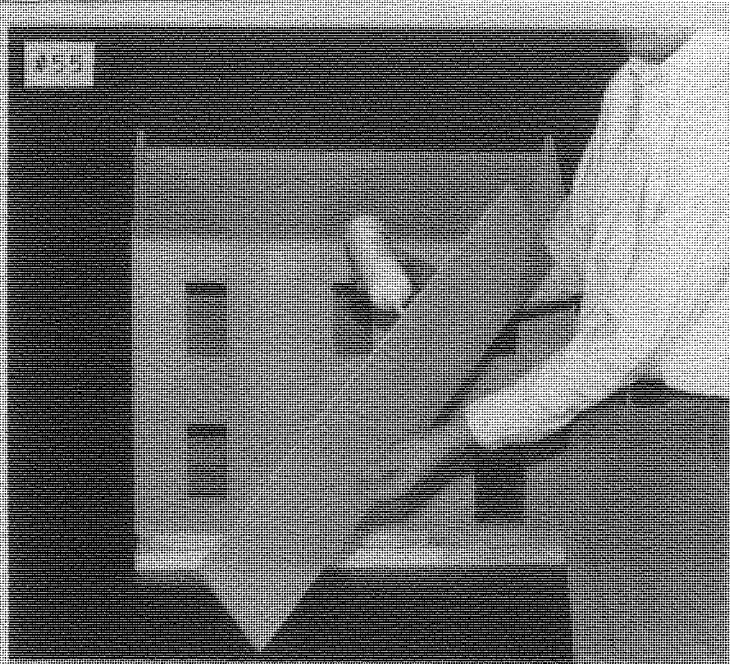

#61

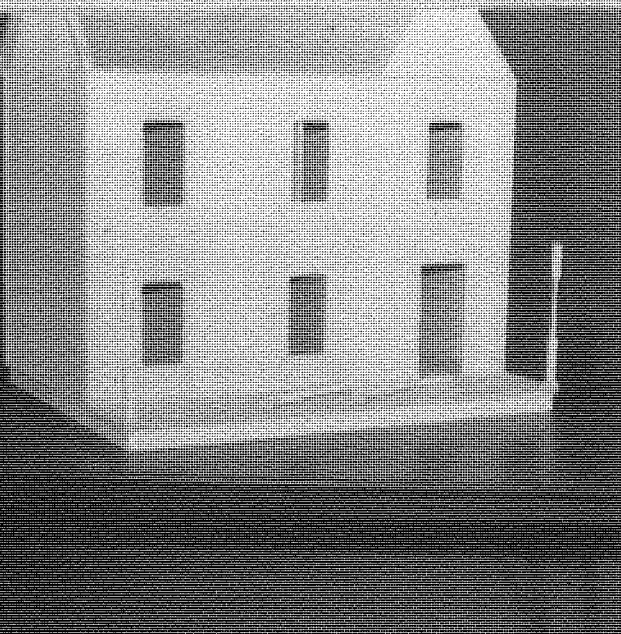

#62

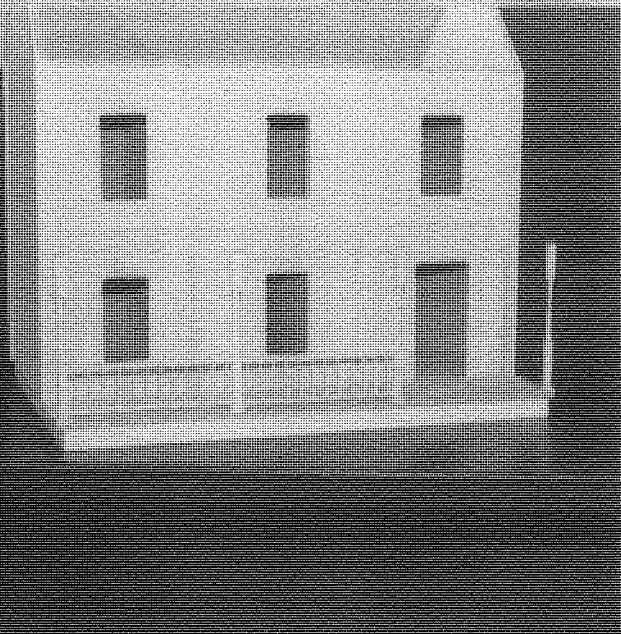

#63

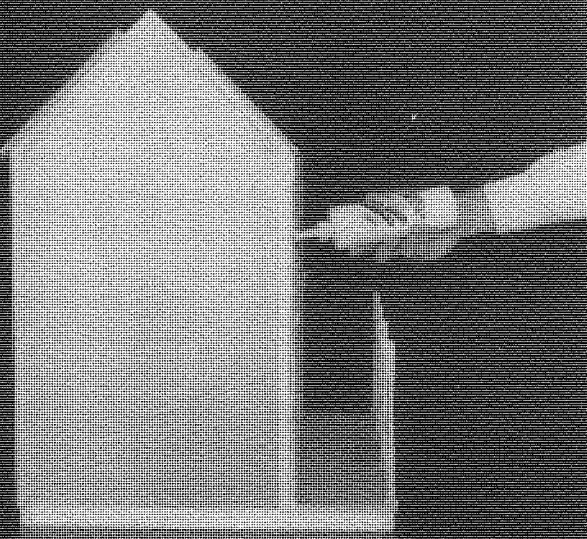

#64

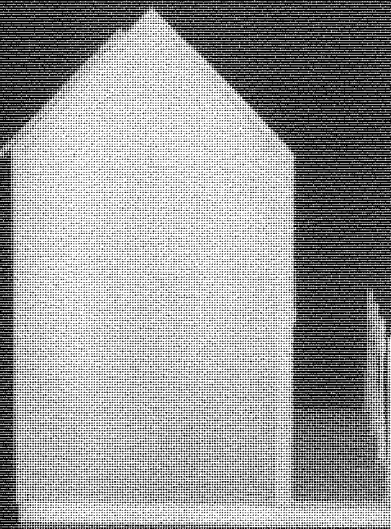

#65

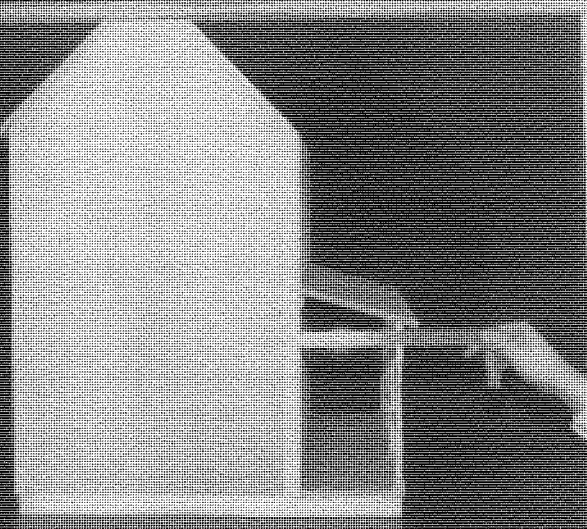

#66

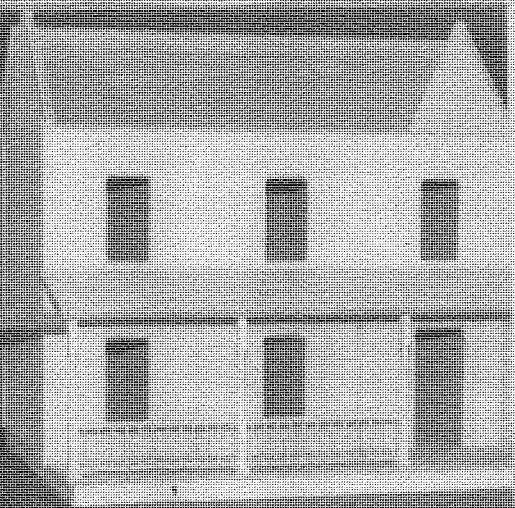

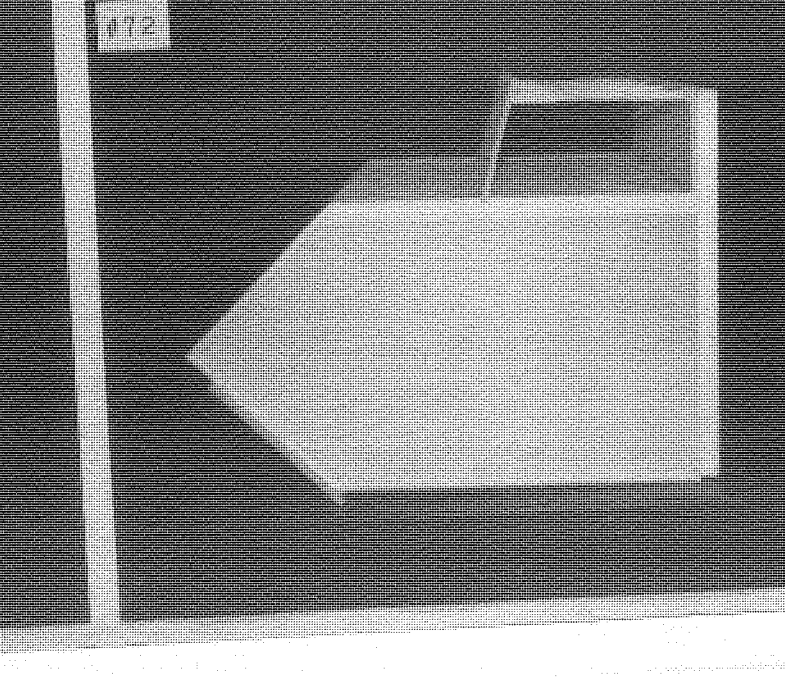
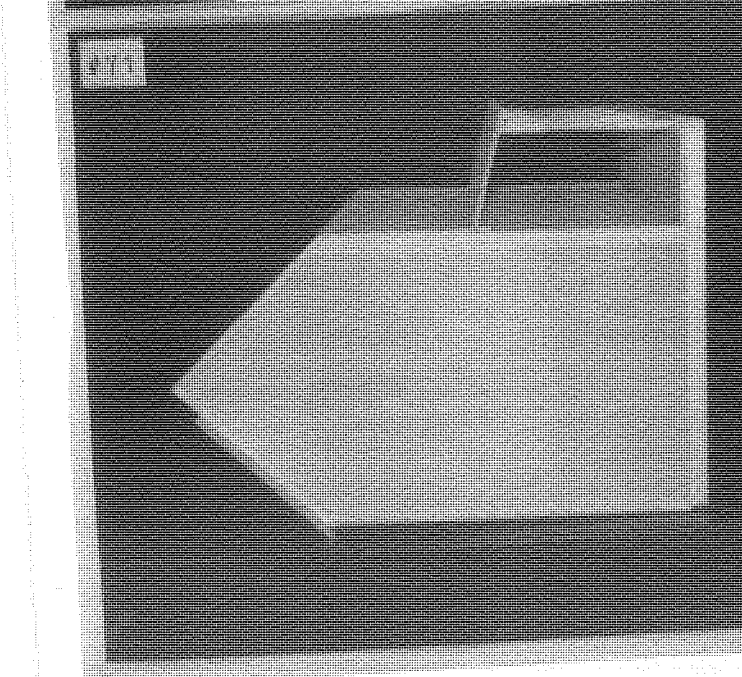
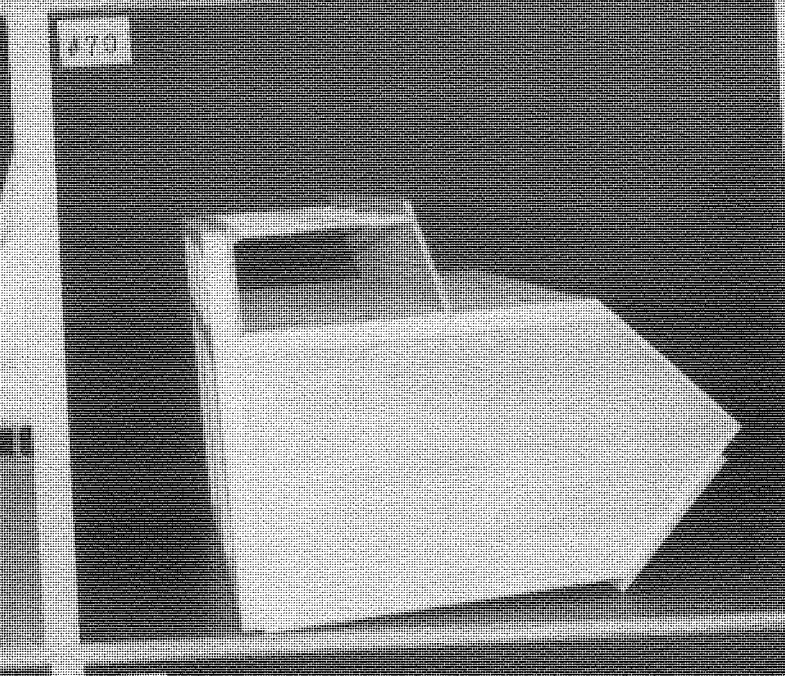
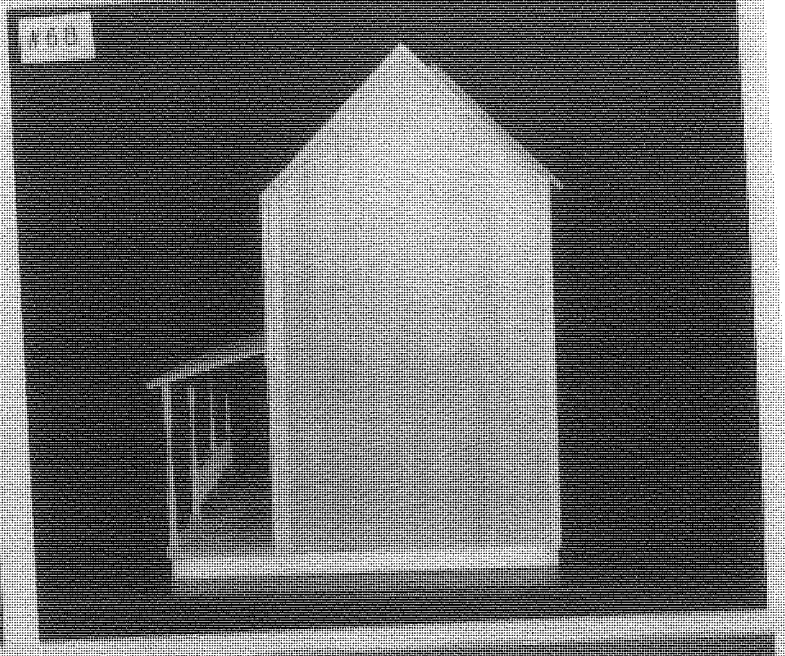
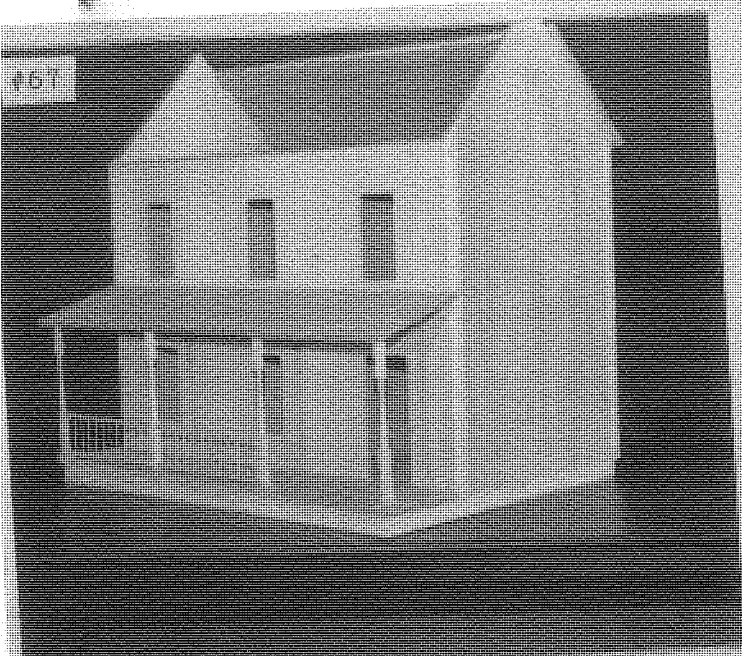

#73

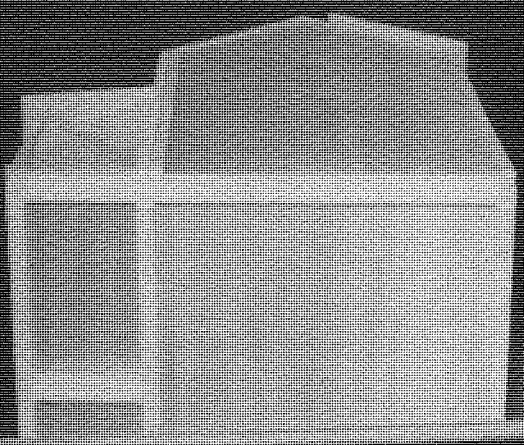

#74



#75

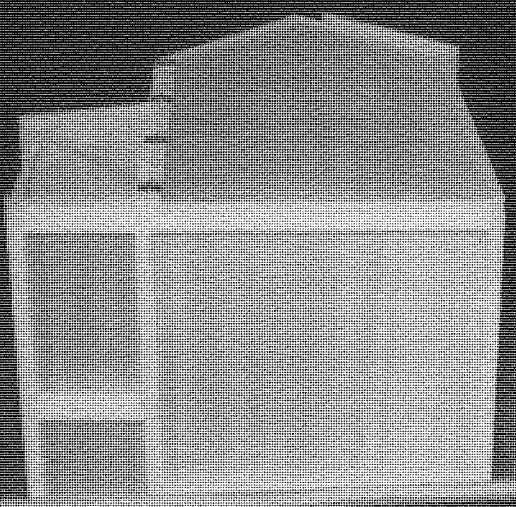

#76

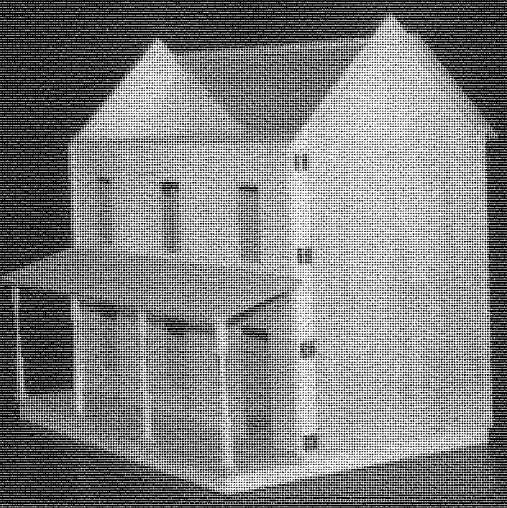

#77

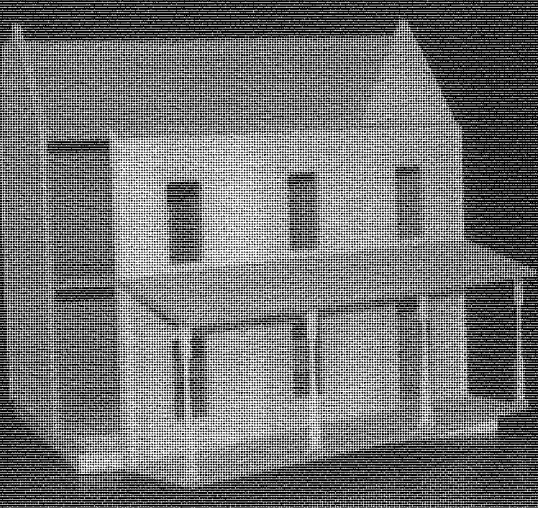

#78



#79



#80



#81

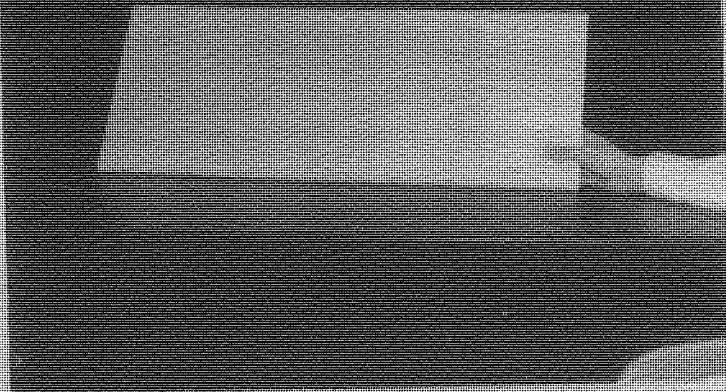

#82



#83

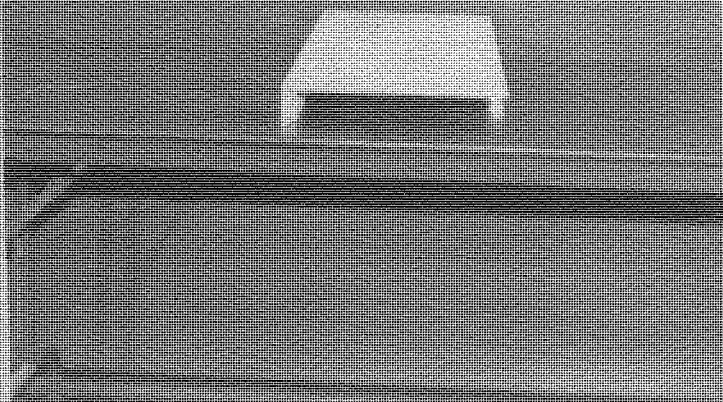

#84

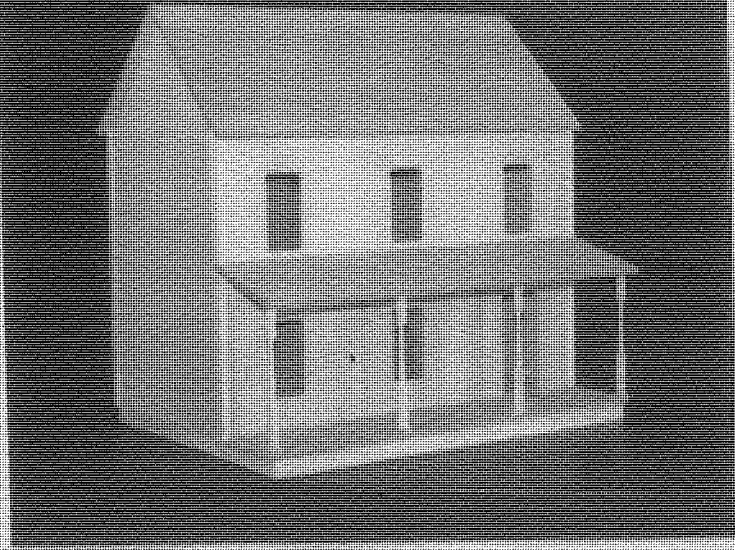

485

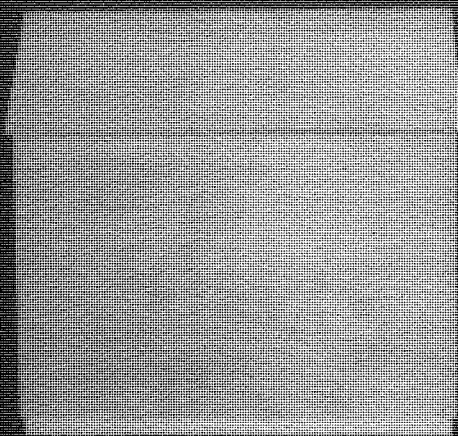

486

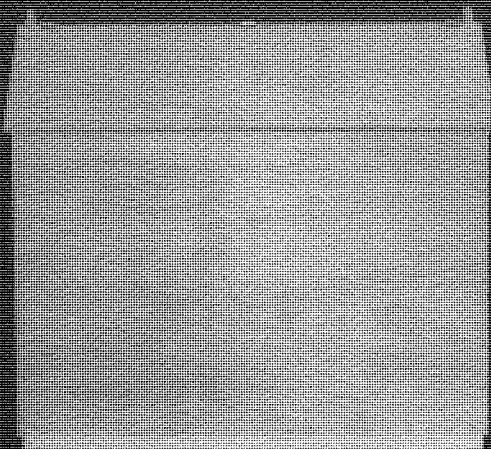

487

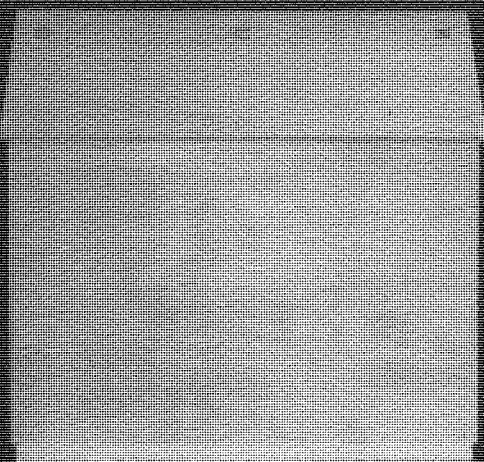

488

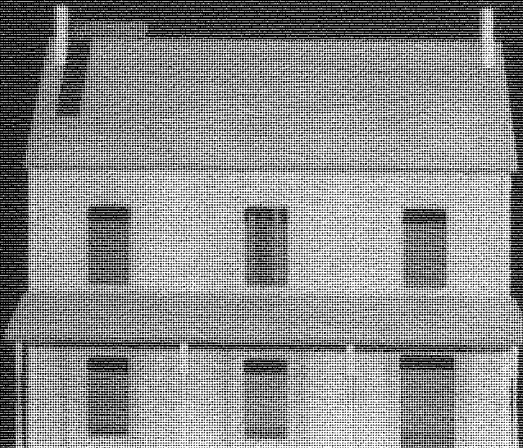

489

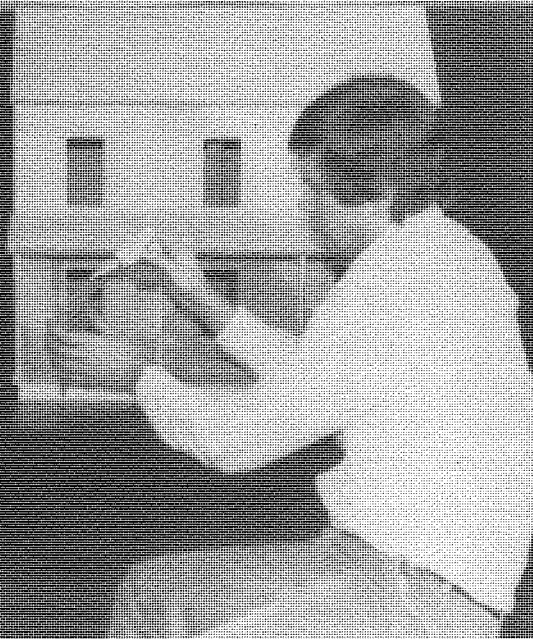

490

