

#529 OLD FIREHOUSE COLLECTOR KIT ADDENDUM

NOTE: The loose sub pack list dated 11-'94 supersedes that printed on page #3 of your instruction booklet. Use this revised list to accurately identify sub packs and individual kit parts.

PLAN AHEAD if you intend to install brick or siding to the exterior and/or wallpaper to the interior of your firehouse. These operations are most easily accomplished prior to the installation of windows, doors and interior trim. Also you will find it much easier to execute detailed painting of windows, doors and architectural accents before they are installed.

STEP #13 PAGE 9

Refer to the interior stair assembly instructions to assemble the two sets of interior stairs. Consider pre-finishing individual parts before assembly if contrasting colors and/or combinations of paint and stains will be used to finish the stairs.

STEP #17 PAGE 10

Your "new" SOPHISTIKIT FIREHOUSE has pre-assembled windows that install from the exterior of the house. The architectural trim to be installed at the top of the front (and under the top moulding) has been upgraded and includes decorative rosettes. The illustration below as a guide for its installation.



STEP #19 PAGE 10

The twist latch has been replaced with a magnetic catch which is to be installed under the second or third floors.

STEP #18 PAGE 10

The front door and the fire truck door have been upgraded. Both install from the exterior of the house.

THE OLD FIREHOUSE COLLECTOR KIT

by

Walmer Dollhouses
2100 Jefferson Davis Hwy.
Alexandria, Va. 22301
(703) 548-8804

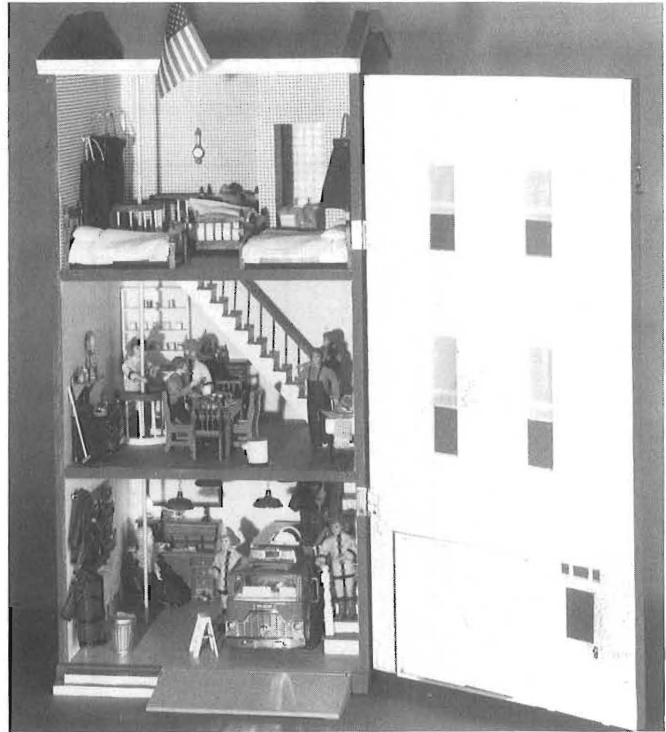
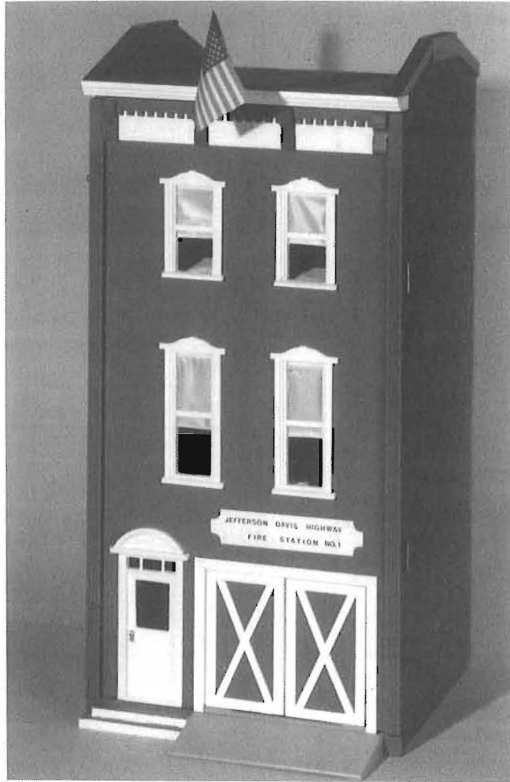

SQUARE is the key word in the assembly of the Old Firehouse.

WHERE is equally important. Be sure to use a level and flat surface for assembly. If you build it square on a level and flat surface, it will really be square. If you build it on an uneven surface, it will shift out of square whenever it is moved to another surface. This is especially true of such a tall and narrow structure.

Three Helpful Notes:

1. When nailing two small parts together, insert the nail almost through the first part before joining it with the second part. Then make the joint and nail through.
2. Paint small parts before assembly with larger parts of different color, e.g. brackets, dentil, window trim, pane divider, etc.
3. In the assembly of this dollhouse it is most important that the holes for the fireman's pole to be aligned vertically. To help with this we have put a black mark on the FRONT edges of all the floors.

MAJOR PARTS

OLD FIREHOUSE

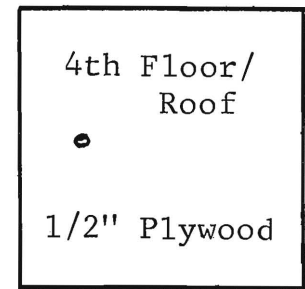
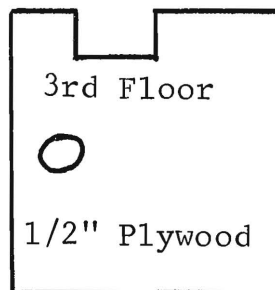
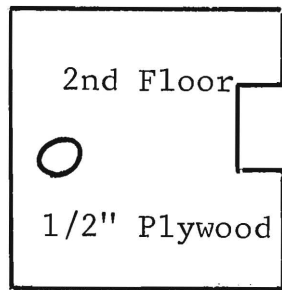
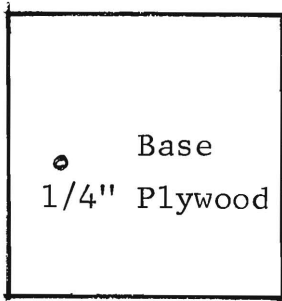
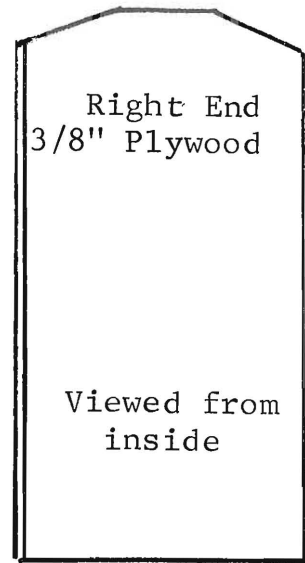
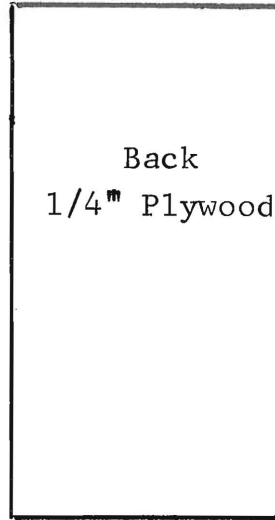
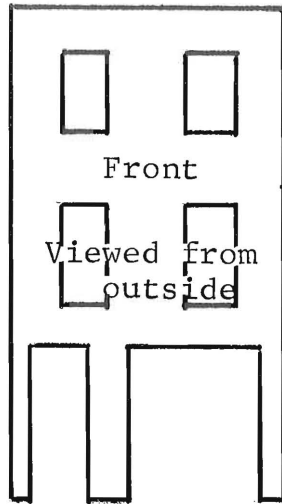
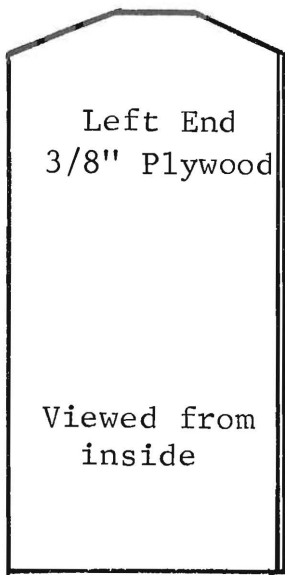

AUXILIARY PARTS

Partitions
both 10" High

Underframe

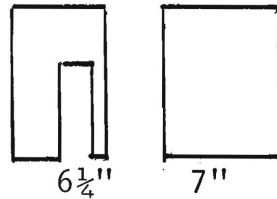
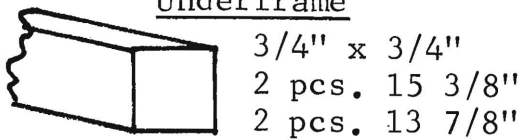

Top Molding

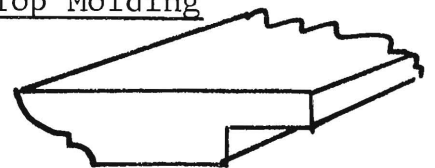

Front Sill

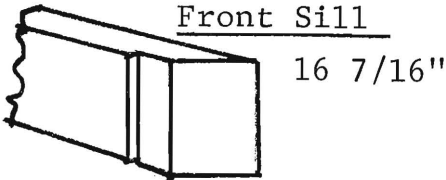

PLUS:

- Interior Stairs (2)
- Landing Rails (2)
- Firepole Rails (2)
- Firepole 1/2" Dia. Dowel
- Long Interior Windows (2)
- Short Interior Windows (2)
- People Door (1)
- Firetruck Door (1)
- Firestation Sign (1)

Stancions

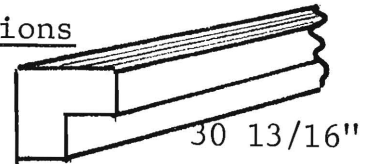

L-Strips

31 7/8"

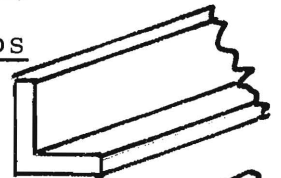

Front Steps



Floor Facing



Window Pane Divider



Firetruck Ramp

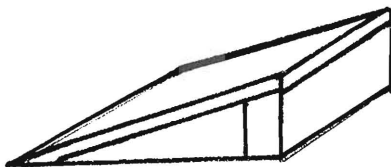

LIST OF SUB-PARTS

OLD FIREHOUSE

Front Trim

Top Facing Board
4 pcs. Large Brackets
3 Pcs. Dentil Molding
4 Pcs. Window Lintel
4 Pcs. Window Sill
4 Pcs. Window Under-sill
4 Pcs. Long Window Side Frame
4 Pcs. Short Window Side Frame
1 Pc. Door Lintel
1 Pc. Door Hood
1 Pc. Twist Latch

Firewall Cap

2 Pcs. Front
2 Pcs. Center
2 Pcs. Rear
2 Pcs. Chimney Cap

Firetruck Ramp

1 Pc. 1/4" Plywood (beveled)
1 Pc. Ramp Beam
2 Pcs. Ramp Wedges

Hardware

2 Pcs. Hinges
8 Pcs. Screws 1/2" x #4
1 Pc. Screw 5/8" x #6
26 Nails 3/4"
6 Nails 1"
16 Nails 1 1/4"

SEQUENTIAL ASSEMBLY INSTRUCTIONS

for the

OLD FIREHOUSE

Tools & Supplies

Needed: Square, small saw or mat knife, tape measure, hammer, small screwdriver, masking (or scotch) tape, sandpaper, white (or carpenters) glue, drill with 3/32" bit, several squeeze clamps or C-clamps.

1. SANDPAPERING

Extensive sand papering is not required since almost all edges of the plywood are covered with molding, corners, or facings. Sandpaper only to the extent necessary to remove frayed wood that would inhibit good fits of the parts during assembly.

Note: The better side of the plywood (the smoother and tighter grained side) should be selected to become the sides which are painted and/or exposed.

2. INSTALLATION OF UNDERFRAME ONTO THE BASE

Be sure the base is 1/4" thick (not 1/2").

Select the better side of the plywood - the smoother and closer grained side - place it down with the hole for the firemen's pole located as shown. Then glue the parts of the underframe to each other and to the base flush to the outer edges of the plywood. Apply weight (books maybe) to assure solid glue joints. Allow 20 minutes for glue to set.

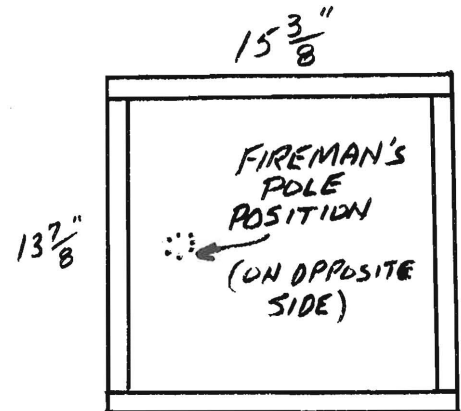

3. SUB-ASSEMBLY OF CORNER STANCIONS ONTO FRONT

The left and right stancions are not identical. Orient them so that the flat space beyond the grooved cut is at the top. Then glue and clamp the notches in the stancions onto the edges of the front as shown. BE SURE THE DOOR is on a flat surface while glue is drying. The door can adopt a warp or twist if the glue dries in a non-level position.

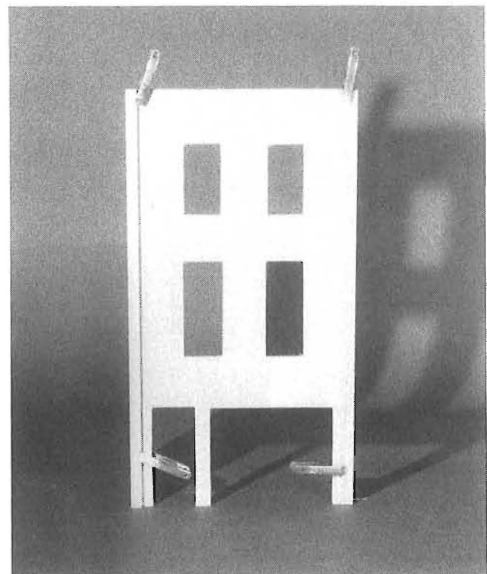

4.

4. SUBASSEMBLY OF TOP MOLDING ONTO 4th FLOOR/ROOF

Glue the joint as shown, flush at each end. Clamp (or weight) until set. Be sure to have the black mark on the floor to the front.



5. ESTABLISH THE LEVEL OF THE 4th FLOOR/ROOF

This step is important to be done early in the procedure to assure proper vertical space for the Front and numerous other parts.

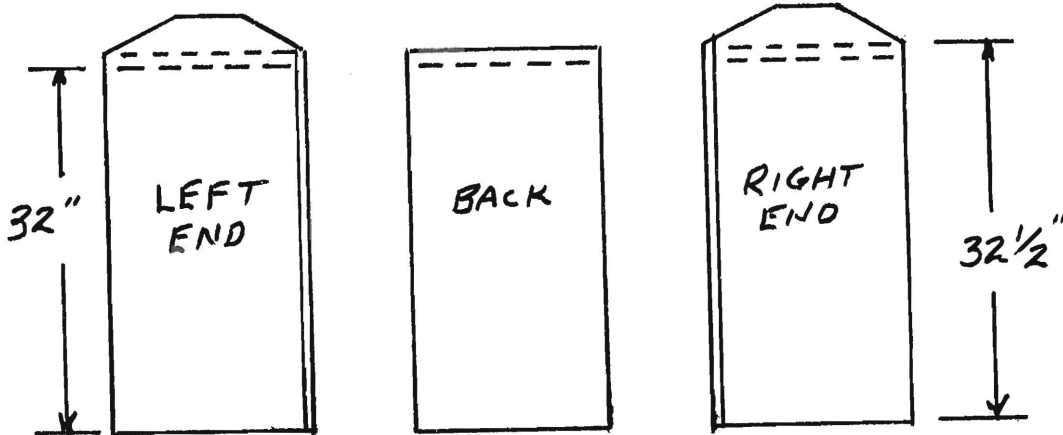

Draw lines (shown dotted) up 32" and 32½" from the bottom edge of the back and ends. This will make the top surface of the roof flush with the top edge of the back. When the 4th Floor/Roof is installed later, it must be located between these lines.

NOTE: An extra pair of helping hands are useful in Steps #6 and #7 to hold parts steady and firmly in place while nailing.

6. INSTALLATION OF BACK ONTO BASE (3/4" nails)

The hole for the Firemen's Pole cannot be seen from this angle - but is shown dotted where it must be (on the right).

Start three nails 1/2" up from the lower edge of the back. Set the base on edge and apply glue to the underframe. Then using the 2nd and 3rd floors for support as shown, adjust the back to overhang each edge equally (3/16") and be flush with the bottom edge of the underframe (VERY IMPORTANT FOR SQUARENESS). Holding everything firmly in place, drive the nails half way. Recheck for even overhang and flush at the bottom edge, then drive nails all the way.

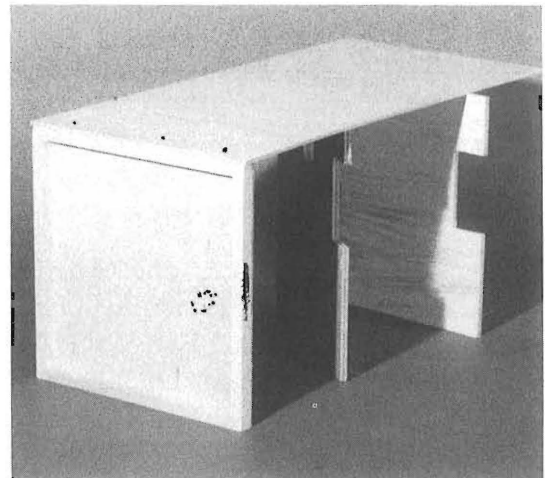

7. INSTALLATION OF ENDS ONTO BASE AND BACK (Use 3/4" nails)

Slip the left end into position as shown - so that the overhang of the back engages the rabbeted notch in the end. Glue the mating surfaces and nail thru the back into the end. Nail at a slight angle so the nail goes to the center of the 3/8" thick end. Being sure all mating edges are flush, check for square and nail the bottom edge of the end to the underframe of the base. Repeat to install the right end.

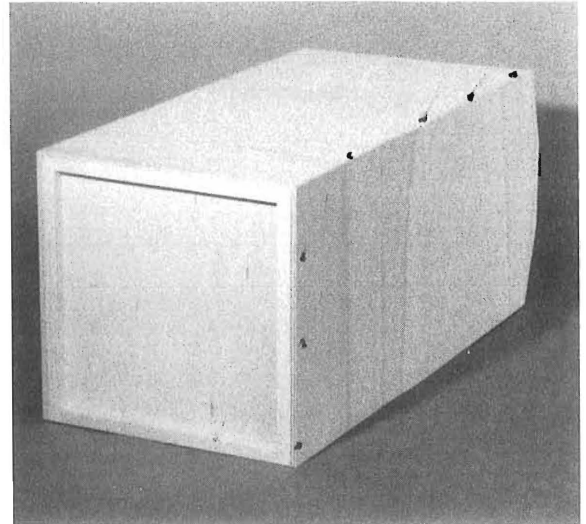

8. INSTALLATION OF FLOORS/ROOF

NOTE: Observe carefully the orientation and dimensions of the 2nd, 3rd, and 4th floor/roof.

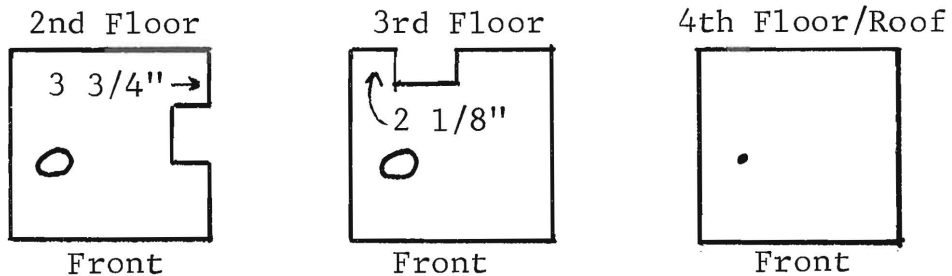

With the structure set up as shown, measure and make marks on both ends and back as shown to establish the levels for nailing as each floor is installed. To install the 2nd floor, use the two partitions (10" high) as shown to establish the level of the 2nd floor.

Square Check

With the ends snug tight against the 2nd floor, check for square between the base and ends. This is the most important square-check. If necessary, use some force to flex the structure to become as square as possible. At this point, the structure is sufficiently flexible to shift into square position.

Apply glue to the mating edges of the floor and, with the stairwell against the right wall, and the pole hole to the left, directly over the hole in the base, hold the ends square and nail through the ends and back into the 2nd floor. (Avoid nailing into the stairwell).

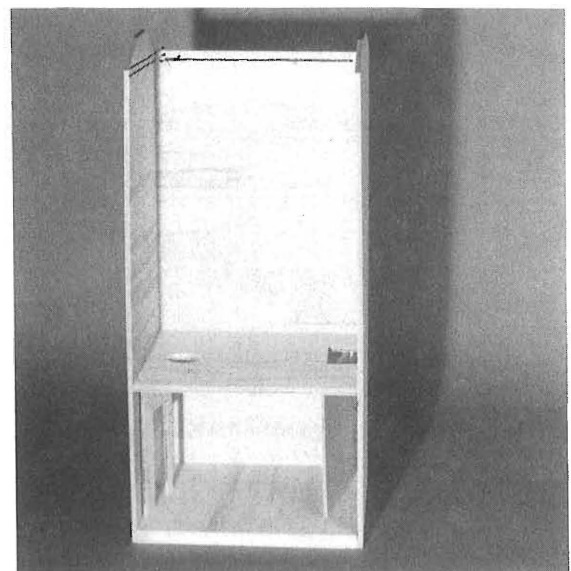

9. INSTALLATION OF FLOORS/ROOF (Continued)

At this point, lay the house on its back and glue and nail the 4th floor/roof between the lines drawn in step #5. Be sure the hole for the firemen's pole is aligned with the holes below. To install the 3rd floor, turn the house completely upside down and use the partitions resting on the 4th floor to establish the level of the 3rd floor. (This is to assure that the partitions will fit where they eventually will be installed). With the stairwell against the back wall and pole holes aligned, apply glue and nail through ends into back. (Avoid nailing into stairwell openings).

10. INSTALLATION OF L-STRIPS, FRONT SILL AND FLOOR FACING STRIPS

The L-strips are glued onto the front edge of the ends as shown.

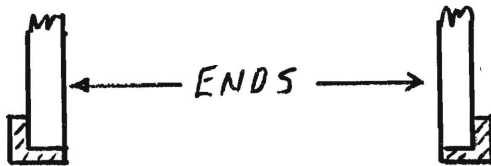

If one side of the "L" is thicker than the other, place the thicker side on the front edge of the end. The L-Strip should be up tight under the top molding. Use masking or scotch tape to keep pressure on the joints until the glue is set.

Cut floor facing strips to fit between the L-strips. Glue the facing strips to the front edge of the floors, securing the joints with tape. Glue and nail the front sill onto the front edge of the base. Use 1½" nails.



11. SUBASSEMBLY OF FIRETRUCK RAMP

To get this subassembly right, the main thing to observe carefully is that the square corners of the Ramp Beam and wedges are down on the level surface.

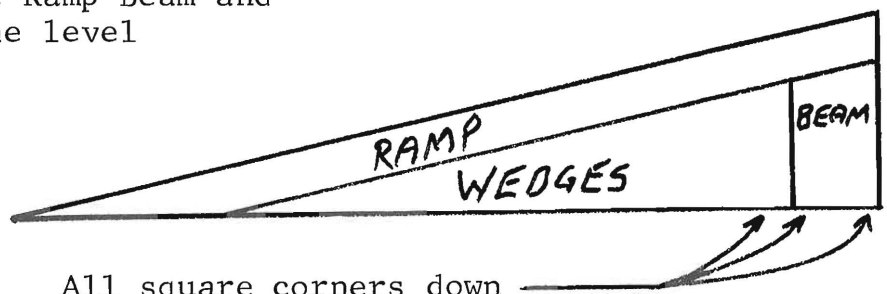

All square corners down

12. INSTALLATION OF FRONT

The front is hinged onto the right end. Open the hinges and fold them back like this:



Place them on the right L-strip as shown and mark the locations of the top holes (only) of each hinge on the front face of the L-strip. Drill a $3/32$ " diameter hole about $3/8$ " deep and drive a hinge screw ($1/2$ " x #5) into each of the two holes.

With the house on its back, lay the front in place as shown. If everything is good and square, the outside of the front should fit flush with the L-strips and with even spacing on top and bottom.

With the front in this position, make marks where the top and bottom of the hinges contact the front stancion. You will note that the rotating pin of the hinge protrudes beyond the outer edge of the front and end. Remove the front and place it face down on a flat surface.

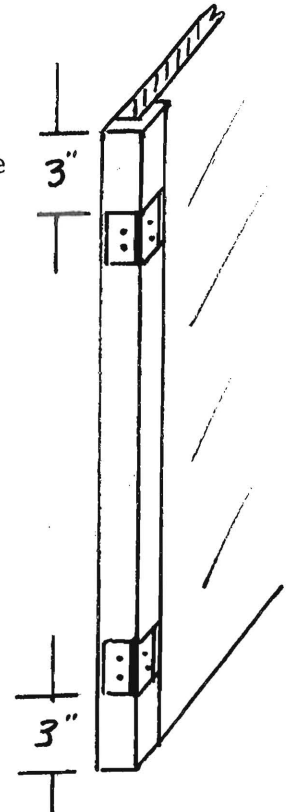

Remove the hinges from the L-strip and with hinges folded open as above, place them between the marks on the stancion. Mark the top holes (only), drill and install screws. Stand the house up and re-install the hinges on the L-strip by reinstalling the top screws. Test the fit of the door. It should swing closed with even spacing all around. If it does, drill holes and install the remaining screws. If it does not, remove the single screw that will allow adjustment in the proper direction. Make that adjustment and use the bottom hole to install a screw at the new location. The old hole can be plugged and redrilled. Repeat as necessary to obtain a proper functioning door.

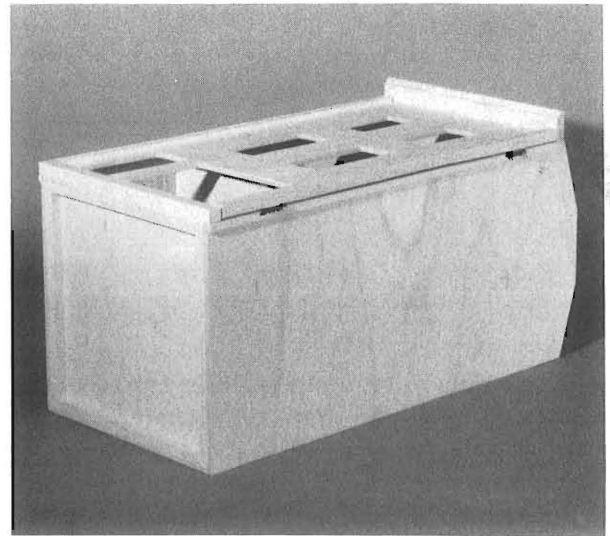

13. INSTALLATION OF STAIRS AND RAILS

The assembled stairs slip up through the stairwell from below. The top tread sets on the floor above. The stairs can be glued in place if desired.

The upstairs rails and Firepole rails are placed around the openings as shown. Glue is optional. Slip the firemen's pole into position through the hole in the roof. Glue into base is optional.

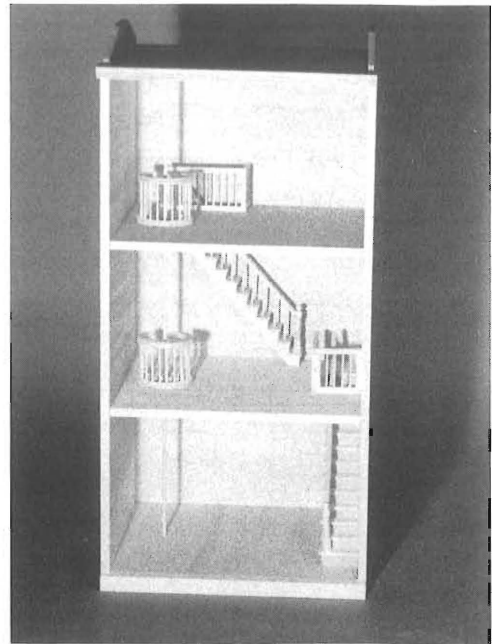

14. INSTALLATION OF PARTITIONS

The partitions are intended as a bathroom on the 3rd floor. Glue the side wall partition in place as shown.

You may want to install the partition with the door opening in a temporary fashion for access.

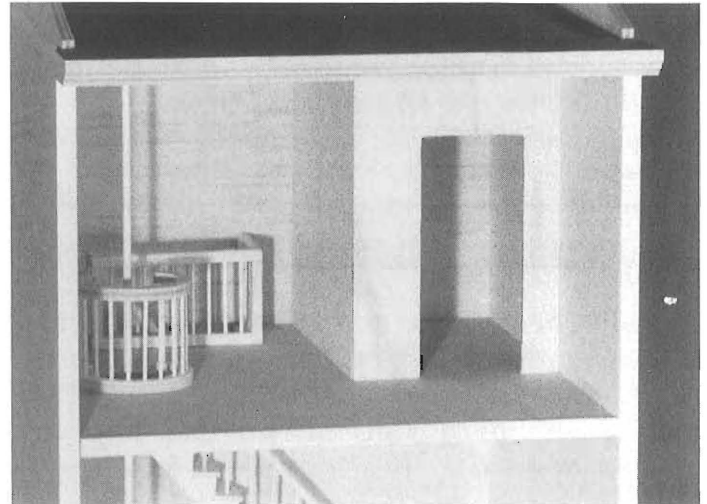

15. INSTALLATION OF FIREWALL CAP AND CHIMNEY CAP

Starting flush at the rear of the ends, glue the rear, center, and front firewall caps as shown. Glue the chimney cap centered on the center cap section of firewall cap.

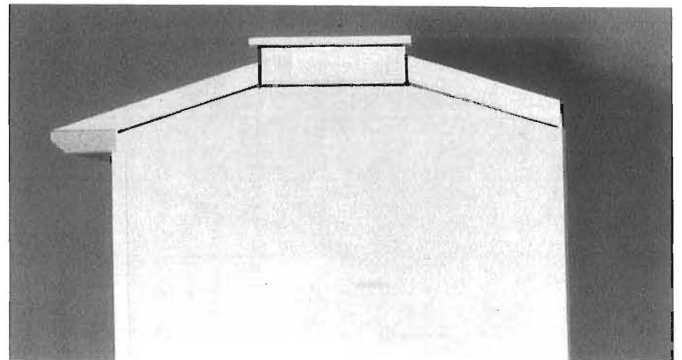

16. INSTALLATION OF FRONT STEPS AND FIRETRUCK RAMP

Glue the front steps and firetruck ramp onto the lower house sill, centered on their respective doors.

17. INSTALLATION OF INTERIOR WINDOWS AND FRONT TRIM

The assembled windows are to be installed in the openings from the inside.

For the window trim, first glue the undersill strips to the bottom of the window sills. There are 4 long window side frames and 4 short ones. Starting at the top, install the window lintels, side frames and sills as shown. The recessed edges of the side frames are to the inside of the window.

Glue the top facing board between the stancions and then the large brackets and dentil trim in place as shown.

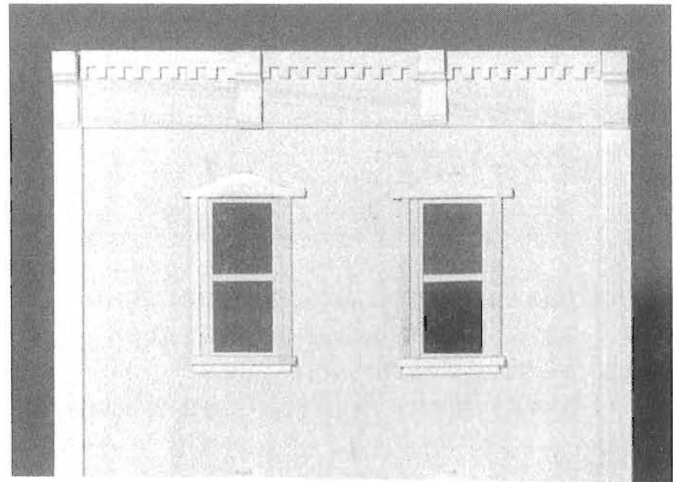
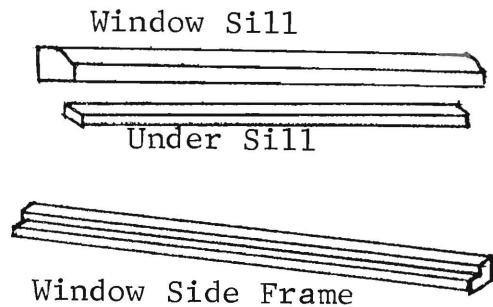

18. INSTALLATION OF DOORS

The doors are glued into the opening from the outside as shown. Be sure the doors do not protrude below the bottom edge of the front. Glue the horizontal door lintel and hood as shown.

Install firetruck door in the same manner with the sill just touching but not dragging on the house sill. Glue cross-buck trim onto firetruck door and glue the station sign above it. Install pre-cut trim on interior of doors. See front photo.

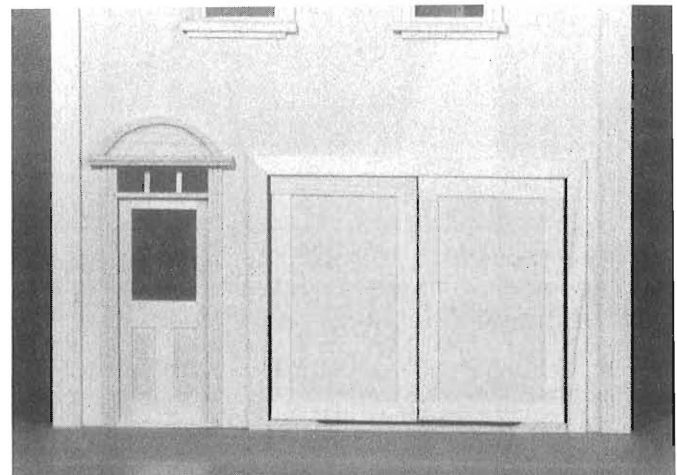

19. TWIST LATCH

A wooden twist latch and screw (5/8" x #6 round head) are provided for optional use in holding the front of the house in the closed position.

ASSEMBLY COMPLETE





INSTRUCTIONS OF THE ASSEMBLY OF INTERIOR STAIRS #529 FIREHOUSE

The Firehouse Interior Stair consists of:

- 1 stair block
- 11 drilled treads
- 1 undrilled bottom tread (small)
- 1 undrilled top tread (large)
- 11 spindles - 2 3/4"
- 1 handrail
- 1 long newel post
- 1 short newel post

Note: Ordinary white glue (like Elmer's) is a satisfactory adhesive for assembling the stairs. Be careful to avoid smearing excess glue if the stairs are to be stained since stain will not penetrate a glue sealed surface.

1. INSTALLATION OF THE STAIR TREADS

The large undrilled tread should be glued to the top (indicated by a "T") and the small undrilled tread to the bottom steps. The drilled treads are to be glued to all the intermediate steps. Proper orientation of treads is with the spindle holes on left side of stair block. Make certain the end of the tread opposite the spindle hole is flush with the right edge of the stair block. When properly installed, the spindle hole end of the treads will uniformly overhand the stair block by approximately 1/8". (Care should be taken to avoid getting glue in the holes. Allow glue to set).

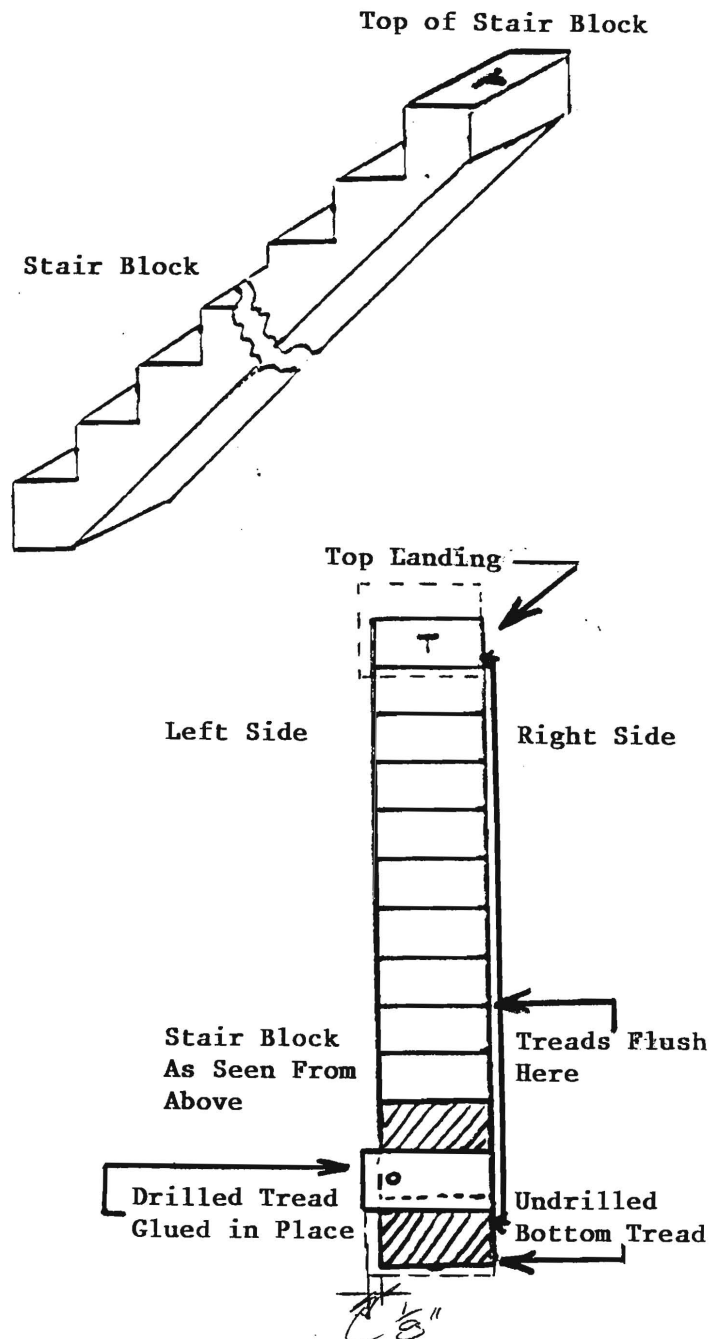

2. INSTALLATION OF BALUSTERS INTO HOLES IN TREADS

Set up some arrangement so the stairs are supported at a 45° angle - so that the balusters will remain vertical when set in the holes. Just touch the bottom (square end) of each baluster into a puddle of glue before inserting it into the tread holes.

3. INSTALLATION OF HANDRAIL

The timing of this step is important. Wait until the balusters are reasonably set - but not rigidly dried because they must flex a bit as the handrail is installed. Determine which end of the handrail goes to the top of the stairs by observing the angle of the holes in the underside of the rail. Place a dot of glue into each hole in the handrail. Then, starting from the bottom, (or top if that feels better to you), progressively lower the handrail onto the tops of the balusters one by one. The technique is to get all of them just started in the holes. Finally, adjust the position of the whole rail and baluster assembly so the balusters are plumb (vertical) in both planes (up and down, right and left).

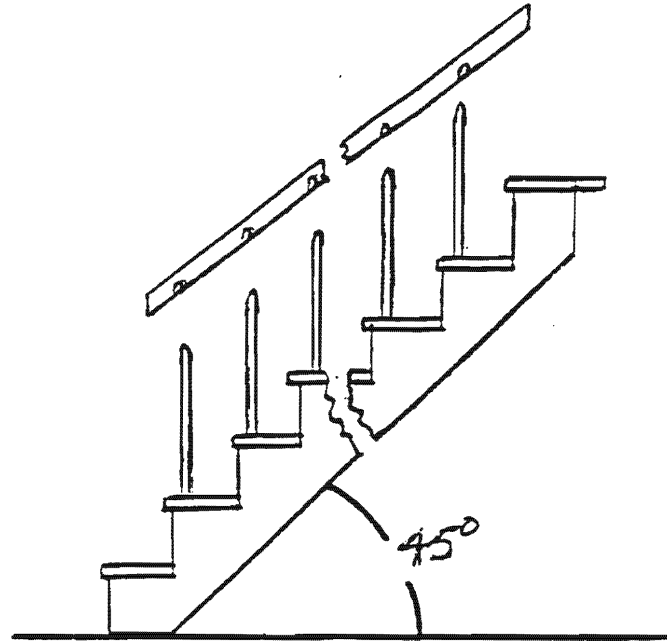

4. INSTALLATION OF NEWEL POSTS

Apply glue to the mating surfaces of the bottom tread and handrail with the longer newel post and place it in position where it is vertical and makes firm contact with both the tread and handrail. Install the shorter newel post at the top of the stairs in a similar manner. The ends of the rails may have to be sanded a bit to make a good fitting contact with the newel post.

Set assembled staircase in your 45° angle arrangement and allow glue to set. Recheck alignment often.

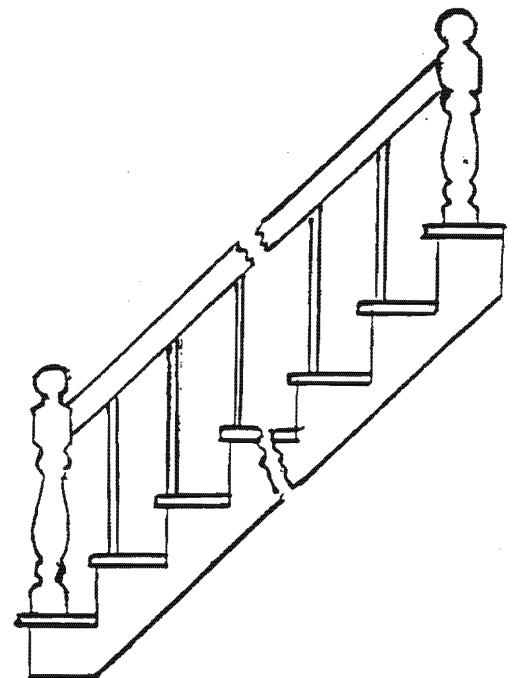

#529 OLD FIREHOUSE

LIST OF SUBPACKS

LONG BOYS SUBPACK (BANDED)

1	PC	DENTIL MOULDING (5262)	
1	PC	LEFT STANCION	30 7/8"
1	PC	RIGHT STANCION	30 7/8"
2	PCS	CORNER MOLDING (L-STRIPS)	31 7/8"
2	PCS	UNDERFRAME	3/4" X 3/4" X 15 3/8"
2	PCS	UNDERFRAME	3/4" X 3/4" X 13 7/8"
1	PC	FIREPOLE	1/4" X 31 7/16" DOWEL

SHORT BOYS SUBPACK (BANDED)

1	PC	FIRE STATION SIGN	
1	PC	TOP MOLDING	16 3/4"
1	PC	FRONT SILL	1" X 15/16" X 16 1/2"
2	PCS	FLOOR FACING STRIPS	1/8" X 1/2" X 15 3/8"
1	EA.	CORBEL FASCIA	1/4" X 1 1/2" X 14 15/16"

FIRETRUCK DOOR SUBPACK (BANDED IN CARDBOARD)

1	PC	FIRETRUCK DOOR	
1	PC	INTERIOR TOP TRIM	
2	PCS	INTERIOR SIDE TRIM	

FIRETRUCK RAMP SUBPACK (BANDED)

1	PC	RAMP PANEL	1/4" PLY, 5 1/4" X 10"
1	PC	UNDERFRAME	3/4" X 10" BEVELED
2	PCS	UNDERFRAME WEDGES	3/4" X 3 1/4"

1 EA. FRONT DOOR U1007

2 EA. STANDARD WINDOWS U2066N

2 EA. LONG SLIM WINDOWS U2068N

2 EA. FIREPOLE ENCLOSURE RAILS

• 20 EA U3013A BALUSTERS

• 4 EA CURVED RAILS

2 EA. LANDING RAILS SUBPACK (BAGGED)

• 6 EA U3006 POSTS 3 1/2"

• 2 EA U3033 RAILS 1 3/4"

• 2 EA U3033 RAILS 4 3/4"

1 EA. FRONT STEP

STAIRS TUBE SUBPACK

1	EA.	<u>FIREWALL CAP SUBPACK (BANDED)</u>	
	2	PCS FRONT	3/4" X 3/4" X 7 9/16"
	2	PCS CENTER	3/4" X 1 1/4" X 4 15/16"
	2	PCS REAR	3/4" X 3/4" X 5 3/4"
	2	PCS FIREWALL CAP	1/4" X 1 1/8" X 5 11/16"
1	EA.	<u>INTERIOR STAIR POSTS, TREADS AND BALUSTER SUBPACK</u>	
	• 22	PCS DRILLED TREADS	1/8" X 13/16" X 2 11/32"
	• 2	PCS TOP LANDING RAIL	1/8" X 1 3/16" X 2 11/32"
	• 22	PCS BALUSTERS	1/8" X 2 3/4"
	• 2	PCS NEWEL POSTS SHORT	2 15/16"
	• 2	PCS NEWEL POSTS LONG	3 5/32"
	• 2	PCS BOTTOM UNDRILLED TREADS	1/8" X 13/16" X 2 11/32"
2	EA.	INTERIOR STAIR BLOCKS WITH HANDRAILS (BANDED)	
1	EA.	<u>EXTERIOR TRIM SUBPACK (BAGGED)</u>	
	• 4	EA. CORBELS (5451)	
	• 2	EA. PRIMROSE ROSETTE (5456)	
	• 1	EA. MAGESTIC EAGLE (5460)	
1	EA.	<u>HARDWARE PACK (IN COIN ENVELOPE)</u>	
	• 2	EA. HINGES (U6003)	
	• 8	EA. HINGE SCREWS (1/2" X #4) (U6004)	
	• 26	EA. 3/4" BRADS	
	• 16	EA. 1 1/4" BRADS	
	• 6	EA. 1" BRADS	
	• 1	EA. MAGNETIC CATCH (U6005)	
	• 2	EA. CATCH SCREWS 3/8" (U6004B)	
1	EA.	<u>INTERIOR TRIM SUBPACK (BAGGED)</u>	
	• 4	EA SIDE TRIM STANDARD WX	1/8" X 3/8" X 5 3/4"
	• 4	EA TOP & BOTTOM TRIM STD WX	1/8" X 3/8" X 3 1/4"
	• 4	EA SIDE TRIM LONG SLIM WX	1/8" X 3/8" X 7 5/8"
	• 4	EA TOP & BOT. TRIM LONG SLIM WX	1/8" X 3/8" X 3 1/2"
	• 2	EA SIDE TRIM DOOR LEFT & RIGHT	1/8" X 3/8" X 7 7/8"
	• 1	EA TOP TRIM DOOR	1/8" X 3/8" X 3 3/4"